



Made to Fit



**VENETIAN<sup>®</sup>**  
BY THOR MOTOR COACH

*The Venetian is one of our most sophisticated Class A diesels, a rolling masterpiece with well-appointed decors & high-end amenities.*

# Floor Plans

## FLOOR PLAN G36

Chassis	Freightliner XC-R
Gross Vehicle (GVWR)	38,320
Gross Combined (GCWR)	48,320
Wheel Base	236"
Exterior Length	37'-11"
Exterior Height (w/AC)	12'-7"
Exterior Width (w/o mirrors)	101"
Interior Height (living area)	85"
Awning Size	13'-1"
Fuel (gal)	150
LPG (lbs)	104
Fresh/Waste/Gray Water (gal)	91 / 51 / 51
Water Heater (gal)	10
Furnace (BTUs)	35,000
Exterior Storage Capacity (cu. ft.)	185

## FLOOR PLAN M37

Chassis	Freightliner XC-R
Gross Vehicle (GVWR)	38,320
Gross Combined (GCWR)	48,320
Wheel Base	242"
Exterior Length	38'-5"
Exterior Height (w/AC)	12'-7"
Exterior Width (w/o mirrors)	101"
Interior Height (living area)	85"
Awning Size	16'-5"
Fuel (gal)	150
LPG (lbs)	104
Fresh/Waste/Gray Water (gal)	91 / 51 / 51
Water Heater (gal)	10
Furnace (BTUs)	(2) 20,000
Exterior Storage Capacity (cu. ft.)	195

## FLOOR PLAN A40

Chassis	Freightliner XC-R
Gross Vehicle (GVWR)	38,320
Gross Combined (GCWR)	48,320
Wheel Base	272"
Exterior Length	40'-11"
Exterior Height (w/AC)	12'-7"
Exterior Width (w/o mirrors)	101"
Interior Height (living area)	85"
Awning Size	16'-5"
Fuel (gal)	150
LPG (lbs)	104
Fresh/Waste/Gray Water (gal)	91 / 51 / 51
Water Heater (gal)	10
Furnace (BTUs)	(2) 20,000
Exterior Storage Capacity (cu. ft.)	225

## G36

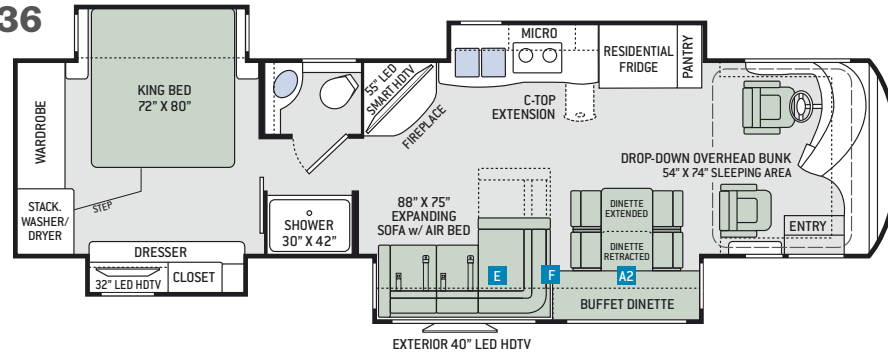

## M37

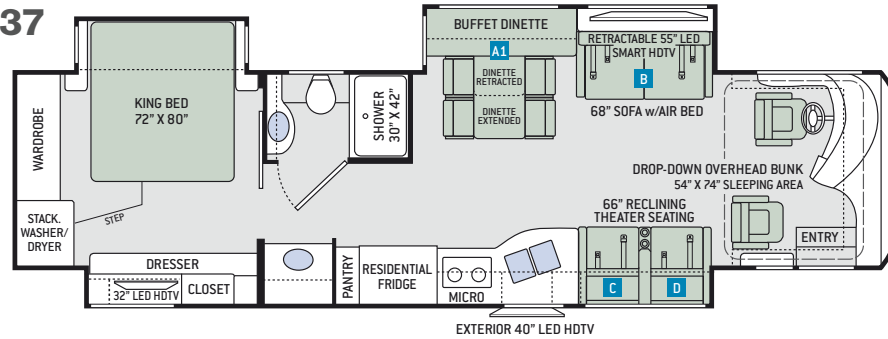

## A40

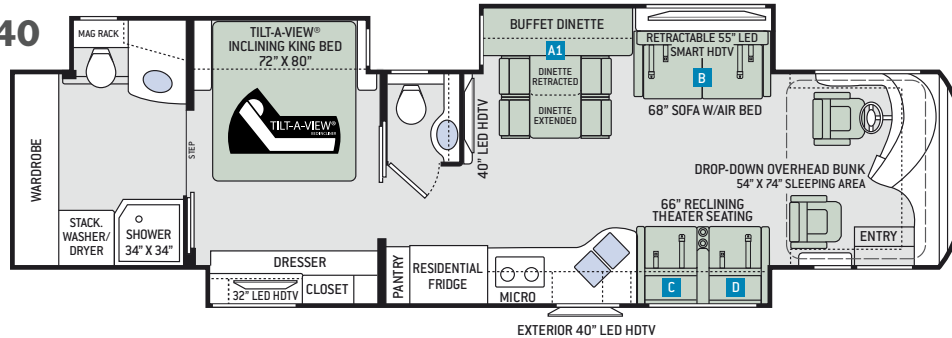

## OPTIONS

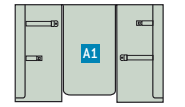

OPTIONAL 74" DREAM DINETTE

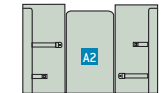

OPTIONAL 74" DREAM DINETTE

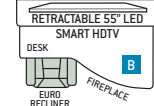

OPTIONAL EURO RECLINER w/DESKTOP & FIREPLACE

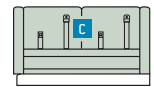

PASSENGER SIDE 66" SOFA w/ AIR BED (EURO RECLINER w/DESKTOP & FIREPLACE REQUIRED)

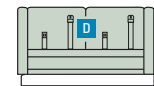

OPTIONAL PASSENGER SIDE 66" JACK-KNIFE SOFA

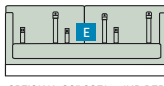

OPTIONAL 88" SOFA w/ AIR BED

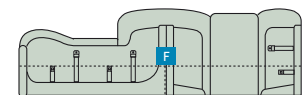

OPTIONAL 162" SOFA ENSEMBLE INCLUDES 88" SOFA w/ AIR BED & 74" DREAM DINETTE



A home needs a strong foundation and that's especially true for the home that rolls down the road. We partnered with industry leaders, Freightliner® Custom Chassis and MORryde® International, to bring you this innovative building design. The Atlas Foundation™ is the premier building platform and substructure in the industry.

# Interior Decor



CALYPSO



PIRATE'S COVE



STRATA



SOLID SURFACE COUNTERTOPS



POLISHED PORCELAIN TILE FLOORING



HIGH-GLOSS GLAZED MILAN



HIGH-GLOSS GLAZED NEWPORT



HIGH-GLOSS GLAZED PACIFIC

# Exterior Graphics



BELLINI FULL-BODY PAINT

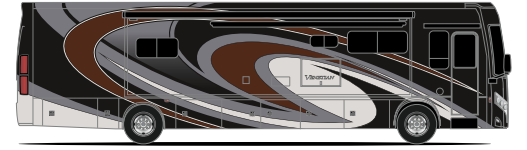

POMPEII FULL-BODY PAINT



SEACLIFF FULL-BODY PAINT

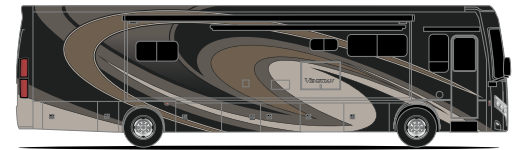

VOGUE FULL-BODY PAINT

# Features

## CONSTRUCTION & EXTERIOR

- Freightliner® XC-R Raised Rail Chassis with Atlas™ Foundation
- Cummins® ISL 8.9L Engine with 400HP & 1,250 lb.-ft. Torque
- 6-Speed Allison MH-3000 Automatic Transmission
- Air-Ride™ Suspension
- I-Beam Front Axle with 55° Wheel Cut
- Exhaust Brake
- Sachs® Shock Absorbers
- 150-gallon Fuel Tank with Dual Fills
- One-Piece Fiberglass Front & Rear Caps
- Molded Fiberglass Roof
- Invisible Front Paint Protection
- Full-Body Paint Package
- Automatic Leveling Jacks with Touchpad Controls
- Side-Hinged Locking Compartment Doors
- Basement Pass-Through Storage
- Easy Slide Storage Tray
- Power Entry Door & Patio Awnings with Integrated LED Lighting
- Slideout Room Topper Awnings
- Patio Light (Both Sides)
- Roof Ladder
- Frameless Dual Pane Windows
- 10,000-lb. Trailer Hitch with 7-pin Round Connector

## AUTOMOTIVE & COCKPIT

- 10" Touchscreen Dash Radio with Bluetooth®, GPS Navigation & Back-Up Monitor
- Chrome Heated/Power Mirrors with Integrated Side View Cameras
- Push Button Start
- Leatherette Reclining/Swivel Power Adjustable Captain's Chairs (Passenger Seat has Electric Footrest)

- Driver & Passenger Overhead Storage Cabinetry
- Keyless Entry System
- VIP Tilt/Telescoping Smart Wheel
- Cruise Control
- Emergency Engine Start Switch
- Air Horns
- Fog Lights
- Power Solar & Privacy Shades on Windshield
- Manual Solar & Privacy Shades on Side Windows
- Solid Surface Entry Steps
- Electric Step Cover
- 275/80R 22.5" Radial Tires with Aluminum Wheels
- Power Drop-Down Hide-Away Overhead Bunk with Cotton Cloud™ Mattress

## INTERIOR

- Polished Porcelain Tile
- Ceiling Ducted Whisper Air™ Central Cooling System
- LED Lighting
- High-Gloss Glazed Cabinetry with Solid Wood Raised Panel Cabinet Doors & Nickel Finish Hardware
- Solid Wood Veneer
- Window Solar & Privacy Shades
- Leatherette Furniture
- Expanding Sofa with Air Bed (G36)
- Driver Side Sofa with Air Bed (M37 & A40)
- Reclining Theater Seating with Footrests (M37 & A40)
- Buffet Dinette with Four (4) Chairs – Includes Two (2) Folding
- Electric Fireplace with Remote Control (G36)

## INTERIOR OPTIONS

- Passenger Side Sofa with Air Bed (G36)
- Ensemble with Sofa & Dream Dinette® (G36)

- Passenger Side Jack-Knife Sofa (M37 & A40)
- Passenger Side Sofa with Air Bed – Euro Recliner, Desktop & Electric Fireplace with Remote Control Option Required (M37 & A40)
- Euro Recliner, Desktop & Electric Fireplace with Remote Control (M37 & A40)
- Dream Dinette® Booth

## KITCHEN

- 21 cu. ft. Stainless Steel Residential Refrigerator with In-Door Ice & Water Dispenser
- Electric Induction Cooktop
- 1.9 cu. ft. Stainless Steel Over-the-Range Convection Microwave Oven
- Solid Surface Countertops & Sink Covers
- Large Double Bowl Stainless Steel Sink with Single Handle Faucet & Pull-Down Sprayer
- Designer Tile Backsplash
- 12-volt Attic Fan with Cover

## BEDROOM & BATHROOM

- Denver Mattress® Pillowtop King Size Bed (G36 & M37)
- Denver Mattress® King Size Bed w/Tilt-A-View™ Inclining Mechanism (A40)
- Bedspread with Throw Pillows
- Ceiling Fan in Bedroom
- USB Charging Ports in Nightstands
- Porcelain Toilet
- Solid Surface Countertops
- Granite Texture Fiberglass Shower with Glass Door
- Designer Tile Backsplash in Bathroom
- 12-volt Attic Fan with Cover in Bathroom

## ENTERTAINMENT

- 55" LED Smart HDTV in Living Area (G36 & M37)
- 40" LED HDTV & 55" LED Smart HDTV in Living Area (A40)

- 32" LED HDTV in Cockpit Overhead (G36 & M37)
- JBL® Sound Bar with Bluetooth®
- Sony® Blu-Ray Player in Living Area & Bedroom
- 32" LED HDTV in Bedroom
- Exterior 40" LED HDTV & Sound Bar w/Bluetooth®
- Cable TV & HDMI Video Ready
- Winegard™ TRAV'LER HD Satellite Dish Prep

## ELECTRICAL & PLUMBING

- Cummins Onan® RV QD 8000 Diesel Generator
- Automatic Generator Start
- 50-amp Shoreline Power Cord
- 2000-watt Pure Sine Inverter/100-amp Converter
- Dual 15,000 BTU Low-Profile Ducted Air Conditioners with Two (2) Heat Pumps (G36, M37 & A40)
- Energy Management System
- Multiplex Wiring Control System
- 100-watt Solar Charging System with Power Controller
- Four (4) Auxiliary House Batteries
- Battery Disconnect Switch
- Exterior GFCI Recept
- 10-gallon DSI Gas/Electric Water Heater
- Enclosed & Heated Holding Tanks
- E-Z Flow Water Panel with Whole-House Water Filtration
- Black Tank Flush System
- Outside Shower
- Stackable Washer & Dryer
- Central Vacuum System w/Toe-Kick Dustpan

**IMPORTANT—PLEASE READ:** This brochure reflects product design, fabrication, material, components and specifications at the date of printing, which date is disclosed below. Please visit us online at [ThorMotorCoach.com](http://ThorMotorCoach.com) or consult with your selling dealership for the latest in standards, options, specification and technical information. Photographs in the brochure may depict optional equipment or may only be available in certain floor plans. Components, appliances and the chassis may have been manufactured in a calendar year before the vehicle's designated model year. All capacities are approximate. The actual length of the vehicle may differ from that indicated in the brochure due to variances in the manufacturing processes and/or installed components. All dry weights are based on standard model features and do not include optional features or equipment. Component part and appliance manufacturers issue limited warranties covering portions of the vehicle not covered under the limited warranty we issue. Copyright Thor Motor Coach, Inc. © MY 04/15/17

YOUR LOCAL THOR MOTOR COACH DEALER

**LA MESA RV**  
EXPERIENCE LIFE

[www.lamesarv.com](http://www.lamesarv.com)  
800-496-8778



Made to fit.

[thormotorcoach.com/venetian](http://thormotorcoach.com/venetian)



P.O. Box 1486, Elkhart, IN 46515 Sales Department: 800.860.5658 Customer Service: 877.855.2867