

# Allegro Bus<sup>®</sup>





45 OPP WITH GLAZED CHERRY CABINETS AND BUKHARA INTERIOR



LIVING AREA

# A LUXURY HOME WITH A REALLY, REALLY BIG YARD

Always a Tiffin topseller, the luxurious Allegro Bus is our most popular model for folks who enjoy the RV lifestyle full time. On the road, this elegant coach is the perfect traveling companion, offering a quiet ride, smart driver-assist features, and a generous towing capacity. Off the beaten path, it becomes a haven of upscale residential living, complete with spacious interiors, high-end amenities, and exquisite design details. Many of these luxuries are Tiffin-built exclusives, including our handcrafted hardwood cabinetry, double-paned insulated windows, and customized PowerGlide chassis.



## MAIN COMPARTMENT

Luxury is the décor of choice in the spacious living area, as seen in the upscale comforts of high-end furniture, LED lighting fixtures, designer fabrics and finishes, and the option of heated floors in the living areas. Entertainment needs are well-addressed, with a surround sound system and four onboard TVs, pre-wired for DISH Network®.



DINETTE



LIVING AREA



ENTERTAINMENT AREA

All interiors shown are 45 OPP with Glazed Cherry Cabinets and Bukhara Interior. To learn more about all of our décor and floor plan options, visit [tiffinmotorhomes.com](http://tiffinmotorhomes.com)



The cool brightness of LED lighting illuminates interiors, using a fraction of the energy of incandescent bulbs to preserve the coach's battery life.



NEW STAINLESS STEEL FARMHOUSE SINK



DIGITAL INSTRUMENT CLUSTER — NOW STANDARD  
OPTIONAL ADVANCED MONITOR — SHOWN

## MASTER SUITE

The luxurious master suite is a haven of comfort and convenience. Tiffin's exclusive double-paned insulated window design ensures peace and quiet, while a bedside control switch for the entry lock offers peace of mind. The on suite residential-style bath is impressively spacious. Many owners opt for our bath-and-a-half floor plan, which offers a midsection lavatory for guests and a private bath for you.



MASTER BEDROOM

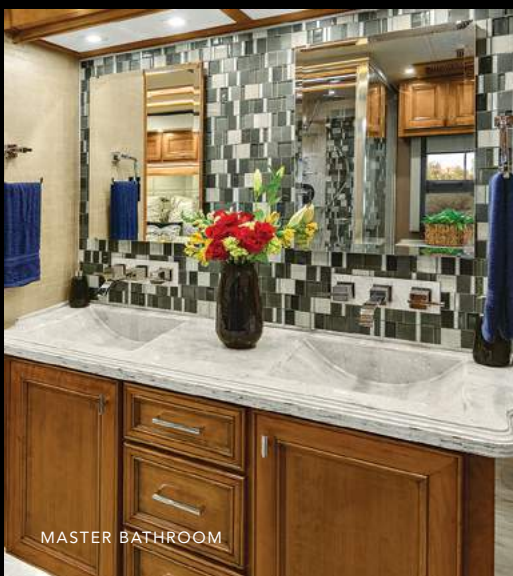

MASTER BATHROOM



MASTER BEDROOM STORAGE



Woodwork is created from solid hardwood by Red Bay master craftsmen. The multitude of cabinets, drawers, and closets adds up to more storage than many larger-sized models.



## TIFFIN POWERGLIDE® CHASSIS

There's an art to engineering a motorhome, as elegantly demonstrated in the custom-built PowerGlide chassis. Reflecting decades of Tiffin innovation, the PowerGlide delivers everything an owner could wish for — durability, reliability, performance, and control.



### MULTIPLEX WIRING

Our multiplexed electrical system with auto reset fuses and relays uses less wiring and increases reliability, efficiency, and flexibility.

### DYNAMOMETER TESTING

Every PowerGlide Chassis undergoes dynamometer testing, which simulates full power road testing. During the process, we assess engine performance, cooling system function, and instrumentation.

### CHASSIS WARRANTY

The PowerGlide Chassis carries a limited warranty backed by Tiffin: Three years or 50,000 miles against defects in materials and workmanship on the PowerGlide Chassis.

### EXTRA STORAGE

As a diesel pusher, the engine is at the rear of the coach. This chassis design opens up room for more under-coach storage and a more spacious driver's cab.

For a complete and up-to-date list of available options and specifications, visit [tiffinmotorhomes.com](http://tiffinmotorhomes.com)

# FLOOR PLANS



The design of every Tiffin floor plan must meet four essential criteria: Maximum space. Optimal organization. Relaxation plus. Elegant atmosphere. MORE plans offer your family the most comfortable layout for life on the road.

## 37 AP

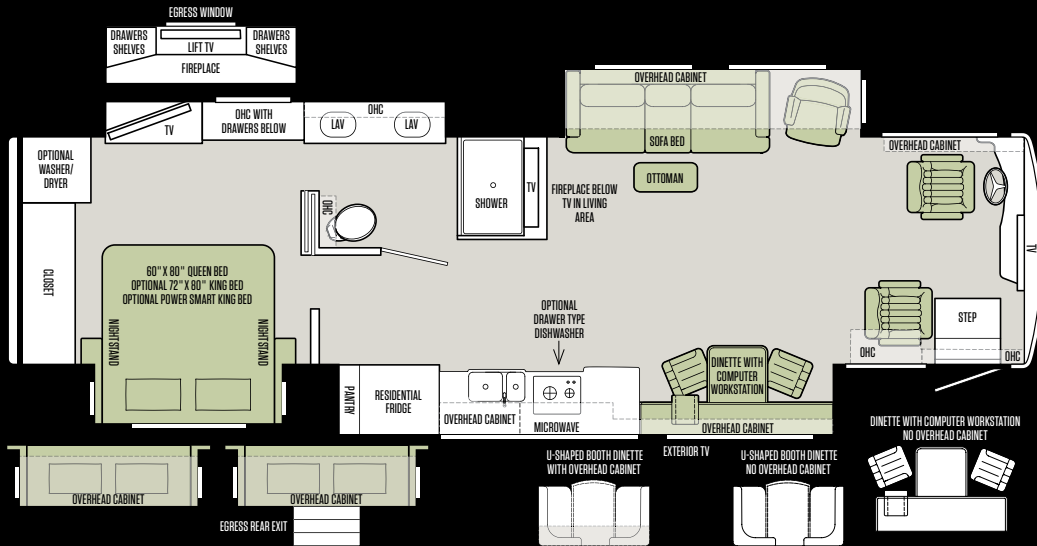

## 40 AP

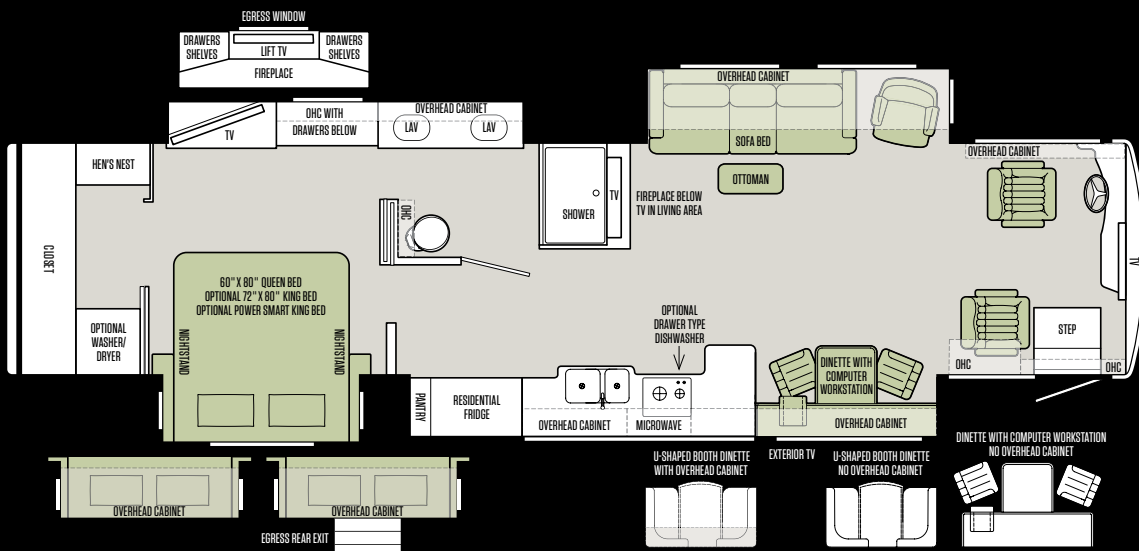

If optional furniture combinations are selected, window locations may vary from diagram shown. All options may not be available in every model. Because of progressive improvements, specifications, standard and optional equipment are subject to change without notice or obligation. For a complete and up-to-date list of available options and specifications, visit [tiffinmotorhomes.com](http://tiffinmotorhomes.com)



# 40 IP

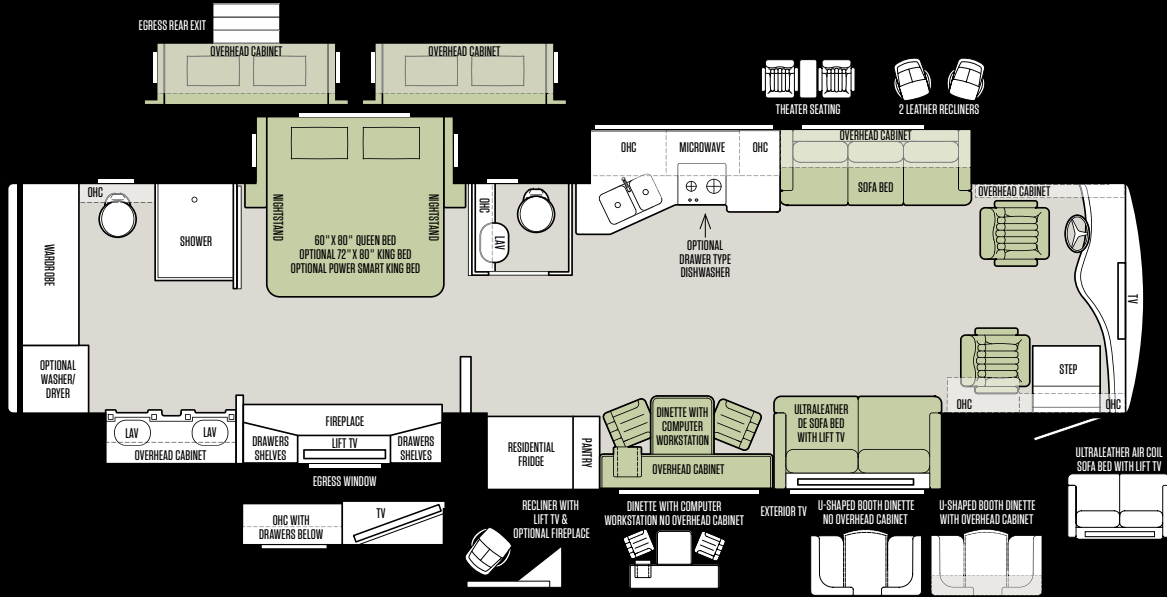

# 45 MP

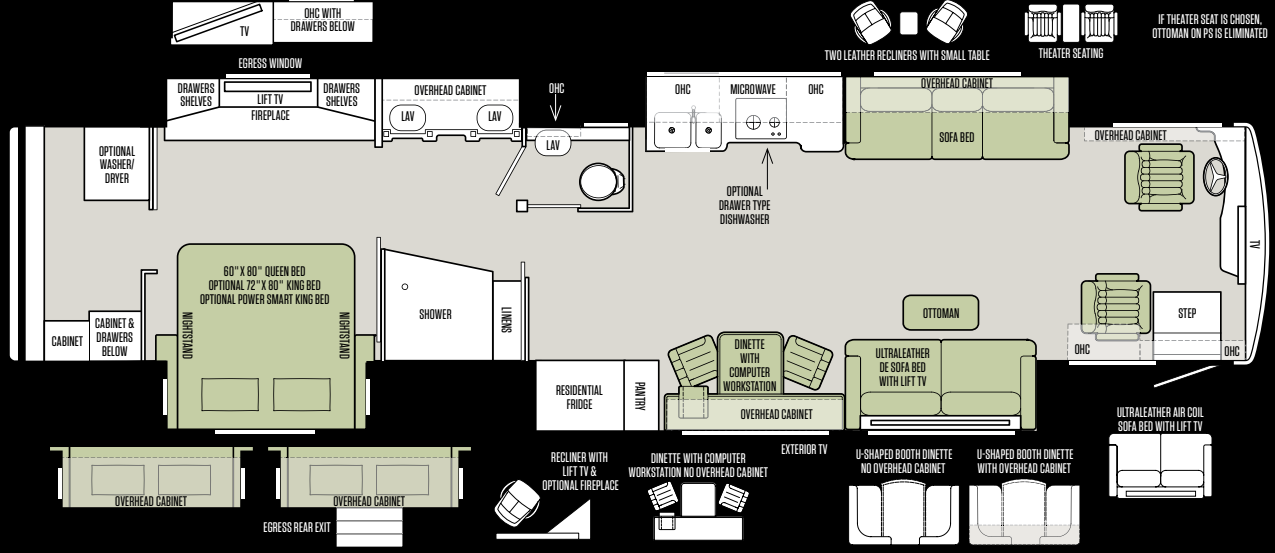

# 45 OPP



# INTERIOR DÉCOR

Make your experience on the road all your own. Express yourself by choosing the interior appointments such as cabinet finishes, flooring and fabric textures for every part of your motorhome. In the 2019 Allegro Bus you'll be able to go in style no matter where you go.

Because of progressive improvements, specifications, standard and optional equipment are subject to change without notice or obligation. For a complete and up-to-date list of available options and specifications, visit [tiffinmotorhomes.com](http://tiffinmotorhomes.com)

## CABINETS



CHERRY WOOD



GLAZED HONEY NATURAL CHERRY



GLAZED CANYON CHERRY



NATURAL CHERRY



GLAZED CHERRY



WHITE LINEN

## BUKHARA

### LIVING AREA



PILLOWS

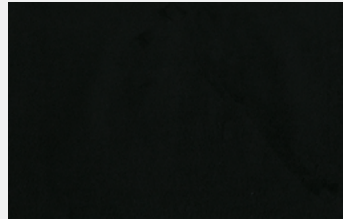

VALANCE

### KITCHEN



BACKSPLASH



COUNTERTOP

### BEDROOM



## POSH

### LIVING AREA



PILLOWS



VALANCE

### KITCHEN



BACKSPLASH



COUNTERTOP

### BEDROOM



**FLOORING**



NORTH STAR FLOOR TILE — STANDARD



SEASON WOOD PLANK FLOOR TILE — OPTIONAL

**ULTRALEATHER OPTIONS**

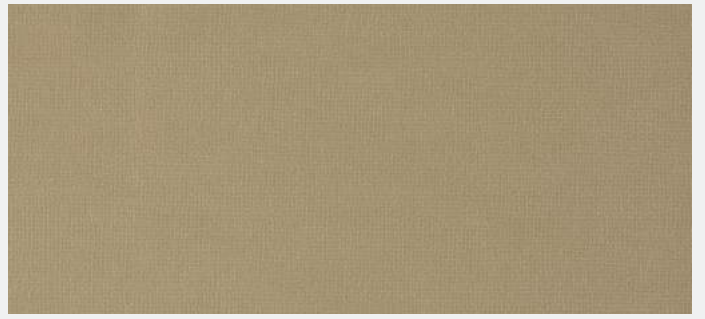

COFFEEHOUSE ULTRALEATHER



SILKWORM ULTRALEATHER

**SAND CASTLE (RALPH LAUREN)**

**LIVING AREA**



PILLOWS



VALANCE

**KITCHEN**



BACKSPLASH



COUNTERTOP

**BEDROOM**



**SEPIA**

**LIVING AREA**



PILLOWS

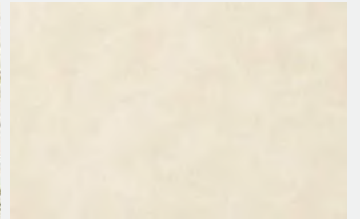

VALANCE

**KITCHEN**



BACKSPLASH



COUNTERTOP

**BEDROOM**



## PREMIUM PAINT SYSTEM

Our eight-step full-body paint system features premium grade paints sealed with four layers of superclear coat with ultraviolet protection. An additional layer of scratch-resistant plastic coating protects the front of the coach, stairwell, and entry door lock.



CINDERWOOD 2019



SMOKEY TEAL 2019



CRIMSON 2019



SUNLIT SAND 2019



DESERT SUNSET 2019



WATERFALL 2019



MAROON CORAL 2019



WHITE MAHOGANY 2019

To learn more about our premium paint system or for a complete and up-to-date list of available options and specifications, as well as information on Tiffin's full line of motorhomes, visit [tiffinmotorhomes.com](http://tiffinmotorhomes.com).



2019 REIMAGINED REAR CAP

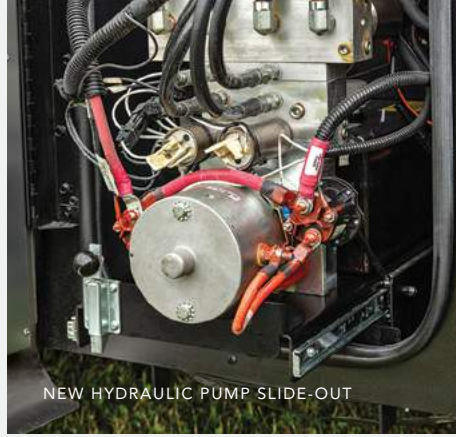

NEW HYDRAULIC PUMP SLIDE-OUT



TALLER PASS-THROUGH STORAGE

## 2019 SPECIFICATIONS

### AUTOMOTIVE

#### STANDARD ON ALL MODELS:

- Allison 6-speed Automatic Transmission with Lock-up (Torque Converter)
- Side Mounted Cooling Package
- ABS Brakes and Two-stage Compression Engine Brake
- Four Aluminum Wheels (Six on 45 OPP)
- Air Bags: 4 on 37' and 40'; 6 on 45'
- Cruise Control
- VIP Smart Wheel
- Fog Lights
- Emergency Start Switch
- Adjustable Fuel and Brake Pedals
- Independent Front Suspension

### CHASSIS OPTIONS

| POWERGLIDE® CHASSIS WITH CUMMINS ISL9 450 HP/1250 LB TORQUE:                   | 37 AP         | 40 AP         | 40 IP         | 45 OPP        | 45 MP         |
|--|---------------|---------------|---------------|---------------|---------------|
| PowerGlide® Chassis with Cummins ISL9 450 HP/1250 lb Torque                    | S             | S             | S             | S             | S             |
| Allison 3000 MH 6-speed Automatic Transmission with Lock-up (Torque Converter) | S             | S             | S             | S             | S             |
| GVWR   | 41,000 lb     | 41,000 lb     | 41,000 lb     | 51,000 lb     | 51,000 lb     |
| GAWR — Front   | 17,000 lb     | 17,000 lb     | 17,000 lb     | 17,000 lb     | 17,000 lb     |
| GAWR — Rear  | 24,000 lb     | 24,000 lb     | 24,000 lb     | 23,000 lb     | 23,000 lb     |
| GAWR — Tag Axle  | NA            | NA            | NA            | 13,300 lb     | 13,300 lb     |
| GCWR   | 56,000 lb     | 56,000 lb     | 56,000 lb     | 66,000 lb     | 66,000 lb     |
| Alternator Amps  | 210           | 210           | 210           | 210           | 210           |
| DEF Tank* (Gallons)  | 10            | 10            | 10            | 10            | 10            |
| Basement Storage (Cubic Feet — Approximate)                                    | 180           | 229           | 229           | 237           | 237           |
| Wheel Base   | 250"          | 276"          | 276"          | 323"          | 323"          |
| Tire Size  | 315/80 R 22.5 | 315/80 R 22.5 | 315/80 R 22.5 | 315/80 R 22.5 | 315/80 R 22.6 |
| Hitch Rating**   | 15,000 lb     | 15,000 lb     | 15,000 lb     | 15,000 lb     | 15,000 lb     |

| POWERGLIDE® CUMMINS X15 605 HP/1950 LB TORQUE:                                 | 45 OPP             | 45 MP              |
|--|--------------------|--------------------|
| PowerGlide® Cummins X15 605 HP/1950 lb Torque (Delayed Availability)           | O                  | O                  |
| Allison 4000 MH 6-speed Automatic Transmission with Lock-up (Torque Converter) | S                  | S                  |
| GVWR   | 51,000 / 50,000 lb | 51,000 / 50,000 lb |
| GAWR — Front   | 17,000 lb          | 17,000 lb          |
| GAWR — Rear  | 23,000 / 20,000 lb | 23,000 / 20,000 lb |
| GAWR — Tag Axle  | 11,000 / 13,000 lb | 11,000 / 13,000 lb |
| GCWR   | 71,000 / 70,000 lb | 71,000 / 70,000 lb |
| Alternator Amps  | 280 / 270          | 280 / 270          |
| DEF Tank* (Gallons)  | 15                 | 15                 |
| Basement Storage (Cubic Feet — Approximate)                                    | 257                | 257                |
| Wheel Base   | 316"               | 316"               |
| Tire Size  | 315/80R 22.5       | 315/80R 22.6       |
| Hitch Rating**   | 20,000 lb          | 20,000 lb          |
| Minimum Garage Height  | 14'                | 14'                |

\* Diesel Exhaust Fluid (DEF) is the active component used in Selective Catalytic Reduction (SCR) engines to reduce nitrogen oxide emissions by 90% to meet EPA standards.

\*\* Maximum Trailer Weight is dependent on the loading and towing variables which include the GVWR, GAWR, and GCWR, as well as adequate trailer brakes.

### WEIGHTS AND MEASURES

| OVERALL:                               | 37 AP   | 40 AP  | 40 IP  | 45 OPP | 45 MP  |
|--|---------|--------|--------|--------|--------|
| Overall Length (Approximate***)        | 38' 11" | 41'    | 41'    | 45'    | 45'    |
| Overall Height with Roof Air (Maximum) | 13' 3"  | 13' 3" | 13' 3" | 13' 3" | 13' 3" |
| Interior Height                        | 83"     | 83"    | 83"    | 83"    | 83"    |
| Overall Width***                       | 101"    | 101"   | 101"   | 101"   | 101"   |
| Interior Width                         | 96"     | 96"    | 96"    | 96"    | 96"    |
| Fresh Water (Gallons)                  | 100     | 100    | 100    | 100    | 100    |
| Black Water (Gallons)                  | 55      | 55     | 55     | 55     | 55     |
| Grey Water (Gallons)                   | 100     | 100    | 100    | 100    | 100    |
| Minimum Garage Height                  | 14'     | 14'    | 14'    | 14'    | 14'    |
| Fuel Tank (Gallons)—Dual Fuel Fill     | 150     | 150    | 150    | 150    | 150    |

\*\*\* The approximated coach width and length does not include side view mirrors.

For all information concerning the limited warranty provided by Tiffin, please refer to the full written limited warranty set forth on the Tiffin website or held by our authorized dealerships.

# 2019 SPECIFICATIONS

## EXTERIOR

### STANDARD ON ALL MODELS:

- Fiberglass Front and Rear Caps
- Dual Fuel Fills
- Full-body Paint with Protective Film on Front Cap
- Large Tinted One-piece Windshield
- Heated Chrome Power Mirrors with Remote Adjustments
- Single Motor Intermittent Wipers
- Undercoating
- Deadbolt Front Entrance Door
- Keyless Entry Door System and Keyless Component Door Locks
- Exterior Flat Panel TV
- Dual Pane Tinted Windows
- Automatic Door and Patio Awning
- Girard Awning
- Pass-through Basement Storage
- Lockable Swing-out Exterior Storage Doors with Gas Shocks
- Heated Water and Holding Tank Compartments
- Auto Generator Start
- SeeLevel Monitor Pad Located at Dump Station
- SeeLevel Tank Monitor
- Six House Batteries
- Custom Mud Flap
- 50 Amp Service
- Power Cord Reel — 50 Amp
- Black Holding Tank Flush System
- 110 V Exterior Receptacle
- Water Filter
- Gravity Water Fill
- Docking Lights
- Exterior Rinse Hose with Soap Dispenser and Paper Towel Holder
- Onan® 10.0 kw Generator with Three Low Profile Roof ACs with Heat Pumps
- Concealed Air Horn
- Digital TV Antenna
- Combination Valid Air Leveling System with HWH Hydraulic Leveling Jacks
- Luggage Compartment Lights
- Pure Sine Wave Inverter
- Prep for Winegard® TRAV'LER Satellite
- Low Profile In-motion Satellite Dish\*
- Exterior Ground Effects Lighting
- Outdoor Spyder Control System Screen
- Prep for Solar Panel
- Prep for Winegard ConnecT™

\* High-definition programming is not available on a domed satellite antenna unless you subscribe to DISH Network®.

| AVAILABLE OPTIONS:                            | 37 AP | 40 AP | 40 IP | 45 OPP | 45 MP |
|---|-------|-------|-------|--------|-------|
| One Storage Compartment Slide-out Tray        | O     | O     | O     | O      | O     |
| One Power Storage Compartment Slide-out Tray  | O     | O     | O     | O      | O     |
| Two Storage Compartment Slide-out Trays       | NA    | O     | O     | O      | O     |
| Two Power Storage Compartment Slide-out Trays | NA    | O     | O     | O      | O     |
| Second Girard Patio Awning                    | NA    | O     | O     | O      | O     |
| Basement Freezer/Refrigerator                 | O     | O     | O     | O      | O     |
| Roof Ladder                                   | O     | O     | O     | O      | O     |
| Winegard ConnecT™ (Subscription required)     | O     | O     | O     | O      | O     |
| One Solar Panel                               | O     | O     | O     | O      | O     |
| Two Solar Panels                              | O     | O     | O     | O      | O     |
| Exterior Lighting Under Slide Out             | O     | O     | O     | O      | O     |
| Extended Cycle Batteries                      | O     | O     | O     | O      | O     |

## INTERIOR

### STANDARD ON ALL MODELS:

- LED Lighting
- Soft Touch Vinyl Ceilings
- Washer/Dryer Ready
- SeeLevel Tank Monitor
- Carbon Monoxide and Smoke Detectors
- Central Vacuum Cleaner with VacPan
- Multiplex Lighting System
- Porcelain Tile Flooring Throughout Coach (Excluding Slide-outs)
- Complete Cable Wiring Interfacing with Surround Sound and Satellite Receiver
- Surround Sound Speakers in Ceiling
- Energy Management System
- Power Solar and Privacy Shades in Living Room
- In-motion Low Profile Satellite Dish with DISH Network® Receiver (Subscription Required)
- Extraordinaire™ AC System
- Hydronic Heating System
- 10" Spyder Control System Screen

| INTERIOR OPTIONS:   | 37 AP | 40 AP | 40 IP | 45 OPP | 45 MP |
|---|-------|-------|-------|--------|-------|
| <b>Cabinets</b>   |       |       |       |        |       |
| Cherry Wood Solid Cabinet Doors and Drawer Fronts                       | O     | O     | O     | O      | O     |
| Glazed Canyon Cherry Solid Cabinet Doors and Drawer Fronts              | O     | O     | O     | O      | O     |
| Glazed Cherry Solid Cabinet Doors and Drawer Fronts                     | O     | O     | O     | O      | O     |
| Glazed Honey Natural Cherry Solid Cabinet Doors and Drawer Fronts       | O     | O     | O     | O      | O     |
| Natural Cherry Solid Cabinet Doors and Drawer Fronts                    | O     | O     | O     | O      | O     |
| White Linen Solid Cabinet Doors and Drawer Fronts                       | O     | O     | O     | O      | O     |
| Luster Sheen Cabinet Finish (Only Available with Glazed Cabinet Option) | O     | O     | O     | O      | O     |
| <b>Fabric Suites</b>  |       |       |       |        |       |
| Bukhara   | O     | O     | O     | O      | O     |
| Posh  | O     | O     | O     | O      | O     |
| Sand Castle   | O     | O     | O     | O      | O     |
| Sepia   | O     | O     | O     | O      | O     |
| <b>Ultraleathers</b>  |       |       |       |        |       |
| Coffeehouse Ultraleather  | O     | O     | O     | O      | O     |
| Silkworm Ultraleather   | O     | O     | O     | O      | O     |
| <b>Floor Tiles</b>  |       |       |       |        |       |
| North Star Floor Tile   | S     | S     | S     | S      | S     |
| Season Wood Plank Floor Tile  | O     | O     | O     | O      | O     |
| Stacked Washer/Dryer  | O     | O     | O     | O      | O     |
| Dual Zone Heated Tile Floor   | O     | O     | O     | O      | O     |

All options may not be available on every model. Because of progressive improvements, specifications, standard and optional equipment are subject to change without notice or obligation. For a complete and up-to-date list of available options and specifications, visit [tiffinmotorhomes.com](http://tiffinmotorhomes.com).

Visit us on the web for more information on the 2019 Allegro Bus and all 2019 Tiffin Motorhomes, along with the latest product and specification updates at [tiffinmotorhomes.com](http://tiffinmotorhomes.com).

## LIVING AREA/DINETTE

| AVAILABLE OPTIONS:  | 37 AP | 40 AP | 40 IP | 45 OPP | 45 MP |
|---|-------|-------|-------|--------|-------|
| Dinette with Computer Workstation on Passenger Side                                     | S     | S     | S     | S      | S     |
| Ultraleather Recliner and Hide-A-Bed Sofa on Driver Side                                | S     | S     | NA    | NA     | NA    |
| Fireplace Below Midsection Flat Panel TV  | S     | S     | NA    | NA     | NA    |
| Ultraleather U-shaped Dinette on Passenger Side   | O     | O     | O     | O      | O     |
| Delete Dinette Overhead Cabinets  | O     | O     | O     | O      | O     |
| Ultraleather Air Coil Sofa on Driver Side   | NA    | NA    | S     | S      | S     |
| One Ultraleather Recliner and Lift TV on Passenger Side                                 | NA    | NA    | O     | O      | O     |
| Fireplace on Passenger Side (Only available with One Ultraleather Recliner and Lift TV) | NA    | NA    | O     | O      | O     |
| Ultraleather DE Sofa with Lift TV on Passenger Side                                     | NA    | NA    | O     | S      | S     |
| Ultraleather Air Coil Sofa with Lift TV on Passenger Side                               | NA    | NA    | O     | O      | O     |
| Theatre Seating on Driver Side  | NA    | NA    | O     | O      | O     |
| Two Ultraleather Recliners on Driver Side   | NA    | NA    | O     | NA     | O     |
| Two Ultraleather Recliners with Fireplace on Driver Side                                | NA    | NA    | NA    | O      | NA    |

Note: Cannot option Air Coil Sofa on Driver Side and Passenger Side. Cannot option Fireplace on Driver Side and Passenger Side.

Certain variations of furniture combinations will affect sleeping capacity. Certain variations will restrict walkway space.

## KITCHEN

### STANDARD ON ALL MODELS:

- Polished Solid Surface Countertops with Sink Covers
- Expand-an-island
- Stainless steel Farmhouse Sink
- 2 1/2" Deep Lighted Toe Kick
- Single Lever Sink Faucet with Built-in Sprayer
- LED Light Above Countertop
- Stainless Steel Residential Refrigerator
- Galley Soap Dispenser
- Stainless Steel Convection Microwave with Exterior Venting
- 2-burner Induction Cooktop
- Solid Surface Cooktop Cover
- Galley Window

| AVAILABLE OPTIONS:       | 37 AP | 40 AP | 40 IP | 45 OPP | 45 MP |
|--------------------------|-------|-------|-------|--------|-------|
| Dishwasher (Drawer Type) | O     | O     | O     | O      | O     |
| Wolf Cooktop Upgrade     | O     | O     | O     | O      | O     |

## BEDROOM

### STANDARD ON ALL MODELS:

- Memory Foam Queen Mattress (60" x 80")
- Bed Comforter with Throw Pillows
- Ceiling Fan
- Blu-ray System and Satellite Receiver
- Solid Surface Nightstand Tops
- Solar and Privacy Shades
- Laundry Hamper
- Wall Safe
- USB Receptacles

| AVAILABLE OPTIONS:                                   | 37 AP | 40 AP | 40 IP | 45 OPP | 45 MP |
|--|-------|-------|-------|--------|-------|
| Memory Foam King Mattress (72" x 80")                | O     | O     | O     | O      | O     |
| Power Smart King Bed                                 | O     | O     | O     | O      | O     |
| No Bedroom Overhead Cabinet with Window              | O     | O     | O     | O      | O     |
| Bedroom Overhead Cabinet without Window              | O     | O     | O     | O      | O     |
| Bedroom Lift TV with Fireplace                       | O     | O     | O     | O      | O     |
| Bedroom TV (No Lift TV and No Fireplace)             | O     | O     | O     | O      | O     |
| Egress Rear Exit (Requires Bedroom Overhead Cabinet) | O     | O     | O     | O      | O     |

## BATHROOM

### STANDARD ON ALL MODELS:

- Solid Surface Shower with Glass Door
- Medicine Cabinet with Vanity Lights
- Solid Surface Vanity Top and Bowl
- Skylight and LED Light in Shower
- Roof Vent Fan
- Electric Flush Toilet

## COCKPIT

### STANDARD ON ALL MODELS:

- Front Overhead Flat Panel TV
- 12 V Disconnect Switch
- Driver Side Power Window
- Integrated Seatbelts
- Ultraleather Power Driver and Passenger Seats
- Satellite Radio (Subscription Required)
- In-dash Navigation System
- Color Rear Vision Monitor System with Side-view Cameras Activated by Turn Signals
- Power Solar and Privacy Windshield and Cockpit Shades
- CD Player and AM/FM Stereo
- Cupholders on Driver and Passenger Side
- Lighted Switches
- Dual Dash Fans
- Fire Extinguisher
- Beverage Tray
- USB Dash Receptacles
- USB Passenger Side Receptacles
- Power Step Well Cover
- Solid Non-opening Window on Passenger Side

| AVAILABLE OPTIONS:                                      | 37 AP | 40 AP | 40 IP | 45 OPP | 45 MP |
|---|-------|-------|-------|--------|-------|
| Mobileye® Camera/Sensor System                          | O     | O     | O     | O      | O     |
| Vertical Slide Opening Window on Passenger Side         | O     | O     | O     | O      | O     |
| Subwoofer in Dash (Not available with JBL System)       | O     | O     | O     | O      | O     |
| JBL Sound System  | O     | O     | O     | O      | O     |
| Advanced Monitor (Only available with JBL Sound System) | O     | O     | O     | O      | O     |
| Ultraleather Power Passenger Seat with Footrest         | S     | S     | S     | S      | S     |



## LET YOUR JOURNEY BEGIN

Tiffin Motorhomes is proud to be one of the few family-owned manufacturers in the industry, and it makes a significant difference in how our company operates. For starters, with the Tiffin name on every coach, building a superior motorhome isn't just our occupation. It's a matter of personal pride, a pursuit we have committed our lives to perfecting.

We know it's not just about where a coach will take you, but the experience you take from the journey. That's why every Tiffin motorhome is made to move you.

### TIFFIN LIMITED WARRANTY

10

YEAR CONSTRUCTION LIMITED WARRANTY

5

YEAR DELAMINATION LIMITED WARRANTY

1

YEAR LIMITED WARRANTY

1

YEAR COACH ROADSIDE SERVICE

ONGOING CUSTOMER SUPPORT



**LaMesa** REC VAN

---

LaMesaRV.com  
800-496-8778

Some interior furnishings not included. Unless where noted, all content ©2019 Tiffin Motorhomes, Inc. Allegro®, Allegro Breeze®, Allegro Red®, Phaeton®, Allegro Bus®, Zephyr®, Wayfarer®, Roughing It Smoothly®, Open Road®, PowerGlide®, and Pusher® are registered trademarks of Tiffin Motorhomes, Inc. All rights reserved. For all information concerning the limited warranty provided by Tiffin, please refer to the full written limited warranty set forth on the Tiffin website or held by our authorized dealerships.



TIFFINMOTORHOMES.COM

FOR PARTS & SERVICE CALL  
256/356.8661

-  /TIFFINMOTORHOMES
-  /TIFFINMOTORHOMES
-  /TIFFINMOTORHOME
-  /TIFFINMOTORHOME