

TRAVEL TRAILERS

# TRANSCEND

BY GRAND DESIGN RV

TRAVEL TRAILERS



TRANSCEND  
BY GRAND DESIGN RV



**2019**  
TRAILERLIFE READERS' CHOICE  
GOLD AWARD WINNER

**GRAND DESIGN**  
RECREATIONAL VEHICLES







# We'll take you there.



## “ We love our 27BHS Transcend...

it's perfect for our family. My kids enjoy the spacious bunk beds and my wife and I love all the room and features that come with it. We have been impressed with the build quality. We can't wait to take it out again. ”

- Chris & Carissa White

## “ We have a Transcend 27BHS and we love ours.

Our kids have had friends camp with them and having the full size bunks help. I also like having the small outdoor kitchen with the refrigerator. It keeps the kids from running in and getting a drink every 10 seconds. ”

- Dana Wissing Schwartz



## “ We love our 28MKS...

It's a great couples trailer. The layout is so spacious, lots of storage and it's really the light colored interior that really makes it feel homey. We are able to add our own touches. Everything about it is nice and convenient. ”

- Bonnie

**GDRV4LIFE.com**

A COMMUNITY OF GDRV OWNERS SHARING EXPERIENCES, TIPS, TRICKS AND DESTINATIONS

**JOIN THE FAMILY!**





32BHS SHOWN

THOMAS POINT  
RV





# TRANSCEND™

BY GRAND DESIGN RV

## Welcome to the Grand Design family.

Grand Design's Transcend continues our pursuit of building around the needs of our customers. Where others surrender quality, function and features, Transcend focuses on the needs of consumers – open floorplans, functional design and towable with many of today's half-ton trucks and SUVs.

The all-new Grand Design Xplor is the perfect fit for your dream of enjoying the great outdoors. The Xplor starts at the top of its class by offering customer-focused design, built-in quality and the industry-leading warranty that is expected from a Grand Design. *It's time to XPLORE the possibilities.*



TRANSCEND XPLOR



TRANSCEND

**QUALITY DRIVEN. CUSTOMER FOCUSED. BUILT TO LAST.**

# BUILT TO LAST

## MAXIMUM INSULATION

### 1 RESIDENTIAL INSULATED WALLS **R-9**

Exterior walls and sliderooms are framed with studs set 16" on center, and residential fiberglass insulation is adhered in place between each stud.

### 2 INSULATED FLOOR AND ENCLOSED UNDERBELLY **R-11**

The main floor is insulated with a layer of residential fiberglass insulation. The underbelly is also fully enclosed and heated with a dedicated duct.

### 3 INSULATED ROOF **R-40\***

A layer of fiberglass insulation and a layer of radiant foil insulation covers the full length of the roof.

### 4 INSULATED FRONT WALL **R-40\***

The residential fiberglass insulation layer from the roof, continues all the way around to the bottom of the front wall.

\*Equivalent R-Value

## MAXIMUM FUNCTION

A HIGH PERFORMANCE FURNACE DELIVERS UP TO 35,000 BTUS OF HEATING POWER.

TRANSCEND	XPLOR
<b>35K</b>	<b>30K</b>

HEATED & ENCLOSED UNDERBELLY W/ SUSPENDED TANKS



### EVENFLOW HEATING SYSTEM

Evenly distributes heat from the front to the rear without vents in floor that collect dirt and debris.

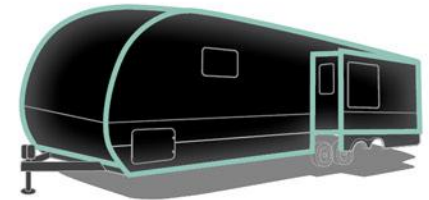

### QUADSEAL

Four protective layers (mylar tape, 2-layers of PVC foam, and a final silicone cap seal) line the perimeter of the coach for ultimate protection from the elements.





**MAGNETIC STORAGE  
DOOR CATCHES**



**MORE OUTLETS**



**MOTION SENSOR  
LED LIGHTING**



**30" 5000lb  
STABILIZER JACKS**



**PET FRIENDLY RV**



**OVERSIZED  
TANK CAPACITIES**



**ALUMINUM  
ENTRY STEPS**

### UNIVERSAL DOCKING STATION

*All-in-one location for utilities and hookups.*



### DEEP SEATED STAINLESS STEEL SINK

*Residential size kitchen sink*



### SOLID WOOD

*Cabinet doors and drawer fronts*



## FRONT WALL CONSTRUCTION

Vertical banana rafters are added to the framework to increase support. Hurricane ties are also used to withstand high winds.

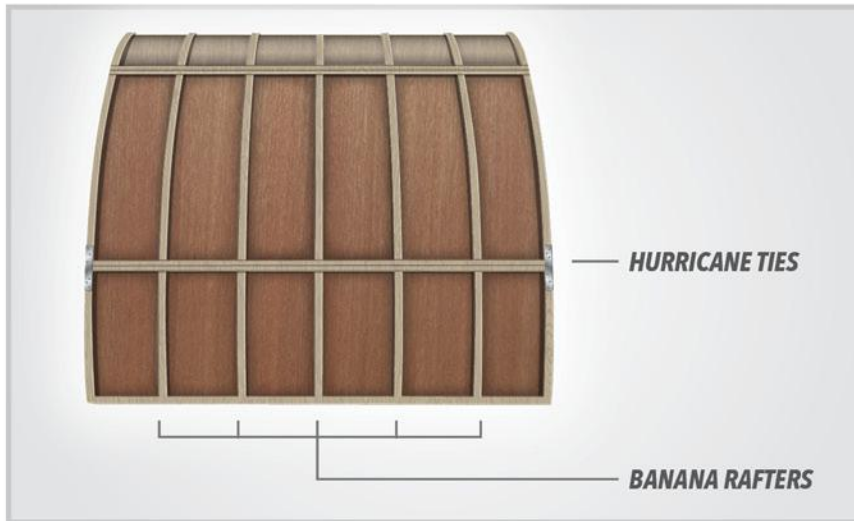

# BACKED TO A HIGHER STANDARD

Every Grand Design RV is backed with a class leading 3-year limited structural warranty. By selecting suppliers with similar philosophies, many components used on our coaches also carry an extended warranty through the component manufacturer.



- ▶ **AXLES** (5 Years)
- ▶ **CHASSIS** (3 Years)  
*(Main Steel Frame, Steel Frame Outriggers and Cross Members)*
- ▶ **ROOF COVERING** (15 Years)
- ▶ **TIRE WARRANTY**  
*(5 Years w/12 Month no questions asked replacement for manufacturer defects)*
- ▶ **EXTERIOR GRAPHICS** (5 Years)

**QUALITY DRIVEN. CUSTOMER FOCUSED. BUILT TO LAST.**

# TRANSCEND™ XPLÖR

IT'S TIME TO XPLOR THE POSSIBILITIES

78"

78" INTERIOR  
HEADROOM



POWER  
TONGUE JACK



TUFF-COAT  
EXTERIOR FINISH



USB PORTS (2)

30K

30,000 BTU  
FURNACE

13.5K

13,500 BTU  
AIR CONDITIONER

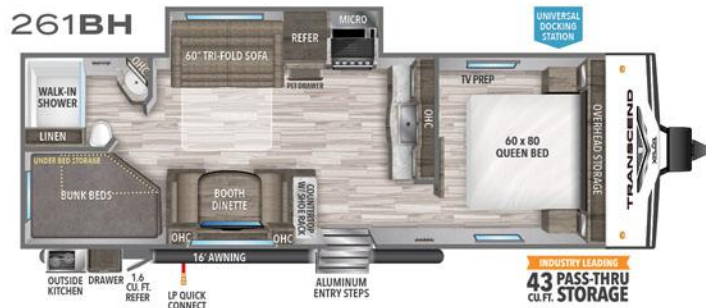
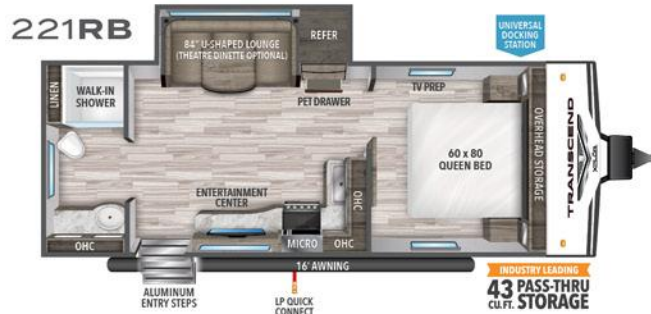
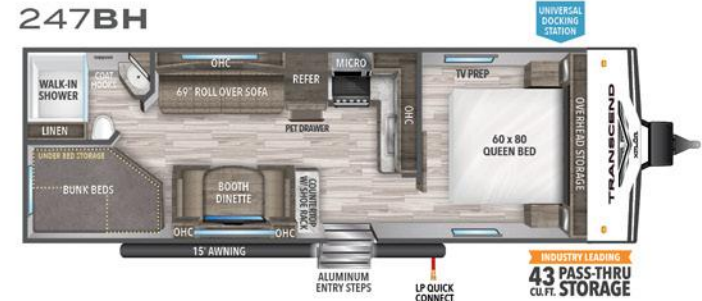





LIVING AREA 260RB



KITCHEN 260RB

	UVW <sup>†</sup>	GVWR	HITCH <sup>‡</sup>	LENGTH <sup>‡</sup>	HEIGHT	CAPACITY
187MK	4,796	6,395	480	22' 11"	11'	62 39 39
221RB	5,389	6,995	510	26' 10"	11'	62 68 39
245RL	6,327	7,495	618	30' 8"	11'	62 78 39
247BH	5,392	6,995	546	29' 11"	11'	62 78 39
260RB	6,147	7,495	627	31' 6"	11'	62 78 39
261BH	6,078	7,495	618	30' 11"	11'	62 78 39
265BH	6,327	7,995	740	32' 9"	11' 1"	62 78 39

<sup>†</sup>Based on average weight of standard build in lbs.

<sup>‡</sup>Hitch to rear

FRESH GRAY BLACK  
(gal.)

Because of our commitment to continuous product improvement, Grand Design Recreational Vehicles reserves the right to change components, standards, options, specifications, and materials without notice and at any time. Photos may show optional equipment which may not be included in the standard purchase price of the featured unit. Be sure to review current product details with your local dealer before purchasing. Rev 1.29.20

## EXTERIOR & CONSTRUCTION

- Power Tongue Jack
- Solar Power Inlet
- Backup Camera Prep
- Black Tank Flush
- 20# LP Bottles (2) with Cover
- 28" Friction Hinge Entry Door
- High-Capacity Water Pump
- Extra Large 2" Fresh Water Drain Valve
- Oversized Tank Capacities
- Walk-on Roof
- Easy Access Low Point Drain Valves
- PVC Roof Membrane w/ 15-Year Warranty
- Insulated Storage Doors
- Rear Wall Insulation (R-9)
- Side Walls Insulation (R-9)
- Slideroom Roof and End Wall Insulation (R-9)
- Main Floor Insulation (R-11)
- Thermofoil Roof Insulation (R-40\*)
- Backed for Ladder

\*R-Value Equivalent

## INTERIOR

- Large Solid Bedroom Door (Master Suite)
- Residential Bedspread
- Cable/SAT Prep
- Walk-in Shower
- Power Vent Fans (Living Area and Bathroom)
- Medicine Cabinet with Mirror
- ABS Tub Surround
- Solid Hardwood Drawer Fronts
- Solid Core Cabinet Stiles
- Pre-Drilled and Pocket Screwed Cabinetry
- Ball Bearing Full Extension Drawer Glides
- Residential Countertops
- Microwave
- 3-Burner Range with Oven
- USB Ports (2)
- Upgraded Residential Furniture
- More Power Outlets

## OPTIONS

- Theatre Dinette IPO Booth Dinette (NA 247BH, 245RL, 260RB & 261BH)
- 15k Ducted AC IPO 13.5K AC (Forced on 265BH)
- 32" LED TV

## ELEVATION PACKAGE

Mandatory Package

- 78" Interior Height
- 60" x 80" Queen Bed
- 62 Gallon Fresh Water Capacity
- Spare Tire w/ Carrier
- Black Tank Flush
- Nitrogen Filled Radial Tires
- Magnetic Storage Door Catches
- Foot Flush Toilet
- Residential Booth Dinette w/ Reversible Cushions
- Extended Grab Handle
- E-Z Lift Bed Storage w/ Struts
- Tinted Windows
- High Rise Faucet w/ Pull Down Sprayer
- Reverse Raised Panel Cabinet Doors
- Solid Wood Drawer Fronts
- 6 Gal DSI Quick Recovery Water Heater
- Deep Seated Stainless Steel Sink
- 7 cu.ft. Refrigerator
- Upgraded STRONGWALL Metal Exterior
- Rear Ladder

## XPLOR POWER PACKAGE

Mandatory Package

- LED Interior Lighting
- Power Awning
- AM/FM/CD/DVD/Bluetooth Stereo
- Exterior Speakers
- Detachable Power Cord w/ LED Light
- USB Ports
- Motion Sensor Lights in Key Areas
- Backup Camera Prep
- Solar Prep
- Battery Disconnect Switch
- HD TV Antenna
- Power Tongue Jack

## XPLOR SEASON PROTECTION PACKAGE

Mandatory Package

- Heated & Enclosed Underbelly w/ Suspended Tanks
- Designated Heat Duct to Subfloor
- Moisture Barrier Floor Enclosure
- 30k BTU High Capacity Furnace
- High Density Roof Insulation w/ Thermofoil
- Moisture Barrier Floor Enclosure
- Attic Vent
- 13.5k Ducted AC
- Dual 20# LP Tanks with Cover
- EvenFlow Ductless Heating System Throughout
- E-Z Winterization
- All-in-One Utility Center

TRANSCEND XPLOR



# TRANSCEND™

BY GRAND DESIGN RV

82"

MAXIMUM HEADROOM



POWER TONGUE JACK



TUFF-COAT EXTERIOR FINISH



USB PORTS (2)

35K

35,000 BTU FURNACE

15K

15,000 BTU AIR CONDITIONER



REAR LADDER

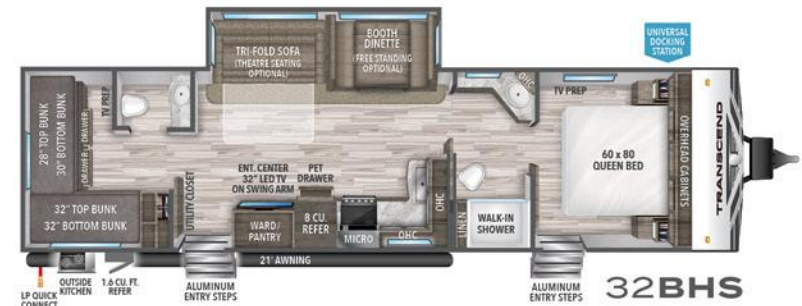
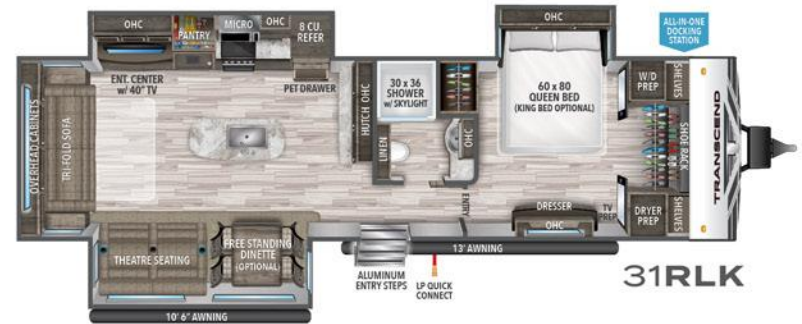
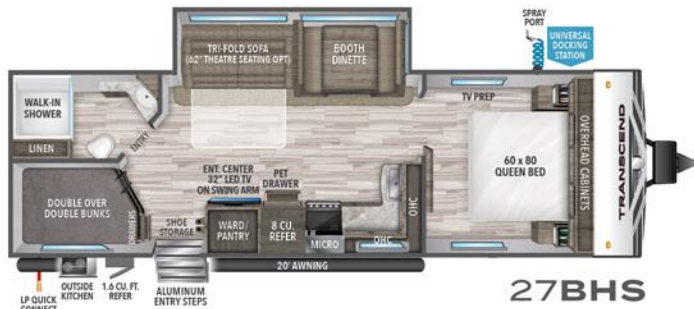

**25% THICKER** THAN THE COMPETITION

The satin metal exterior skin is 25% thicker, for a more durable and better looking sidewall.



**2019**  
TRAILERLIFE READERS' CHOICE  
GOLD AWARD WINNER





**BEDROOM 32BHS**



**KITCHEN 27BHS**

	UVW <sup>†</sup>	GVWR	HITCH <sup>‡</sup>	LENGTH <sup>‡</sup>	HEIGHT	CAPACITY	WHEEL
<b>27BHS</b>	6,710	7,995	633	32'	11' 4"	62 68 39	15"
<b>28MKS</b>	7,195	8,495	709	34' 2"	11' 4"	62 78 39	15"
<b>29TBS</b>	7,325	8,795	672	35' 11"	11' 4"	62 68 39	15"
<b>30RBS</b>	7,820	9,995	780	34' 9"	11' 5"	62 68 39	15"
<b>31RLK</b>	9,276	11,395	945	37' 5"	11' 9"	62 107 39	16"
<b>32BHS</b>	7,738	9,295	728	36' 11"	11' 4"	62 78 78	15"

<sup>†</sup>Based on average weight of standard build in lbs.

<sup>‡</sup>Hitch to rear

**FRESH GRAY BLACK**  
(gal.)

Because of our commitment to continuous product improvement, Grand Design Recreational Vehicles reserves the right to change components, standards, options, specifications, and materials without notice and at any time. Photos may show optional equipment which may not be included in the standard purchase price of the featured unit. Be sure to review current product details with your local dealer before purchasing. Rev 01.29.20

## EXTERIOR & CONSTRUCTION

- Power Tongue Jack
- Solar Power Inlet
- Black Tank Flush
- 20# LP Bottles (2) w/ Cover
- Friction Hinge Entry Door
- High-Capacity Water Pump
- Extra Large 2" Fresh Water Drain Valve
- Battery Kill Switch (Pass Thru)
- Oversized Tank Capacities
- Walk-on Roof
- PVC Roof Membrane w/ 15-Year Warranty
- Easy Access Low Point Drain Valves
- Insulated Storage Doors
- Side Walls and Rear Wall Insulation (R-9)
- Slideroom Roof and End Wall Insulation (R-9)
- Main Floor Insulation (R-11)
- Thermofoil Roof Insulation (R-40\*) \*R-Value Equivalent

## INTERIOR

- Residential Bedspread
- Cable/SAT Prep
- Walk-In Shower with ABS Tub Surround
- Power Vent Fan
- Medicine Cabinet with Mirror
- Solid Wood Drawer Fronts
- Solid Core Cabinet Stiles
- Pre-Drilled and Screwed Cabinetry
- Ball Bearing Full Extension Drawer Glides
- Large Panoramic Windows
- Residential Countertops
- Microwave
- 3-Burner Range with Oven
- USB Ports (2)
- Upgraded Residential Furniture
- More Power Outlets

## OPTIONS

- Forced Theater Seating IPO Tri-Fold Sofa Option (\*M 28MKS, 31RLK / \*O 27BHS, 32BHS)
- Free Standing Table and 4 Chairs (28MKS, 31RLK, 32BHS only)
- 78" Theatre Seating IPO Booth Dinette (29TBS, 30RBS)
- 2nd AC - 13.5K BTU

\*M = MANDATORY \*O = OPTION

## RISE ABOVE PACKAGE

- Aluminum Entry Steps *Mandatory Package*
- Tri-Fold Hide-a-Bed Sofa
- 82" Interior Height
- Master Suite w/ 60" x 80" Queen Bed
- All-In-One Utility Center
- 62 Gallon Fresh Water Capacity
- Upgraded STRONGWALL Aluminum Exterior
- Spare Tire w/ Carrier
- Black Tank Flush
- Aluminum Rims w/ Nitrogen Filled Radial Tires
- Magnetic Storage Door Catches
- Porcelain Foot Flush Toilet
- Residential Booth Dinette w/ Reversible Cushions
- Extended Grab Handle
- Rear Ladder
- E-Z Lift Bed Storage w/ Struts
- Tinted Windows
- Pet Friendly Drawer Under Refrigerator
- High Rise Faucet w/ Pull Down Sprayer
- Reversed Raised Panel Cabinet Doors
- 6 Gal DSI Quick Recovery Water Heater
- Deep Seated Stainless Steel Sink
- 8 cu.ft. Double Door Refrigerator

## ECLIPSE POWER PACKAGE

- LED Interior Lighting and Porch Light *Mandatory Package*
- Power Tongue Jack
- Power Awning
- AM/FM/CD/DVD Bluetooth Stereo
- Exterior Speakers
- 50 Amp Service
- High Definition LED Television and HD TV Antenna
- Detachable Power Cord w/ LED Light
- Motion Sensor Pass Thru and Entry Lighting (LED)
- Backup Camera Prep
- Solar Prep
- Battery Disconnect Switch

## EXTENDED SEASON PROTECTION PACKAGE

*Mandatory Package*

- Heated and Enclosed Underbelly w/ Suspended Tanks
- Dedicated Heat Duct to Subfloor
- High Density Roof Insulation w/ Thermofoil (R-40)
- Moisture Barrier Floor Enclosure
- 35k BTU High Capacity Furnace
- Attic Vent
- 15k Ducted Main AC
- Dual 20# LP Tanks w/ Cover
- EvenFlow Ductless Heating Throughout
- E-Z Winterization



# WE STRIVE FOR NOTHING LESS THAN CUSTOMERS FOR LIFE!



Thank you for taking the time to tour our coach.

We would like to share what sets Grand Design RV apart from all other RV manufacturers and why this difference is important to you.

My close friends and I were part of an ownership team at a travel trailer, fifth wheel company that grew to become one of the largest RV manufacturers in the world. While proud of this accomplishment, it became difficult to stay in touch with customers, employees, and ultimately the quality of the final product. It became obvious, there was a better way.

In 2012 we started with a mission to build a better RV company. A company with a culture that desires a long-term, personal connection with customers, employees and dealers – that company became Grand Design RV. Our business model of doing the right thing has led us to many years of unparalleled growth.

At Grand Design we are customer centered and everything we do daily revolves around you. Our goal is simple – continue to lead the industry with quality, innovative products while striving to improve our customers' RV experience before, during and after their purchase. We strive for nothing less than customers for life and I would be honored to personally welcome you to the Grand Design family.

Warmest Regards,

President / CEO / Co-Founder

## LONG TERM VALUE

Everything we do at our company is designed to build long-term value in what we offer our customers, "More features and superior value for your dollar."

## CUSTOMER CENTERED

Our focus, from the very first day we opened our doors, revolves around our customers. Your satisfaction is our future. GDRV4Life!

## RAISING THE QUALITY BAR

We put every Grand Design RV through a series of quality inspection gates during the manufacturing process. Once completed, the unit undergoes a comprehensive "final finish" inspection. At this point, most manufacturers ship their coaches to the dealer for retail sale. We aren't most manufacturers. Every one of our coaches is moved to a PDI (Pre-Delivery Inspection) area where they are put through a rigorous 300+ point inspection checklist. It is only after this PDI that we certify a unit ready to ship to our dealers.

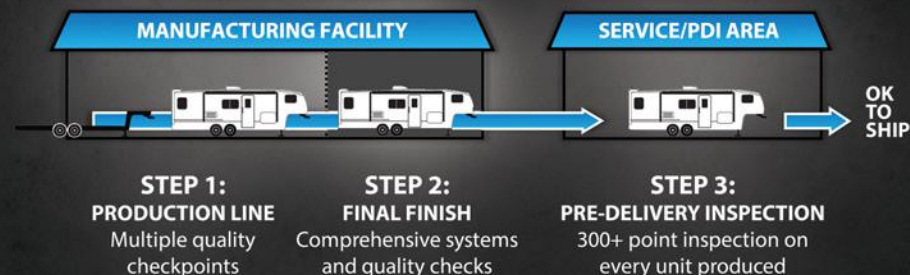

## SUPERIOR SERVICE

Anything built by humans that travels down the open road is subject to issues. It's how those issues are addressed that makes Grand Design so special to our owners. Visit the independent owners page on Facebook (Grand Design RV Owners) and see for yourself. We take care of our customers after the sale. An informed customer will be a Grand Design customer!

## CLASS LEADING WARRANTY

We back every one of our coaches with a 3-year limited structural warranty.



2019 GOLD AWARD WINNER  
IN ALL 3 CATEGORIES!



TRAVEL TRAILERS FIFTH WHEELS TOY HAULERS

# LAMESA REC VAN

LaMesaRV.com  
800-496-8778



Grand Design RV was created in 2012 and founded by current CEO, Don Clark and brothers Ron and Bill Fenech (Representing over 80 combined years of experience in the RV Industry).