

2024 ENTEGRA COACH LAUNCH

# Launch

DIESEL CLASS B MOTORHOME



ENTEGRA  
COACH®









19Y

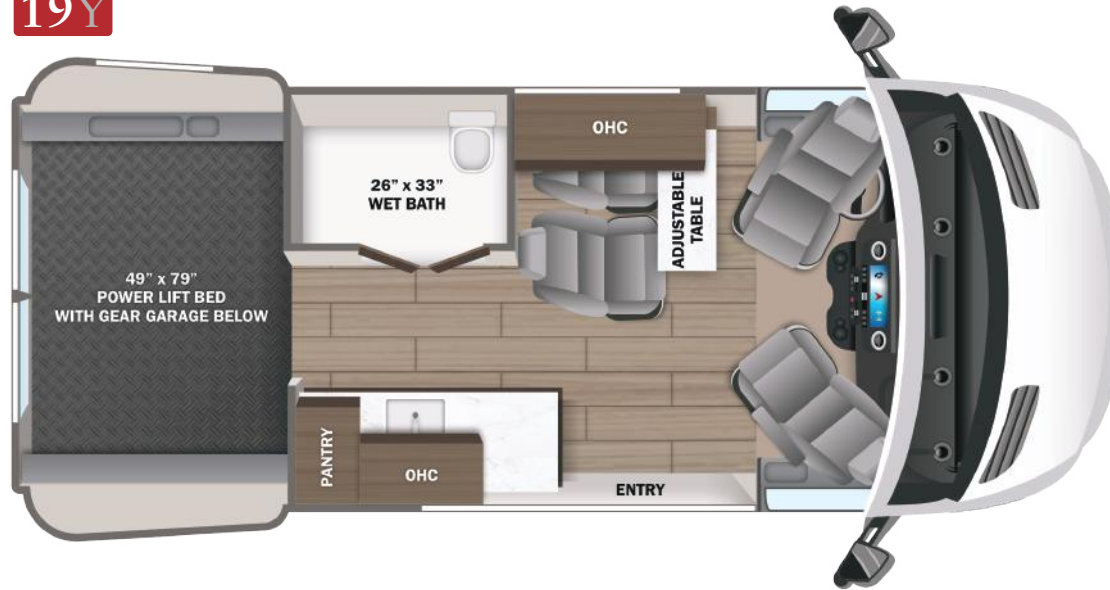

## EXTERIOR SELECTIONS



Silver Van



Sandstone Van



Blue-Grey Van



Aztec Partial Paint (Silver Van Only)



Forest Glade Partial Paint (Sandstone Van Only)



Mystic Tide Partial Paint (Blue-Grey Van Only)

## CUSTOMER VALUE PACKAGE

- E-Z Drive™: Konig® shocks, heavy-duty rear stabilizer bar
- Carefree® armless patio awning with LED light strip and wind sensor
- Double roof rack and moveable roof ladder
- Front and rear wind deflectors with front LED light bar
- Timberline hydronic heating system with LED touchscreen control
- 13,500 BTU 48V Coleman®-Mach® 10 air conditioner
- Black aluminum wheels with BFGoodrich® All-Terrain T/A® KO2® tires
- Starlink satellite internet system

## CHASSIS

- Mercedes-Benz® Sprinter 2500 AWD van with 144 in. wheelbase
- GVWR- 9,050 lb.
- GCWR- 13,930 lb.
- 2.0L 4-cylinder diesel engine with 211HP and 332 ft.-lb. torque
- 9-speed automatic transmission
- 250-amp alternator
- 5,000 lb. rear hitch receiver with 7 pin connector
- 12V chassis battery
- 24.5 gal. fuel tank (diesel)
- 5.8 gal DEF tank

## EXTERIOR

- LED-lit running boards for cab and entry doors
- Chrome grille package
- Fold-down exterior table
- Daytime running headlamps
- 48V - 210 amp hour smart lithium battery providing 10KW hours of power
- Prepped for auto engine start with high idle
- 3,500W inverter
- 2nd 48V alternator dedicated to lithium battery
- House battery disconnect switch
- 200W of roof-mounted solar panels
- Slow charge solar panel for chassis battery
- Portable solar plug
- 30-amp electrical service with detachable power cord
- 120V exterior outlet
- Heated grey tank (12V pad) with skid plate
- Interior-mounted fresh water tank
- LED-lit holding tank valves
- Utility center with water controls and outside hose
- City water connection
- Winterization drain system
- 12V demand water pump
- Water filtration system

## COCKPIT

- 10.25 in. integrated Mercedes-Benz® MBUX infotainment center with GPS, Apple® CarPlay™ and Android Auto™
- Power folding/heated side-view mirrors
- Heated power swivel driver/passenger seats
- Leather-wrapped tilt steering wheel with integrated controls
- Smartphone tray with wireless charging
- Parking package with 360° camera
- Backup camera
- Active Distance Assist DISTRONIC®
- Active lane keeping assist
- Crosswind assist
- Hill start assist
- Brake assist plus
- Traffic sign assist
- Attention assist
- Breakdown management
- Emergency call system
- Driver and passenger airbags
- Tire pressure monitoring system (TPMS)
- Rain-sensing windshield wipers
- Headlight assistant
- LED high performance headlights
- Third brake light
- Power windows and door locks
- Privacy shades for cab windows
- Remote keyless entry

## INTERIOR

- Custom-molded ABS interior wall panels
- Soft-touch vinyl ceiling
- High-intensity LED ceiling lights
- Tecnoform® European-style, cabinetry
- Durable rubber flooring
- Firefly Multiplex system - wall-mounted touchscreen and mobile app for total coach control
- MaxxAir Deluxe roof vent
- 120V/USB outlets throughout
- Side screen door with magnetic and zipper close offs
- Removable privacy shade for sliding door window
- Rear screen door with roll-up and black out capabilities
- Rear dual-pane acrylic window with cassette shades
- (2) sliding vented windows
- (2) additional cab bucket seats with slide and recline features
- Seatbelts in all seating locations
- Removable/adjustable table
- JBL® Flip 5 removable wireless Bluetooth speaker
- Smoke alarm
- Carbon monoxide detector
- Fire extinguisher

## KITCHEN

- Tecnoform® pull-out kitchen countertop extension
- Pantry
- 3 cu. ft. DC refrigerator
- Portable induction cooktop
- Stainless steel sink

## BEDROOM

- Drop-down overhead bed with 750 lb. capacity
- Fiberglass side pods create larger sleeping surface
- Rear garage under bed with L-track mounts for securing cargo
- (2) recessed under-bed storage bags

## BATHROOM

- All-in-one wet bath with shower and cassette toilet
- Aqua View® SHOWERMISER™ water management system
- Removable bamboo shelf in wet bath
- Retractable clothes line in shower
- Powered roof vent in bathroom

## WARRANTY



At Entegra Coach, we build our RVs to handle every adventure, then back them with an outstanding warranty. Our 2-year limited warranty has you covered for 2 camping seasons. That's 730 days. For a copy of our 2-year limited warranty with complete terms and conditions, please contact your local Entegra Coach dealer.

It is important for your safety and enjoyment that you are aware of the weights and tow ratings of the RV you select. Consult a competent advisor for questions or advice. Whether you are new to RVing or a veteran, get a feel for the performance of your RV before heading out on the roadways. When you tow a vehicle with your RV, you must drive differently than when you drive a single vehicle. Practice hooking up, driving, backing up and braking in a safe environment or seek out professional instruction. Jayco affixes a weight label to each RV which lists weight information for that vehicle. Refer to that label to verify the vehicle will meet your requirements. Gross Vehicle Weight Rating (GVWR): The maximum permissible weight of the motorhome, including the Unloaded Vehicle Weight (UVW) plus passengers, personal items, all cargo, fluids, options and dealer-installed accessories. The GVWR is equal to or greater than the sum of the UVW and the Cargo Carrying Capacity. Gross Combined Weight Rating (GCWR): The maximum allowable combined weight of the motorhome used as a tow vehicle and the attached towed vehicle.

Floorplan	GVWR (lbs.)	GCWR (lbs.)	Wheel Base	Overall Length	Exterior Height w/ A/C & Satellite	Exterior Width	Interior Height	Fresh Water Capacity (gal.)	Grey Waste Water Capacity (gal.)	Black Waste Water Capacity (gal.)
19Y	9,050	13,930	144"	19' 6"	10' 1"	82"	74"	21	21	4.75

**LAMESA REC VAN**  
LaMesaRV.com  
800-496-8778

**ENTEGR A**  
COACH  
Part of Jayco Family of Companies

Entegra Coach, Inc., P.O. Box 460, Middlebury, IN 46540, www.entegracoach.com. See dealer for further information and prices. All information in this brochure is the latest available at the time of publication approval. Entegra Coach reserves the right to make changes and to discontinue models without notice or obligation. Photos in this brochure may show optional equipment and props for photography purposes. RVs built for sale in Canada may differ to conform to Canadian codes. ©2023 Entegra Coach, Inc. Printed in U.S.A. 2032822.2024

f Instagram YouTube  
entegracoach.com/launch