

ACCOLADE XT

2025 SUPER CLASS C DIESEL MOTORHOME



2025 ENTEGRA COACH ACCOLADE XT

ENTEGRA
COACH



INTERIOR DÉCOR

WOOD OPTIONS

Arcadian Ash

Huntington

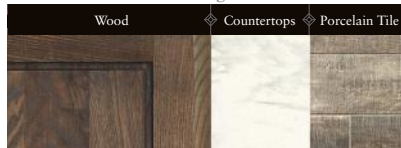

FABRIC OPTIONS

Cold Spring

Warm River



2025 ACCOLADE XT

Diesel Super Class C Motorhome

29T

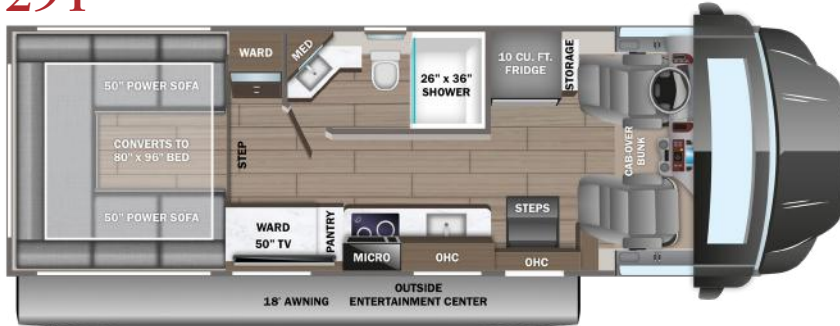

32U



OPTIONS
A AND C

35L

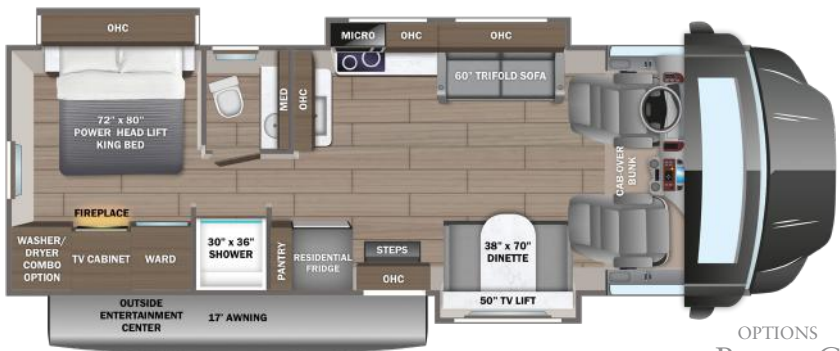

OPTIONS
B AND C

OPTIONS

A



68-inch Power
Theater Seating

B



60-inch Power
Theater Seating

C



15 cu. ft. 12V
refrigerator

PAINT SELECTIONS



Alpine Byrum Full-Body Paint



Backwoods Desertscape Full-Body Paint



Desert Dune Full-Body Paint



Parched Earth Full-Body Paint



Spring Rain Full-Body Paint

ACCOLADE XT

Standards & Options

CUSTOMER VALUE PACKAGE

E-Z Drive™ Premier: Computer-balanced driveshaft, heavy-duty front and rear stabilizer bars, Koni® shocks
One-piece, seamless, fiberglass rear cap with auxiliary flood lights (32U, 35L)
Automotive-bonded, panoramic window in front cap with power shade
15,000 BTU A/C unit with heat pump and second 13,500 BTU A/C unit
Electric, wind-sensing, legless patio awning with LED lights
2,000W pure sine wave inverter
200W solar panel with dual controller
Starlink satellite internet system
Backup and side-view cameras
Two-burner induction cooktop
10 cu. ft. 12V refrigerator (29T)
18 cu.ft. residential refrigerator (32U, 35L)
Convection microwave oven

STANDARD CHASSIS EQUIPMENT

Ford® F550 4x4 chassis (29T)
Ford® F600 4x4 chassis (32U, 35L)
GVWR - 19,500 lb. (29T); 22,000 lb. (32U, 35L)
GCWR - 31,500 lb. (29T); 34,000 lb. (32U, 35L)
6.7L Power Stroke V8 Turbo diesel engine with block heater
- 330 HP at 2,200 RPM and 950 ft. lb. torque at 1,800 RPM
10-speed automatic transmission
332-amp alternator (dual)
All-terrain tires - 245/70R19.5 (225/70R19.5 on F550 chassis)
HiSpec matte black aluminum rims
2 in. BDS radius arm suspension lift
12,000 lb. rear hitch receiver
7-pin plug
Hellwig® helper springs (29T)
Ford® AdvanceTrac® with RSC® (roll stability control) and trailer sway control
Integrated trailer brake controller
Single chassis battery (750 CCA 78 AH)
Dual fuel tanks (26.5 gal. and 40 gal.)

STANDARD EXTERIOR EQUIPMENT

TuffShell™ vacuum-bond laminated roof, floor and sidewalls
Bead-foam insulation (R-24 max roof, R-9 max floor, R-8 max walls)
One-piece, seamless, crowned fiberglass roof
Lippert™ 4000 series frameless bonded windows
Premium Sikkens full-body paint
Automatic hydraulic leveling jacks
Electric-powered entrance steps
Slideout cover awnings
Exterior entertainment center with outside speakers, LED HD Smart TV and Bluetooth® receiver
Winegard® In-Motion satellite dish

Full pass-through storage compartments with lockable slam latch doors
Flush-mount LED marker lights
Third brake light
Roof ladder
KING Jack™ antenna
Cable TV hookup with RG-6 coax
6,000W diesel generator and auto-gen start
(2) 6V AGM house batteries
Transfer switch with reverse polarity protection
50-amp service
Powered cord reel
24.5 gal. propane tank (83 lb.)
LP quick-connect hookup
Exterior utility center
Winterization drain system
Outside shower and black tank flush
12V demand water pump
Water filtration system

STANDARD COCKPIT EQUIPMENT

Ford® SYNC® 4 infotainment center with Apple® CarPlay™ and Android Auto™
Audible lane departure warning
Pre-Collision Assist® with automatic emergency braking (AEB)
SOS Post Crash Alert System™
Driver and passenger airbags
Safety Canopy® system with roll-fold side-curtain airbags
Remote keyless entry and perimeter anti-theft alarm
SecuriLock® anti-theft ignition
Quad dual-beam halogen headlights
Rainlamp wiper activated headlights
Remote start
Adjustable gas/brake pedals
Individual tire pressure monitoring system (TPMS) (N/A on F550 chassis)
Cruise control
Power windows and door locks
Auxiliary start switch
8-way power driver seat
Tilt steering wheel
Privacy curtains for cab area

STANDARD INTERIOR EQUIPMENT

Custom-molded ABS surround in cab-over area
Overhead bunk with 750 lb. capacity
Firefly Multiplex system - wall-mounted touchscreen and mobile app for total coach control
84 in. interior ceiling height with padded vinyl ceiling
High-intensity, recessed LED ceiling lights
Integrated day/night cassette shades
Raised-panel hardwood cabinet doors and drawer fronts

Deluxe hidden cabinet hinges
Ball-bearing drawer guides
30,000 BTU auto-ignition furnace
10 gal. gas/electric water heater
Entegra-exclusive, easy-operation legless dinette table (32U, 35L)
2-point lap safety belts in all designated seating locations
Car seat tethers (select floorplans)
LED HD Smart TV in living area
JBL® audio system
Smoke alarm
Carbon monoxide detector
Fire extinguisher
LED-lit, solid-surface kitchen countertops with recessed stainless steel sink and sink covers
Pull-out countertop extension (select models)
Rear U-shaped power sofa converts to 80 in. x 96 in. bed (29T)
Walk-around, king-size bed with bedspread and nightstands (32U, 35L)
LED HD Smart TV in bedroom (32U, 35L)
Furrion® electric fireplace in bedroom (35L)
Under-bed storage (select models)
Large wardrobes
Decorative shower surround with glass door, skylight and light
Macerating porcelain toilet
Powered roof vent in bathroom with wall switch

OPTIONS

Ford® F600 chassis upgrade (29T)
Power theater seating
15 cu. ft. 12V refrigerator
Combination washer/dryer (35L)
Canadian Shaw® TRAV'LER® satellite dish
Winegard® TRAV'LER® satellite dish - DIRECTV®

2+3
YEAR LIMITED STRUCTURAL WARRANTY

NO ONE OFFERS A BETTER WARRANTY

At Entegra Coach, we build our RVs to handle every adventure, then back them with our industry-leading 2+3 limited warranty. Our 2-year limited warranty has you covered for 2 camping seasons. That's 730 days. In addition, our 3-year structural limited warranty has you covered for 3 camping seasons or 1,095 days. You won't find a better limited warranty in the business, because the only strings we attach are those that deliver the ultimate in reliability. For a copy of our 2-year limited + 3-year structural limited warranty with complete terms and conditions, please contact your local Entegra Coach dealer.

It is important for your safety and enjoyment that you are aware of the weights and tow ratings of the RV you select. Consult a competent advisor for questions or advice. Whether you are new to RVing or a veteran, get a feel for the performance of your RV before heading out on the roadways. When you tow a vehicle with your RV, you must drive differently than when you drive a single vehicle. Practice hooking up, driving, backing up and braking in a safe environment or seek out professional instruction. Jayco affixes a weight label to each RV which lists weight information for that vehicle. Refer to that label to verify the vehicle will meet your requirements. Gross Vehicle Weight Rating (GVWR): The maximum permissible weight of the motorhome, including the Unloaded Vehicle Weight (UVW) plus passengers, personal items, all cargo, fluids, options and dealer-installed accessories. The GVWR is equal to or greater than the sum of the UVW and the Cargo Carrying Capacity. Gross Combined Weight Rating (GCWR): The maximum allowable combined weight of the motorhome used as a tow vehicle and the attached towed vehicle.

Floorplan	GVWR (lbs.)	GCWR (lbs.)	Wheel Base	Overall Length	Exterior Height w/ A/C & Satellite	Exterior Width	Interior Height	Fresh Water Capacity (gal.)	Grey Waste Water Capacity (gal.)	Black Waste Water Capacity (gal.)
29T	19,500	31,500	205"	29' 10"	12' 6"	101"	84"	72	43	30
32U	22,000	34,000	227"	34' 2"	12' 6"	101"	84"	42/22	38	30
35L	22,000	34,000	258"	37' 3"	12' 6"	101"	84"	42/22	30	30



Entegra Coach, Inc., P.O. Box 460, Middlebury, IN 46540, www.entegracoach.com. See dealer for further information and prices. All information in this brochure is the latest available at the time of publication approval. Entegra Coach reserves the right to make changes and to discontinue models without notice or obligation. Photos in this brochure may show optional equipment and props for photography purposes. RVs built for sale in Canada may differ to conform to Canadian codes. ©2025 Entegra Coach, Inc. Printed in U.S.A. 2032943



LEGACY ISN'T LEFT.
IT'S LIVED.