

EXPANSE

2025 GAS CLASS B MOTORHOME



2025 ENTEGRA COACH EXPANSE



ENTEGRA
COACH



2025 EXPANSE

Gas Class B Motorhome

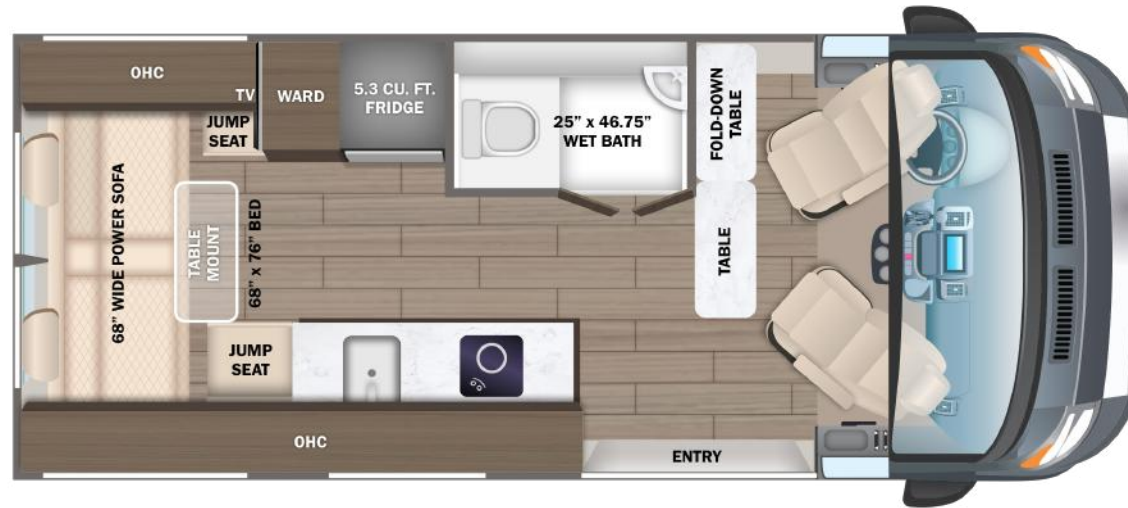
21B



EXTERIOR SELECTION



Silver Van

CUSTOMER VALUE PACKAGE

E-Z Drive™: Hellwig® helper springs, rear Koni® shocks
 Carefree® armless motion sensing patio awning with LED light strip
 Truma Combi Eco Plus water heater and furnace
 4-way swivel driver and passenger seats
 Winegard® Connect 2.0 4G/Wi-Fi/digital TV antenna

STANDARD CHASSIS EQUIPMENT

Ford® Transit AWD 350HD
 148 in. wheelbase
 GVWR - 11,000 lb.
 GCWR - 13,000 lb.
 3.5L EcoBoost V6 310 HP engine with 400 ft-lb. torque
 10-speed transmission
 3.73 limited slip axle
 250-amp alternator
 205/75R16C BSW all-season tires
 Aluminum wheels
 Heavy-duty trailer tow package with dual 4/7 pin connector
 (2) 12V AGM chassis batteries (70 amp-hr)
 25 gal. fuel tank (gas)

STANDARD EXTERIOR EQUIPMENT

Fiberglass running boards for cab and entry doors
 Keyless entry pad
 Daytime running headlamps
 Cable TV hookup with RG-6 coax
 Onan® 2,800W generator with auto-gen start
 200W roof-mounted GoPower® solar panel with integrated control panel
 1,000W inverter
 (2) 12V AGM house batteries
 House battery disconnect switch
 30-amp electrical service with detachable power cord
 (2) 120V exterior outlets
 6 gal. propane tank (20 lb.)
 LP quick-connect hookup
 Heated grey holding tank (12V pad)
 LED-lit holding tank valves
 Black tank flush
 Winterization drain system
 12V demand water pump
 Water filtration system
 Outside shower

STANDARD COCKPIT EQUIPMENT

12 in. SYNC 4 HD/NAV/IACC multi-function display
 Power-adjusting side-view mirrors
 360° camera with split view and front camera washer
 Rear-view camera with trailer hitch assist
 Backup camera displayed in rear-view mirror
 Blind spot assist 1.0 with trailer coverage and cross-traffic alert
 Intelligent adaptive cruise control
 Lane-keeping system
 Front, side and reverse sensing systems
 Forward collision warning
 Pre-collision assist with automatic emergency braking (AEB)
 Post-collision braking
 SOS Post Crash Alert System™
 Driver and passenger airbags
 Safety Canopy® side-curtain airbags
 Ford® AdvanceTrac® with RSC® (roll stability control)
 Side wind stabilization
 Hill start assist
 SecuriLock® passive anti-theft system with engine immobilizer
 Autolocking drive away with crash unlocking
 Remote keyless entry
 FordPass™ Connect
 Tire pressure monitoring system (TPMS)
 Rain-sensing wiper system
 Automatic high-beam headlights
 Wiper-activated headlights
 Power windows and door locks
 Privacy shades for cab windows

STANDARD INTERIOR EQUIPMENT

Custom-molded ABS interior wall panels
 Soft-touch vinyl ceiling
 High-intensity LED ceiling lights
 Tecnoform® European-style, high-gloss cabinetry
 Ball-bearing drawer guides
 Residential vinyl flooring
 Firefly Multiplex system - wall-mounted touchscreen and mobile app for total coach control
 120V Coleman®-Mach® 10 13,500 BTU air conditioner
 Powered roof vent in living area
 Side screen door with magnetic and zipper close offs
 Sliding vented windows
 Rear screen door with roll-up and black-out capabilities
 Removable privacy shade for sliding door window
 24 in. LED HD TV
 JBL® Flip 6 removable wireless Bluetooth speaker
 Adjustable table with multiple mounts and fold-down work station
 5.3 cu. ft. 12V refrigerator

2-burner gas cooktop
 Convection microwave
 Stainless steel sink
 Solid-surface kitchen countertop
 Power sofa converts to 68 in. x 76 in. bed
 Shower with magnetic curtain surround
 Aqua View® SHOWERMISER™ water management system
 Toilet with foot flush
 Medicine cabinet with mirror
 Powered roof vent in bathroom
 Seatbelts for driver/passenger seats and select cab locations
 Smoke alarm
 Carbon monoxide detector
 Fire extinguisher

OPTIONS

Starlink satellite internet system with KING Jack™ antenna IPO Winegard Connect 2.0

Li Package

- 48V-165 amp hour smart lithium battery providing 7.9KW hours of power
- IPO 2,800W generator (2) 12V AGM house batteries
- Auto engine start with high idle
- 3,000W inverter IPO 1,000W inverter
- 2nd 48V alternator dedicated to lithium battery
- Timberline hydronic heating system IPO Truma Combi Eco Plus water heater and furnace
- 48V Coleman®-Mach® 10 13.5K BTU air conditioner IPO 120V Coleman®-Mach® 10 13.5K BTU air conditioner
- 1-burner induction cooktop IPO 2-burner gas cooktop
- No propane - all-electric coach



At Entegra Coach, we build our RVs to handle every adventure, then back them with an outstanding warranty. Our 2-year limited warranty has you covered for 2 camping seasons. That's 730 days. For a copy of our 2-year limited warranty with complete terms and conditions, please contact your local Entegra Coach dealer.

It is important for your safety and enjoyment that you are aware of the weights and tow ratings of the RV you select. Consult a competent advisor for questions or advice. Whether you are new to RVing or a veteran, get a feel for the performance of your RV before heading out on the roadways. When you tow a vehicle with your RV, you must drive differently than when you drive a single vehicle. Practice hooking up, driving, backing up and braking in a safe environment or seek out professional instruction. Jayco affixes a weight label to each RV which lists weight information for that vehicle. Refer to that label to verify the vehicle will meet your requirements. Gross Vehicle Weight Rating (GVWR): The maximum permissible weight of the motorhome, including the Unloaded Vehicle Weight (UVW) plus passengers, personal items, all cargo, fluids, options and dealer-installed accessories. The GVWR is equal to or greater than the sum of the UVW and the Cargo Carrying Capacity. Gross Combined Weight Rating (GCWR): The maximum allowable combined weight of the motorhome used as a tow vehicle and the attached towed vehicle.

Floorplan	GVWR (lbs.)	GCWR (lbs.)	Wheel Base	Overall Length	Exterior Height w/ A/C & Satellite	Exterior Width	Interior Height	Fresh Water Capacity (gal.)	Grey Waste Water Capacity (gal.)	Black Waste Water Capacity (gal.)
21B	11,000	13,000	148	22'	10'	86"	78"	24	14	16

LAMESA REC VAN

LAMESA RV.com
 800-496-8778

ENTEGR A COACH

Part of Jayco Family of Companies

Entegra Coach, Inc., P.O. Box 460, Middlebury, IN 46540, www.entegracoach.com. See dealer for further information and prices. All information in this brochure is the latest available at the time of publication approval. Entegra Coach reserves the right to make changes and to discontinue models without notice or obligation. Photos in this brochure may show optional equipment and props for photography purposes. RVs built for sale in Canada may differ to conform to Canadian codes. ©2025 Entegra Coach, Inc. Printed in U.S.A. 2032934

Facebook Instagram YouTube
 entegracoach.com/expand

LEGACY ISN'T LEFT,
 IT'S LIVED.