



AN201325

Ethos



Serial #: 1JSPEBBJ2R1RD8122
 Model: 20D ETHOS MHB
 VIN#: 3C6MRVUG7PE574048
 Model Year: 2024 Dealer Name: LA MESA RV CENTER

401 CORDERO MESA DRIVE NW
 ALBUQUERQUE, NM 87120
 USA

Manufacturer's Suggested Retail Price \$190,650.00

TOTAL AMOUNT DOES NOT INCLUDE STATE AND LOCAL TAXES OR LICENSE FEES. THE PRICE SHOWN ABOVE MAY OR MAY NOT BE REPRESENTATIVE OF THE ACTUAL SELLING PRICE OF SIMILAR RECREATIONAL VEHICLES IN YOUR AREA.

Standard Equipment

Optional Equipment

THE FOLLOWING ITEMS ARE STANDARD ON THIS MODEL AT NO EXTRA CHARGE

OPTIONAL EQUIPMENT INSTALLED ON THIS VEHICLE BY MANUFACTURER

- STANDARD EXTERIOR EQUIPMENT**
- RAM® ProMaster 3500 window van
 - GVWR- 9,350 lb.
 - GCWR- 11,500 lb.
 - 3.6L V6 24V VVT 276HP engine with 250 ft.-lb. torque
 - 9-speed automatic 948TE transmission
 - 180-amp alternator
 - LT225/75R 16E tires
 - Aluminum wheels
 - 3,500 lb. rear hitch receiver with dual 4/7 pin connector
 - 12V chassis battery
 - 24 gal. fuel tank (gas)
 - LED-lit running boards for cab and entry doors
 - Chrome grille package
 - Daytime running headlamps
 - Cable TV hookup with RG-6 coax
 - Onan® 2,800W generator with auto-gen start
 - 200W roof-mounted GoPower® solar panel with integrated control panel
 - Portable solar plug
 - 1,000W inverter
 - (2) 12V AGM house batteries
 - House battery disconnect switch
 - 30-amp electrical service with detachable power cord
 - (2) 120V exterior outlets
 - 6 gal. propane tank (20 lb.)
 - LP quick-connect hookup
 - Heated holding tanks (12V pads)
 - LED-lit holding tank valves
 - Black tank flush
 - Gravity water fill (20T)
 - Winterization drain system
 - 12V demand water pump
 - Water filtration system
 - Outside shower

- STANDARD INTERIOR EQUIPMENT**
- Uconnect® 5 NAV infotainment center with Apple CarPlay® and Android Auto™
 - Leather-wrapped steering wheel with integrated controls
 - Power folding/heated side-view mirrors
 - ParkView® rear backup camera with dynamic gridlines
 - Rain-sensitive windshield wipers
 - Automatic high-beam headlights
 - Cruise control
 - Driver and passenger airbags
 - Power windows and door locks
 - Privacy shades for cab windows
 - Remote keyless entry
 - Custom-molded ABS interior wall panels
 - Soft-touch vinyl ceiling
 - High-intensity LED ceiling lights
 - Tecnoform® European-style, high-gloss cabinetry
 - Ball-bearing drawer guides
 - Residential vinyl flooring
 - Firefly Multiplex system - wall-mounted touchscreen and mobile app for total coach control
 - 120V Coleman®-Mach® 10 13,500 BTU air conditioner
 - Powered roof vent in living area
 - Sliding screen door for entrance door
 - Sliding vented windows
 - Decorative window valances with day/night roller shades
 - Rear magnetic privacy shades
 - Removable privacy shade for sliding door window
 - Expandable table at entry door with safety grab handle (20T)
 - Adjustable table with multiple mounts
 - (2) cab bucket seats (20A, 20D)
 - Seatbelts for driver/passenger seats and select cab locations
 - 32 in. front TV on drop-down bracket (20A, 20D)
 - 24 in. living area TV on swivel bracket (20T)
 - JBL® Flip 6 removable wireless Bluetooth speaker
 - Smoke alarm
 - Carbon monoxide detector
 - Fire extinguisher
 - 5.3 cu.ft. DC refrigerator (20A, 20D)
 - 3.1 cu.ft. AC/DC refrigerator (20T)
 - Convection microwave
 - 2-burner gas cooktop (20A, 20T)
 - 1-burner induction cooktop (20D)
 - Stainless-steel sink with cover
 - Solid-surface kitchen countertop with pull-out extension
 - Pop-up 120V/USB outlet in kitchen
 - (2) twin-size beds with filler cushion converts to king-size bed (20T)
 - Under-bed storage (20T)
 - 48 in. x 76 in. convertible sofa bed (20A, 20D)
 - 50.5 in. x 79.5 in. pop-top (20D)
 - Bathroom wardrobe
 - Shower with magnetic curtain surround
 - Aqua View® SHOWERMISER™ water management system
 - Toilet with foot flush
 - Medicine cabinet with mirror
 - Powered roof vent in bathroom (20A, 20T)

- CUSTOMER VALUE PACKAGE**
- E-Z Drive™: Hellwig helper springs, premium heavy-duty suspension
 - Thule® armless patio awning with LED light strip
 - Thule® roof rack (20A, 20T)
 - Truma Combi Eco Plus water heater and furnace
 - Swivel driver and passenger seats with 6-way lumbar adjustment
 - Winegard® Connect 2.0 4G/Wi-Fi/digital TV antenna

Base price 179,400.00
 AUTUMN n/c
 USA STANDARDS n/c
 CUSTOMER VALUE PACKAGE 11,250.00

UNIT TOTAL **190,650.00**

DEALER INSTALLED OPTIONS

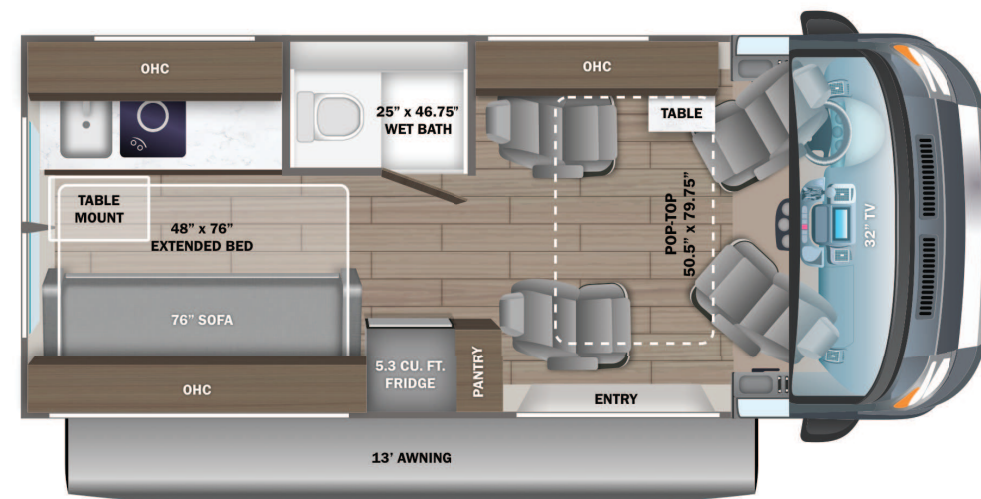

DIMENSIONS

Exterior height:.....111.00"
 Exterior width:.....83.00"

CAPACITIES

Fresh water tank (gals.):...25.00
 Gray water tank (gals.):...33.00
 Black water/toilet tank (gals.):.....12.00
 Propane (lbs.):.....0
 Propane (gals.):.....0
 Water heater (gals.):.....0.00

TIRES

Tire size (front):.....LT225/75R16E
 Tire size (mid):.....
 Tire size (rear):.....LT225/75R16E

Some dimensions may be rounded and may vary from the actual dimensions
 Weights may be estimated calculations and may vary from the actual weight - refer to the vehicle weight labels for actual weights
 Floorplans, features and specifications are subject to change without notice.