



AN212993

Qwest SE



Serial #: 1JSLECBL6S1YL8086
 Model: 24L QWEST SE MHC
 VIN#: W1X8N33Y8PN249800
 Model Year: 2025 Dealer Name: LA MESA RV CENTER

401 CORDERO MESA DRIVE NW
 ALBUQUERQUE, NM 87120
 USA

Manufacturer's Suggested Retail Price

\$201,361.00

TOTAL AMOUNT DOES NOT INCLUDE STATE AND LOCAL TAXES OR LICENSE FEES. THE PRICE SHOWN ABOVE MAY OR MAY NOT BE REPRESENTATIVE OF THE ACTUAL SELLING PRICE OF SIMILAR RECREATIONAL VEHICLES IN YOUR AREA.

Standard Equipment

THE FOLLOWING ITEMS ARE STANDARD ON THIS MODEL

STANDARD EXTERIOR EQUIPMENT

- Mercedes-Benz® 3500 chassis with 170 in. wheelbase
- GVWR- 11,030 lb.
- GCWR- 15,250 lb.
- 2.0 L inline 4-cylinder Twin Turbo 211HP diesel engine with electronic fuel injection with 332 ft.-lb. torque
- 9-speed automatic transmission
- 220-amp alternator
- E-rated highway tires- 215/85R16
- Front and rear disc, 4-wheel anti-lock brakes
- 5,000 lb. rear hitch receiver with dual connector 7-pin plug
- 12V chassis battery
- 26.4 gal. fuel tank
- 5.8 gal. DEF tank
- TuffShell™ vacuum-bond laminated roof, floor and sidewalls
- Bead-foam insulation (R-24 max roof, R-9 max floor, R-5 max walls)
- Tufflex™ PVC laminated roof
- Fiberglass running boards
- Fiberglass exterior walls with vinyl graphics
- Electric stabilizer jacks
- Slideout awning(s)
- Entrance door with industry's largest travel-view window
- Electric-powered entrance step with integrated house battery compartment
- Third brake light
- Prep for satellite dish
- Cable TV hookup with RG-6 coax
- Digital antenna with signal booster
- 3,600W LP generator (4,000W on select models)
- Solar prep
- 12V house battery
- Transfer switch with reverse polarity protection
- 30-amp electrical service
- 12.2 gal. propane tank (41 lb.)
- LP quick-connect hookup
- Exterior utility center
- Winterization drain system
- Black tank flush
- Outside shower
- 12V demand water pump
- Water filtration system

STANDARD INTERIOR EQUIPMENT

- Tilt steering wheel
- Power windows and door locks
- Cruise control
- Crosswind assist
- Hill start assist
- Attention assist
- Brake Assist Plus
- Breakdown management
- Emergency call system
- Headlight assistant
- Auxiliary start switch
- Driver and passenger airbags
- Privacy curtain for cab area
- Overhead bunk with 750 lb. capacity
- 83 in. interior ceiling height with padded vinyl ceiling
- High-intensity, LED ceiling lights
- LED-lit slideout fascia
- Hardwood cabinet doors and drawer fronts
- Ball-bearing drawer guides
- Pleated blackout shades
- 13,500 BTU A/C
- 30,000 BTU auto-ignition ducted furnace
- 6 gal. gas/electric water heater and water heater bypass
- Powered roof vent in living area with wall switch
- Entegra-exclusive, easy-operation legless dinette table (24R)
- U-shaped dinette with stow away pedestal legs (24L)
- 12V USB charging station in dinette area
- 2-point lap safety belts in all designated seating locations
- Car seat tethers (select floorplans)
- LED HD Smart TV
- JBL® audio system
- 10 cu. ft. 12V refrigerator
- 2-burner, drop-in cooktop with flush cover
- Convection microwave
- Stainless steel sink with wooden cover/cutting board
- LED-lit pressed countertops
- Flip-up countertop extension (select models)
- Decorative kitchen backsplash
- Shower with decorative surround and skylight
- Stainless steel bathroom sink
- Toilet with foot flush
- Powered roof vent in bathroom with wall switch
- Queen-size bed with bedspread (24L)
- Queen-size power Murphy bed (24R)
- USB port(s) in bedroom
- Bedroom TV prep
- Large wardrobes
- Smoke alarm
- Carbon monoxide detector
- Fire extinguisher

CUSTOMER VALUE PACKAGE

- One-piece, seamless, fiberglass front cap
- Frameless windows
- Heated holding tanks (12V pads)
- Heated, remote-controlled, side-view mirrors
- Electric patio awning with LED lights
- Backup and side-view cameras
- Keyless cab entry
- 7 in. integrated Mercedes-Benz® MBUX infotainment center with Apple® CarPlay™ and Android Auto™
- Swivel driver and passenger seats

Optional Equipment

OPTIONAL EQUIPMENT INSTALLED ON THIS VEHICLE BY MANUFACTURER

Base price	164,093.00
ASHBROOK DECOR	n/c
WHITE ICE GRAPHICS PACKAGE	n/c
USA STANDARDS	n/c
PREMIUM CHASSIS UPCHARGE	12,000.00
CUSTOMER VALUE PACKAGE	7,050.00
HYDRAULIC AUTO LEVELING JACKS	4,493.00
NO SOLAR PANEL	n/c
STANDARD HOUSE BATTERY	n/c
CABOVER BUNK	n/c
DINETTE	n/c
INS SPECIAL VALLEY PAINT	13,725.00

UNIT TOTAL **201,361.00**

DEALER INSTALLED OPTIONS

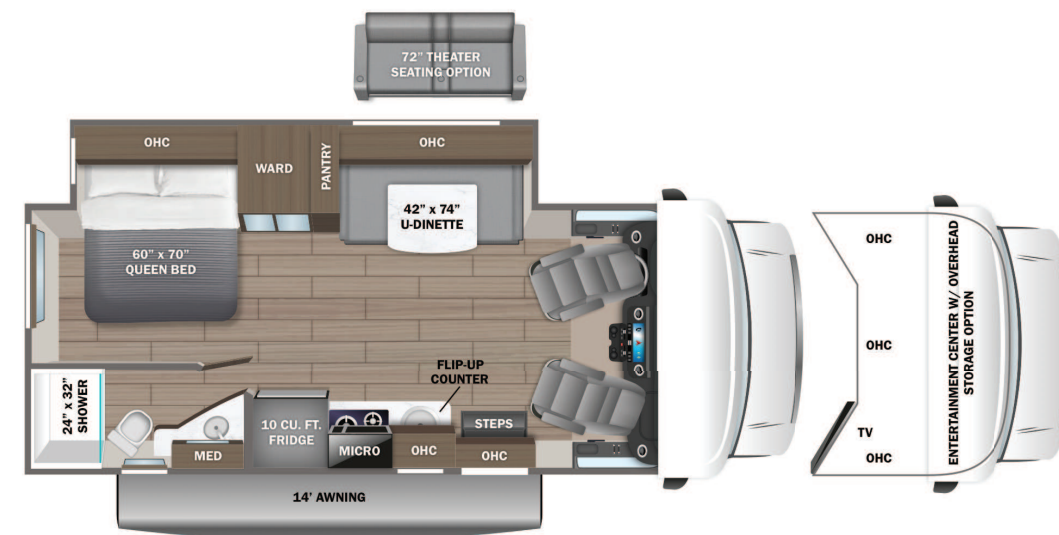

DIMENSIONS

Exterior height:.....137.00"
 Exterior width:.....96.00"

CAPACITIES

Fresh water tank (gals.):...43.00
 Gray water tank (gals.):...31.00
 Black water/toilet tank (gals.):.....31.00
 Propane (lbs.):.....41
 Propane (gals.):.....9
 Water heater (gals.):.....6.00

TIRES

Tire size (front):.....LT215/85R16
 Tire size (mid):.....
 Tire size (rear):.....LT215/85R16

Some dimensions may be rounded and may vary from the actual dimensions
 Weights may be estimated calculations and may vary from the actual weight - refer to the vehicle weight labels for actual weights
 Floorplans, features and specifications are subject to change without notice.