

DN210169



Seneca



Serial #: 1UJNJCUB1S1HM4081  
Model: 37M SENECA MHC  
VIN#: 4UZADVFC3SCWB2631  
Model Year: 2025 Dealer Name: LA MESA RV CENTER, INC.  
1060 RIVERSIDE PARKWAY  
WEST SACRAMENTO, CA 95605  
USA

Manufacturer's Suggested Retail Price \$387,016.00

TOTAL AMOUNT DOES NOT INCLUDE STATE AND LOCAL TAXES OR LICENSE FEES. THE PRICE SHOWN ABOVE MAY OR MAY NOT BE REPRESENTATIVE OF THE ACTUAL SELLING PRICE OF SIMILAR RECREATIONAL VEHICLES IN YOUR AREA.

## Standard Equipment

THE FOLLOWING ITEMS ARE STANDARD ON THIS MODEL

### STANDARD EXTERIOR EQUIPMENT

- Freightliner® S2RV Plus chassis
- GVWR- 31,000 lb.
- GVWR- 43,000 lb.
- Cummins® ISB 6.7L 360 HP diesel engine with 800 ft.-lb. torque
- Allison® 3000 MH automatic transmission
- 185-amp alternator
- G-rated highway tires- 275/80R22.5
- Alcoa® aluminum wheels
- Engine exhaust brake
- 12,000 lb. rear hitch receiver
- 7-pin plug
- Dual 12V chassis batteries
- 100 gal. fuel tank
- 10 gal. DEF tank
- Stronghold/BL™ roof, floor and sidewalls
- Bead-foam insulation (R-24 max roof, R-9 max floor and R-8 max walls)
- One-piece, seamless, crowned fiberglass roof
- Premium Sikkens full-body paint
- Automatic hydraulic leveling jacks
- Entrance door with industry's largest travel-view window
- Electric-powered entrance step
- Slideout awning(s)
- Exterior entertainment center with outside speakers and LED HD Smart TV mounted on swivel bracket
- Winegard® In-motion satellite dish
- Carpeted, full pass-through storage compartments with keyed Aiko lockable alarm-latch doors
- Theford® Sani-Con Turbo macerator system
- Third brake light
- Cable TV hookup with RG-6 coax and video selector switch
- Winegard 2.0 Wi-Fi/4G antenna
- Onan® 8,000W Quiet Diesel generator and auto-gen start
- 200W solar panel with dual controller
- (4) 6V AGM (220Ah) house batteries on slideout tray
- Transfer switch with reverse polarity protection
- 24.5 gal. propane tank (83 lb.)
- LP quick-connect hookup
- Exterior utility center
- Ventilation drain system
- Black tank flush
- Outside shower
- 12V demand water pump
- Water filtration system

### CUSTOMER VALUE PACKAGE

- Jride® Premium Computer-balanced driveshaft, rear air suspension, heavy-duty mar stabilizer bar, full air brakes, SACHS shocks
- One-piece, seamless, fiberglass front and rear caps
- Automotive-branded, panoramic window in front cap with power shade
- Lippert™ 4000 series dual-pane frameless bonded windows
- (2) 15,000 BTU A/C units with heat pump on main A/C
- Electric patio awning with LED lights
- 2,000W pure sine wave inverter
- Power cord reel with 50-amp service
- Sony® infotainment center with tilts/wivel, Apple® CarPlay and Android Auto™
- Backup and side-view cameras
- Residential refrigerator
- Convection microwave oven

## Optional Equipment

OPTIONAL EQUIPMENT INSTALLED ON THIS VEHICLE BY MANUFACTURER

Base price	361,800.00
FARMHOUSE DECOR	443.00
CLARINGTON PAINT PACKAGE	30.00
USA STANDARDS	n/c
25 FR S2RV CALI EMIS	n/c
31000 279 360 SA14	n/c
CHASSIS UPCHARGE	17,993.00
CUSTOMER VALUE PACKAGE	6,750.00
RESIDENTIAL REFRIGERATOR	n/c
NO WASHER/DRYER	n/c
IN MOTION DISH SATELLITE SYSTEM	n/c
WINEGARD 2.0 CONNECT	n/c
NON-BLACKOUT	n/c
BOOTH DINETTE	n/c
POWER THEATER SEATING SOFA	n/c

UNIT TOTAL

387,016.00

DEALER INSTALLED OPTIONS

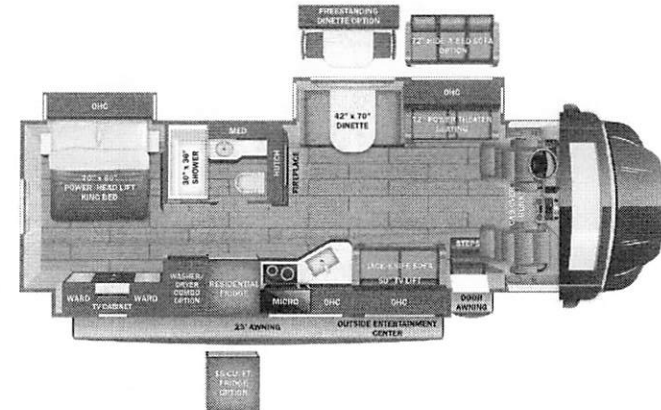

### DIMENSIONS

Exterior height:.....160.00"  
Exterior width:.....101.00"

### CAPACITIES

Fresh water tank (gals.):...72.00  
Gray water tank (gals.):...81.00  
Black water/toilet tank (gals.):...50.00  
Propane (lbs.):.....83  
Propane (gals.):.....19  
Water heater (gals.):.....10.00

### TIRES

Tire size (front):.....275/80R22.5G  
Tire size (mid):.....  
Tire size (rear):.....275/80R22.5G

\*\*\*Some dimensions may be rounded and may vary from the actual dimensions\*\*\*

\*\*\*Weights may be estimated calculations and may vary from the actual weight

- refer to the vehicle weight labels for actual weights\*\*\*

Floorplans, features and specifications are subject to change without notice.

**2+3**  
YEAR | YEAR  
WARRANTY