



Swift



Serial #: 1UJPBBJ4S1RT4169  
 Model: 20T SWIFT MHB  
 VIN#: 3C6MRVUG7RE152199  
 Model Year: 2025 Dealer Name: LA MESA RV CENTER, INC.  
 1060 RIVERSIDE PARKWAY  
 WEST SACRAMENTO, CA 95605  
 USA

## Standard Equipment

## THE FOLLOWING ITEMS ARE STANDARD ON THIS MODEL

## STANDARD EXTERIOR EQUIPMENT

- RAM® ProMaster 3500 window van
- GVWR- 9,350 lb.
- 3.6L V6 24V VVT 276HP engine with 250 ft.-lb. torque
- 9-speed automatic 948TE transmission
- LT225/75R 16E tires
- Aluminum wheels
- 3,500 lb. rear hitch receiver with dual 4/7 pin connector
- 12V chassis battery
- 21 gal. fuel tank (gas)
- LED-lit running boards for cab and entry doors
- Chrome grille package
- Cable TV hookup with RG-6 coax
- Onan® 2,800W generator with auto-gen start
- Portable solar plug
- (2) 12V AGM house batteries
- House battery disconnect switch
- 30-amp electrical service with detachable power cord
- (2) 120V exterior outlets
- 6 gal. propane tank (20 lb.)
- LP quick-connect hookup
- Heated holding tanks (12V pads)
- LED-lit holding tank valves
- Black tank flush
- Gravity water fill (20T)
- Winterization drain system
- 12V demand water pump
- Water filtration system
- Outside shower

## CUSTOMER VALUE PACKAGE

- J-Ride® Hellwig helper springs, premium heavy-duty suspension
- Thule® patio awning with LED light strip
- Truma Combi Eco Plus water heater and furnace
- Swivel driver and passenger seats with 6-way lumbar adjustment
- 1,000W inverter
- Aqua View® SHOWERMISER™ water management system

## STANDARD INTERIOR EQUIPMENT

- Uconnect® 5 NAV infotainment center with Apple CarPlay® and Android Auto™
- Power folding/heated side-view mirrors
- Push-button start
- ParkView® rear backup camera with dynamic gridlines
- Blind spot monitoring with rear cross path detection
- LaneSense® lane departure warning with lane keep assist
- Forward collision warning with active braking
- Crosswind assist
- Electronic stability control
- Pedestrian/cyclist emergency braking
- Traffic sign information
- Drowsy driver detection
- Rain-sensitive windshield wipers
- Automatic high-beam headlights
- Cruise control
- Driver and passenger airbags
- Wireless charging pad
- Power windows and door locks
- Privacy shades for cab windows
- Remote keyless entry
- Custom-molded ABS interior wall panels
- Soft-touch vinyl ceiling
- High-intensity LED ceiling lights
- Tecnoform® European-style, high-gloss cabinetry
- Ball-bearing drawer guides
- Residential vinyl flooring
- Firefly Multiplex system - wall-mounted touchscreen for total coach control
- 120V Coleman®-Mach® 10 13,500 BTU air conditioner
- Powered roof vent in living area
- Zip-up screen for entrance door
- Removable privacy shade for sliding door window
- Sliding vented windows
- Decorative window valances with day/night roller shades
- Zip-up screen for rear doors (20A)
- Rear magnetic privacy shades
- Adjustable table with multiple mounts
- (2) cab bucket seats (20A)
- 5.3 cu.ft. DC refrigerator (20A)
- 3.1 cu.ft. DC refrigerator (20T)
- 3 cu.ft. DC refrigerator (20E, 20Y)
- Convection microwave
- 2-burner gas cooktop (1-burner induction with pop-top option)
- Stainless-steel sink with cover
- Pressed countertops
- Pop-up 120V/USB outlet in kitchen
- (2) twin-size beds with filler cushion converts to king-size bed (20T)
- Under-bed storage (20T)
- 48 in. x 76 in. convertible sofa bed (20A)
- 59 in. x 73 in. Murphy bed (20E)
- Under floor storage with pull-out trays (20E)
- 59 in. x 73 in. lift bed with floor storage (20Y)
- Bathroom wardrobe with drawers (20T)
- Shower with magnetic curtain surround
- Toilet with foot flush
- Medicine cabinet with mirror
- Powered roof vent in bathroom (N/A with pop-top option)
- Seatbelts for driver/passenger seats and select cab locations
- Driver and passenger airbags
- Smoke alarm
- Carbon monoxide detector
- Fire extinguisher

## Optional Equipment

## OPTIONAL EQUIPMENT INSTALLED ON THIS VEHICLE BY MANUFACTURER

Base price	171,300.00
USA STANDARDS	n/c
CUSTOMER VALUE PACKAGE	11,250.00
NO WINEGARD 2.0 CONNECT & TV	n/c
NO THULE ROOF RACK & LADDER	n/c

## Manufacturer's Suggested Retail Price \$182,550.00

TOTAL AMOUNT DOES NOT INCLUDE STATE AND LOCAL TAXES OR LICENSE FEES. THE PRICE SHOWN ABOVE MAY OR MAY NOT BE REPRESENTATIVE OF THE ACTUAL SELLING PRICE OF SIMILAR RECREATIONAL VEHICLES IN YOUR AREA.

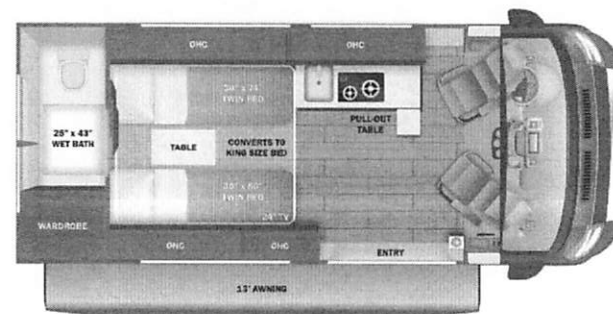

## DIMENSIONS

Exterior height:.....111.00"  
 Exterior width:.....83.00"

## CAPACITIES

Fresh water tank (gals.):...24.00  
 Gray water tank (gals.):...13.00  
 Black water/toilet tank (gals.):...12.00  
 Propane (lbs.):...20  
 Propane (gals.):...4  
 Water heater (gals.):...0.00

## TIRES

Tire size (front):.....LT225/75R16E  
 Tire size (mid):.....  
 Tire size (rear):.....LT225/75R16E

UNIT TOTAL 182,550.00

DEALER INSTALLED OPTIONS

\*\*\*Some dimensions may be rounded and may vary from the actual dimensions\*\*\*

\*\*\*Weights may be estimated calculations and may vary from the actual weight - refer to the vehicle weight labels for actual weights\*\*\*

Floorplans, features and specifications are subject to change without notice.

**2+3**  
 YEAR | YEAR  
 LIMITED | STRUCTURAL  
 WARRANTY