

DN213339



Greyhawk



Serial #: 1UJLJCBR1S1MZ4230
 Model: 30Z GREYHAWK MHC
 VIN#: 1FDXE4FN0SDD39195
 Model Year: 2025 Dealer Name: LA MESA RV CENTER, INC.
 1060 RIVERSIDE PARKWAY
 WEST SACRAMENTO, CA 95605
 USA

Standard Equipment

THE FOLLOWING ITEMS ARE STANDARD ON THIS MODEL

STANDARD EXTERIOR EQUIPMENT

- Ford® E-450 chassis
- GVWR- 14,500 lb.
- GCWR- 22,000 lb.
- 7.3L V48 325 HP engine with 450 ft.-lb. torque
- 6-speed TorqShift® series transmission with overdrive
- 210-amp alternator
- Catalytic converter theft deterrent
- E-rated highway tires- LT225/75R16
- Tire pressure monitoring system (TPMS)
- Power anti-lock brakes with power steering
- 7,500 lb. hitch with 750 lb. tongue capacity and 7-pin plug
- 12V chassis battery
- 55 gal. fuel tank
- Stronghold/VBL™ roof, floor and sidewalls
- Bead-foam insulation (R-24 max roof, R-9 max floor, R-5 max walls)
- One-piece, seamless, fiberglass front cap
- Automotive-bonded, panoramic window in front cap with power shade
- One-piece, seamless, crowned fiberglass roof
- Fiberglass running boards and transition wings
- Fiberglass exterior walls with vinyl graphics
- Remote keyless cab entry
- Entrance door with industry's largest travel-view window
- Electric-powered entrance step with integrated house battery compartment
- (2) high-output, marine-grade exterior speakers
- Slideout awning(s)
- Lockable storage compartments with slam latches
- Third brake light
- Roof ladder (27U, 29MV, 31F)
- Prep for satellite dish
- Cable TV hookup with RG-6 coax
- Winegard 2.0 Wi-Fi/4G antenna
- 4,000W generator with auto-gen start
- 200W solar panel with dual controller with second house battery
- 12V house battery
- Transfer switch with reverse polarity protection
- 30-amp electrical service
- 16.5 gal. propane tank (56 lb.)
- LP quick-connect hookup
- Heated holding tanks (12V pads)
- Exterior utility center
- Winterization drain system
- Black tank flush
- Outside shower
- 12V demand water pump
- Water filtration system

CUSTOMER VALUE PACKAGE

- J Ride® Plus: Computer-balanced driveshaft, Konig® FSD shocks, heavy-duty rear stabilizer bar, standard front stabilizer bar, Hellwig® helper springs, rubber isolation mounts
- Automatic hydraulic leveling jacks
- Frameless windows
- Electric patio awning with LED lights
- 15,000 BTU A/C with heat pump
- 1,000W inverter
- Sony® infotainment center with tilt/swivel, Apple® CarPlay and Android Auto™
- Backup and side-view cameras
- LED HD Smart TV in living area

Optional Equipment

OPTIONAL EQUIPMENT INSTALLED ON THIS VEHICLE BY MANUFACTURER

Base price	175,643.00
FARMHOUSE DECOR	443.00
MIDNIGHT PAINT PACKAGE	12,743.00
USA STANDARDS	n/c
25 FD E45 14500 158"	
7.3L WHITE SC10	n/c
CUSTOMER VALUE PACKAGE	9,000.00
BEDROOM TV	383.00
DUAL 13.5K ACS W/O HEAT PUMP	1,193.00
BLACKOUT APPEARANCE	4,193.00
STANDARD HOUSE BATTERY	n/c
THEATER SEATING SOFA	743.00

Manufacturer's Suggested Retail Price \$204,341.00

TOTAL AMOUNT DOES NOT INCLUDE STATE AND LOCAL TAXES OR LICENSE FEES. THE PRICE SHOWN ABOVE MAY OR MAY NOT BE REPRESENTATIVE OF THE ACTUAL SELLING PRICE OF SIMILAR RECREATIONAL VEHICLES IN YOUR AREA.

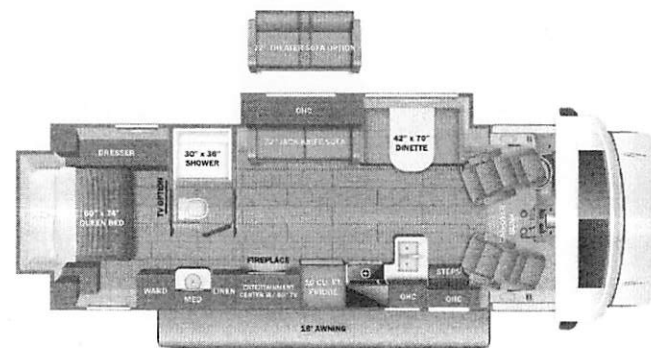

DIMENSIONS

Exterior height:.....140.00"
 Exterior width:.....100.00"

CAPACITIES

Fresh water tank (gals.):...43.50
 Gray water tank (gals.):...41.00
 Black water/toilet tank (gals.):...31.00
 Propane (lbs.):...36
 Propane (gals.):...13
 Water heater (gals.):...6.00

TIRES

Tire size (front):.....LT225/75R16E
 Tire size (mid):.....
 Tire size (rear):.....LT225/75R16E

UNIT TOTAL 204,341.00

DEALER INSTALLED OPTIONS

Some dimensions may be rounded and may vary from the actual dimensions

***Weights may be estimated calculations and may vary from the actual weight

- refer to the vehicle weight labels for actual weights***

Floorplans, features and specifications are subject to change without notice.

2+3
 YEAR | YEAR
 LIMITED WARRANTY