



Ethos



Serial #: 1JSPEBBJ6T1RT8247
 Model: 20T ETHOS MHB
 VIN#: 3C6MRVJG8SE569518
 Model Year: 2026 Dealer Name: LA MESA RV CENTER, INC.
 1060 RIVERSIDE PARKWAY
 WEST SACRAMENTO, CA 95605
 USA

Manufacturer's Suggested Retail Price

\$184,605.00

TOTAL AMOUNT DOES NOT INCLUDE STATE AND LOCAL TAXES OR LICENSE FEES. THE PRICE SHOWN ABOVE MAY OR MAY NOT BE REPRESENTATIVE OF THE ACTUAL SELLING PRICE OF SIMILAR RECREATIONAL VEHICLES IN YOUR AREA.

Standard Equipment

Optional Equipment

THE FOLLOWING ITEMS ARE STANDARD ON THIS MODEL

OPTIONAL EQUIPMENT INSTALLED ON THIS VEHICLE BY MANUFACTURER

- STANDARD EXTERIOR EQUIPMENT**
- RAM® ProMaster 3500
 - GVWR- 9,350 lb.
 - GCWR- 12,900 lb.
 - 3.6L V6 24V VVT 276HP engine with 250 ft.-lb. torque
 - 9-speed automatic 948TE transmission
 - 3,500 lb. rear hitch receiver with dual 4/7 pin connector
 - 12V chassis battery
 - 24 gal. fuel tank (gas)
 - 2,800W gas generator with auto-gen start
 - (2) 12V AGM house batteries
 - 30-amp electrical service with detachable power cord
 - Water filtration system
- CUSTOMER VALUE PACKAGE**
- E-Z Drive™ Hellwig helper springs, premium heavy-duty suspension
 - Thule® patio awning with LED light strip
 - Truma Combi G Comfort Plus water heater and furnace
 - Swivel driver and passenger seats with 6-way lumbar adjustment
 - 2,000W inverter
 - Aqua View® SHOWERMISER™ water management system

- STANDARD INTERIOR EQUIPMENT**
- Uconnect® 5 NAV infotainment center with Apple CarPlay® and Android Auto™
 - Power folding/heated side-view mirrors
 - Push-button start
 - ParkView® rear backup camera with dynamic gridlines
 - Blind spot monitoring with rear cross path detection
 - LaneSense® lane departure warning with lane keep assist
 - Forward collision warning with active braking
 - Crosswind assist
 - Electronic stability control
 - Pedestrian/cyclist emergency braking
 - Traffic sign information
 - Drowsy driver detection
 - Rain-sensitive windshield wipers
 - Automatic high-beam headlights
 - Cruise control
 - Driver and passenger airbags
 - Power windows and door locks
 - Privacy shades for cab windows
 - Remote keyless entry
 - Custom-molded ABS interior wall panels
 - Soft-touch vinyl ceiling
 - High-intensity LED ceiling lights
 - Ball-bearing drawer guides
 - Residential vinyl flooring
 - Firefly Multiplex system - wall-mounted touchscreen for total coach control
 - 120V Coleman®-Mach® 10 13,500 BTU air conditioner
 - Powered roof vent in living area
 - Zip-up screen for entrance door
 - Removable privacy shade for sliding door window
 - Sliding vented windows
 - Decorative window valances with day/night roller shades
 - Zip-up screen for rear doors (20A)
 - Rear magnetic privacy shades
 - Adjustable table with multiple mounts
 - (2) cab bucket seats (20A)
 - Seatbelts for driver/passenger seats and select cab locations
 - 5.3 cu.ft. DC refrigerator (20A)
 - 3.1 cu.ft. DC refrigerator (20T)
 - 3 cu.ft. DC refrigerator (20E)
 - Convection microwave
 - Stainless-steel sink
 - Pressed countertops
 - Pop-up 120V/USB outlet in kitchen
 - (2) twin-size beds with filler cushion converts to king-size bed (20T)
 - Under-bed storage (20T)
 - 48 in. x 76 in. convertible sofa bed (20A)
 - 59 in. x 73 in. Murphy bed (20E)
 - Under floor storage with pull-out trays (20E)
 - Bathroom wardrobe with drawers (20T)
 - Shower with magnetic curtain surround
 - Toilet with foot flush
 - Powered roof vent in bathroom (N/A with pop-top option)
 - Smoke alarm
 - Carbon monoxide detector
 - Fire extinguisher

- Base price 172,800.00
- CARIBOU DECOR n/c
- USA STANDARDS n/c
- TRADESMAN CARGO n/c
- SILVER CHASSIS EXTERIOR 30.00
- CUSTOMER VALUE PACKAGE 11,250.00
- NO WINEGARD 2.0 CONNECT & TV n/c
- 200W SOLAR 525.00
- NO THULE ROOF RACK & LADDER n/c

UNIT TOTAL **184,605.00**

DEALER INSTALLED OPTIONS

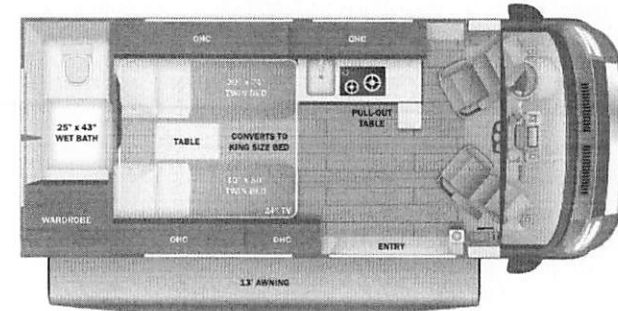

DIMENSIONS

Exterior height:.....111.00"
 Exterior width:.....83.00"

CAPACITIES

Fresh water tank (gals.):...24.00
 Gray water tank (gals.):...13.00
 Black water/toilet tank (gals.):...12.00
 Propane (lbs.):.....0
 Propane (gals.):.....0
 Water heater (gals.):.....0.00

TIRES

Tire size (front):.....LT225/75R16E
 Tire size (mid):.....
 Tire size (rear):.....LT225/75R16E



Some dimensions may be rounded and may vary from the actual dimensions
 Weights may be estimated calculations and may vary from the actual weight - refer to the vehicle weight labels for actual weights
 Floorplans, features and specifications are subject to change without notice.