



## Esteem XL



Serial #: 1JSLECBS7R12U8075  
Model: 32U ESTEEM XL MHC  
VIN#: 1FDUF5HT0RDA00299  
Model Year: 2024 Dealer Name:

### Standard Equipment

THE FOLLOWING ITEMS ARE STANDARD ON THIS MODEL  
AT NO EXTRA CHARGE

- STANDARD EXTERIOR EQUIPMENT
  - Ford® F550 4X4 chassis
  - GVWR - 19,500 lb.
  - GCWR - 31,500 lb.
  - 6.7L Power Stroke V8 Turbo diesel engine with block heater - 330 HP at 2,200 RPM and 950 ft. lb. torque at 1,800 RPM
  - 10-speed automatic transmission
  - 332-amp alternator
  - Grated tires: 245/70R19.5
  - Steel wheels with matte black liners
  - 12,000 lb. rear hitch receiver
  - 7-pin plug
  - Ford® AdvanceTrac® with RSC® (roll stability control) and trailer sway control
  - Integrated trailer brake controller
  - Single chassis battery (750 CCA 78 AH)
  - Dual fuel tanks (26.5 gal. and 40 gal.)
  - 2 in. rear lift
  - TuffShell™ vacuum-bond laminated roof, floor and sidewalls
  - Bead-foam insulation (R-24 max roof, R-9 max floor, R-5 max walls)
  - One-piece, seamless, fiberglass roof
  - Fiberglass side wings
  - Fiberglass exterior walls with partial paint and vinyl graphics
  - Entrance door with industry's largest travel-view window
  - Electric-powered entrance step with integrated house battery compartment
  - Slideout awning(s)
  - Exterior LED HD Smart TV with (2) high-output, marine-grade exterior speakers
  - Lockable storage compartments with slam latches
  - Third brake light
  - Roof ladder
  - Prep for satellite dish
  - Cable TV hookup with RG-6 coax
  - Winegard 2.0 Wi-Fi4G antenna
  - (2) 6V AGM house batteries
  - Transfer switch with reverse polarity protection
  - 50-amp electrical service
  - 19.5 gal. propane tank (66 lb.)
  - LP quick-connect hookup
  - Heated holding tanks (12V pads)
  - Exterior utility center
  - Winterization drain system
  - Black tank flush
  - Outside shower
  - 12V demand water pump
  - Water filtration system

- CUSTOMER VALUE PACKAGE
  - E-Z Drive™ Elite: Computer-balanced driveshaft, heavy-duty rear stabilizer bar, standard front stabilizer bar, Hellwig® helper springs, rubber isolation mounts
  - One-piece, seamless fiberglass front cap
  - Automotive-bonded panoramic window in front cap with power shade
  - Automatic hydraulic leveling jacks
  - Frameless windows
  - Electric patio awning with LED lights
  - 6,000W generator with auto-gen start
  - 2,000W inverter
  - 15,000 BTU A/C with heat pump
  - 200W solar panel with dual controller and second house battery
  - Firefly Multiplex system - wall-mounted touchscreen and mobile app for total coach control
  - LED HD Smart TV in living area

### Optional Equipment

OPTIONAL EQUIPMENT INSTALLED ON THIS VEHICLE  
BY MANUFACTURER

Base price	256,800.00
STILLWATER	n/c
ABLAZE SILVER PARTIAL PAINT	n/c
USA STANDARDS	n/c
24 FD F550 19500 DRW	
205" 6.7L DIESEL WHITE	
RD06	n/c
CHASSIS STANDARD - F550	n/c
CUSTOMER VALUE PACKAGE	25,493.00
BEDROOM TV	413.00
DUAL ACS	1,193.00
15 CU. FT. 12V REFRIGERATOR	743.00
ALUMINUM RIMS	2,993.00
FOLDING WINDSHIELD SUN SHADE	488.00
THEATER SEATING SOFA	2,093.00

UNIT TOTAL 290,216.00

DEALER INSTALLED OPTIONS

## Manufacturer's Suggested Retail Price \$290,216.00

TOTAL AMOUNT DOES NOT INCLUDE STATE AND LOCAL TAXES OR LICENSE FEES. THE PRICE SHOWN ABOVE MAY OR MAY NOT BE REPRESENTATIVE OF THE ACTUAL SELLING PRICE OF SIMILAR RECREATIONAL VEHICLES IN YOUR AREA.

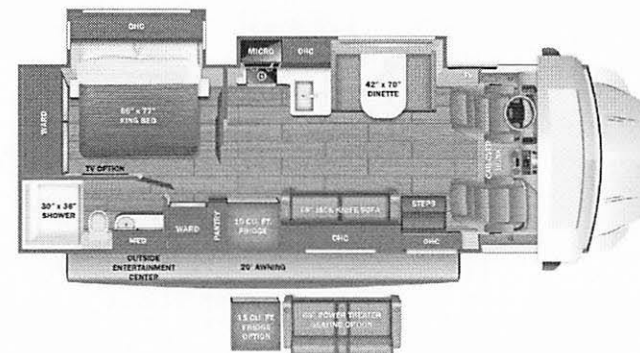

### DIMENSIONS

Exterior height: 144.00"  
Exterior width: 101.00"

### CAPACITIES

Fresh water tank (gals.): 42.50  
Gray water tank (gals.): 31.00  
Black water/toilet tank (gals.): 31.00  
Propane (lbs.): 83  
Propane (gals.): 19  
Water heater (gals.): 10.00

### TIRES

Tire size (front): 225/70R19.5G  
Tire size (mid):  
Tire size (rear): 225/70R19.5G

\*\*\*Some dimensions may be rounded and may vary from the actual dimensions\*\*\*

\*\*\*Weights may be estimated calculations and may vary from the actual weight  
- refer to the vehicle weight labels for actual weights\*\*\*

Floorplans, features and specifications are subject to change without notice.

**This is provided as an information resource only.  
Previous owner(s) may have removed, altered or  
changed equipment after the unit was originally delivered.**