



Alante



Serial #: 1UJMJABN0P1AU4102  
Model: 27A ALANTE MHA  
VIN#: 1F65F5DN6N0A12168  
Model Year: 2023 Dealer Name:

Standard Equipment

Optional Equipment

THE FOLLOWING ITEMS ARE STANDARD ON THIS MODEL  
AT NO EXTRA CHARGE

OPTIONAL EQUIPMENT INSTALLED ON THIS VEHICLE  
BY MANUFACTURER

STANDARD EXTERIOR EQUIPMENT

- Ford® F53 chassis
- GVWR- 18,000 lb.
- GCWR- 23,000 lb.
- 7.3L V-8 350 HP engine with 468 ft.-lb. torque
- 6-speed automatic TorqShift® transmission with overdrive and tow haul mode
- 210 amp alternator
- G-rated highway tires-245/70R19.5
- Front and rear disc, 4-wheel anti-lock brakes
- 5,000 lb. rear hitch receiver with dual connector and 7-pin plug
- 12V chassis battery
- 80 gal. fuel tank
- StrongholdVBL™ roof, floor and sidewalls
- Bead-foam insulation (R-24 max roof, R-9 max floor, R-5 max walls)
- One-piece, seamless, fiberglass front cap
- Fiberglass exterior walls with vinyl graphics
- Automatic hydraulic leveling jacks
- Frameless windows
- Entrance door with industry's largest travel-view window
- Electric-powered entrance step
- Lockable, pass-through storage compartments with slam latches
- Heated holding tanks (12V pads)
- 16.5 gal. propane tank (56 lb.)
- LP quick-connect hookup
- Exterior utility center
- Winterization drain system
- Outside shower
- 12V demand water pump
- Onan® Marquis Gold Genset 4,000W generator
- Transfer switch with reverse polarity protection
- 30 amp electrical service
- (2) 12V house batteries
- 190W solar panel with dual controller and second house battery
- Third brake light
- 4 in. bumper tube with sewer hose storage

CUSTOMER VALUE PACKAGE

- JRIDE®: Computer-balanced driveshaft, Bilstein® steering stabilizer, jounce bumpers, heavy-duty front and rear stabilizer bars, SACHS shocks
- One-piece, seamless, crowned fiberglass roof
- Exterior entertainment center with outside speakers, LED HD Smart TV mounted on swivel bracket and single-disc DVD/FM radio
- Electric patio awning with LED lights
- Slideout awning(s)
- 1,000W inverter
- Sony® infotainment center with Apple® CarPlay™ and Android Auto™
- Backup and side-view cameras
- Removable driver/passenger cockpit table
- LED HD Smart TV in living area
- Blackout night roller shades

STANDARD INTERIOR EQUIPMENT

- 120 in. panoramic windshield
- Swivel driver and passenger seats
- 6-way power driver seat
- Soft-touch, vinyl-wrapped automotive dash
- Tilt steering wheel
- A/C and cruise control
- Power front privacy shade with manual side privacy shades
- 84 in. interior ceiling height
- High-intensity recessed LED ceiling lights
- LED-lit hardwood fascia
- Hardwood cabinet doors and drawers
- Ball-bearing drawer guides
- Jayco-exclusive, easy-operation legless dinette table
- 2-point lap safety belts in all designated seating locations
- Dual A/C units with power management system
- 30,000 BTU auto-ignition ducted furnace
- 6 gal. gas/electric DSI auto-ignition water heater
- Prep for satellite dish
- Cable TV hookup with RG-6 coax and video selector switch
- Winegard 2.0 Wi-Fi/4G antenna
- 8 cu. ft., flush-mount, double-door refrigerator
- Furrion® all-in-one cooktop and oven
- Residential-size microwave
- Large stainless steel kitchen sink with cover
- LED-lit pressed countertops
- Flip-up countertop extension (select models)
- Decorative kitchen backsplash
- Pop-up charging station in kitchen with 110V outlets and USB ports
- Water filtration system
- Shower with decorative surround, glass door, skylight and light
- Stainless steel bathroom sink
- Porcelain toilet with foot flush
- Powered roof vent in bathroom with wall switch
- Walk-around, queen-size bed with bedspread and nightstands (king size in 27A)
- USB port and wireless charging in nightstands
- Under-bed storage (select models)
- Large wardrobes
- Bunks with industry-exclusive 300 lb. capacity each (29F)
- Wall-mounted tablet holder in each bunk (29F)
- Smoke alarm
- Carbon monoxide detector

Base price	167,168.00
Brighton	n/c
USA Standards	n/c
Customer Value Package	9,923.00
Bedroom TV	383.00
12 Cu. Ft. Refrigerator	2,843.00
Standard House Battery	n/c
Front Overhead Bunk	2,993.00

UNIT TOTAL 183,310.00

DEALER INSTALLED OPTIONS

This is provided as an information resource only.  
Previous owner(s) may have removed, altered or  
changed equipment after the unit was originally delivered.

Manufacturer's Suggested Retail Price \$183,310.00

TOTAL AMOUNT DOES NOT INCLUDE STATE AND LOCAL TAXES OR LICENSE FEES. THE PRICE SHOWN ABOVE MAY OR MAY NOT  
BE REPRESENTATIVE OF THE ACTUAL SELLING PRICE OF SIMILAR RECREATIONAL VEHICLES IN YOUR AREA.

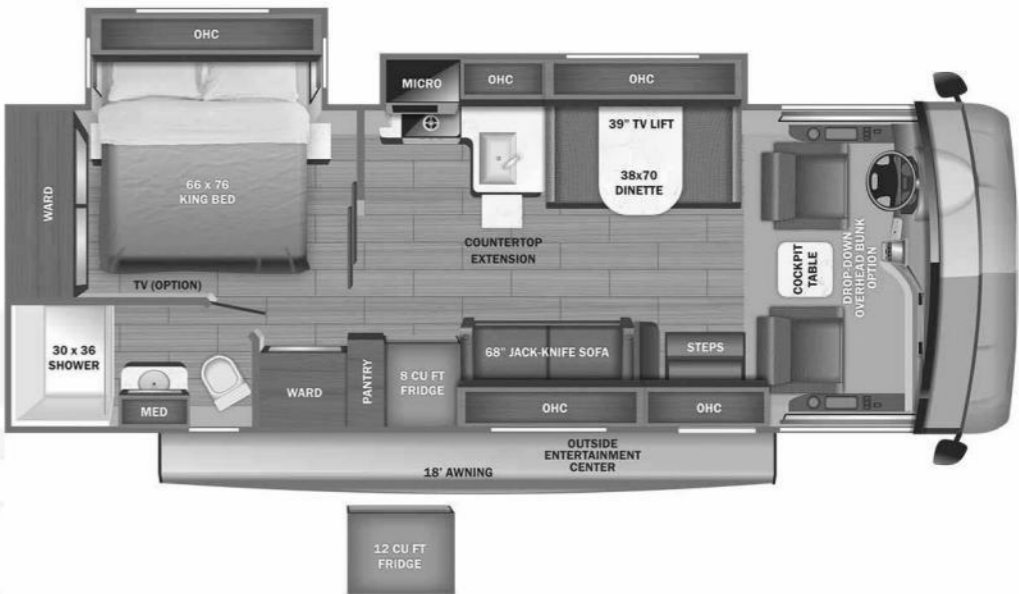

DIMENSIONS

Exterior height:.....149.00"  
Exterior width:.....101.00"

CAPACITIES

Fresh water tank (gals.):...72.00  
Gray water tank (gals.):...50.00  
Black water/toilet tank (gals.):.....49.00  
Propane (lbs.):.....56  
Propane (gals.):.....13  
Water heater (gals.):.....0.00

TIRES

Tire size (front):.....245/70R19.5G  
Tire size (mid):.....  
Tire size (rear):.....245/70R19.5G

\*\*\*Some dimensions may be rounded and may vary from the actual dimensions\*\*\*  
\*\*\*Weights may be estimated calculations and may vary from the actual weight  
- refer to the vehicle weight labels for actual weights\*\*\*  
Floorplans, features and specifications are subject to change without notice.

