



# Vision



Serial #: 1JSMEABR7P1AF8066  
 Model: 29F VISION MHA  
 VIN#: 1F65F5DN3N0A07347  
 Model Year: 2023 Dealer Name:

**Manufacturer's Suggested Retail Price \$190,210.00**

TOTAL AMOUNT DOES NOT INCLUDE STATE AND LOCAL TAXES OR LICENSE FEES. THE PRICE SHOWN ABOVE MAY OR MAY NOT BE REPRESENTATIVE OF THE ACTUAL SELLING PRICE OF SIMILAR RECREATIONAL VEHICLES IN YOUR AREA.

## Standard Equipment

## Optional Equipment

THE FOLLOWING ITEMS ARE STANDARD ON THIS MODEL AT NO EXTRA CHARGE

OPTIONAL EQUIPMENT INSTALLED ON THIS VEHICLE BY MANUFACTURER

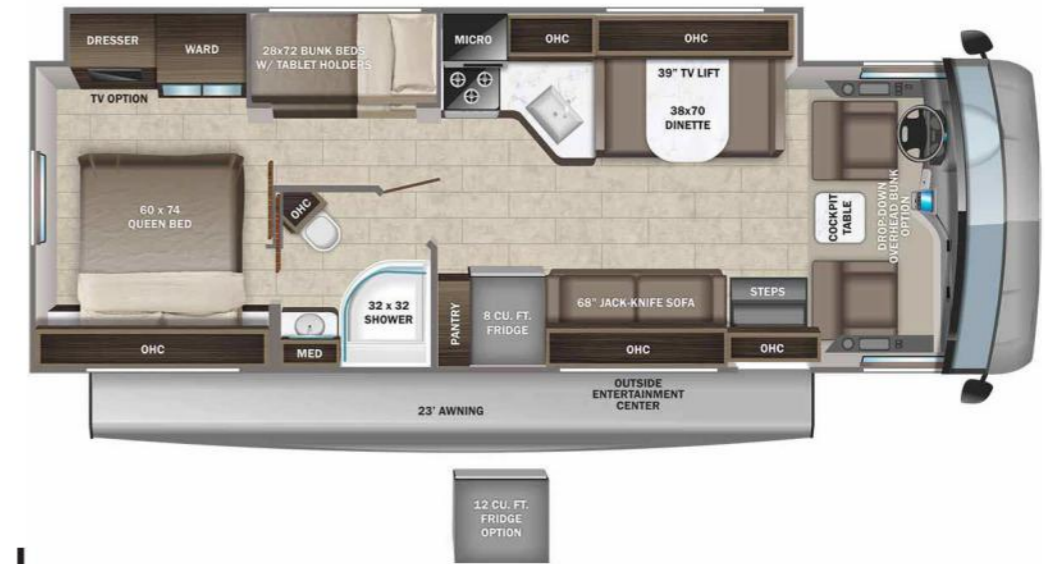

- STANDARD EXTERIOR EQUIPMENT**
- Ford® F53 chassis
  - GVWR - 18,000 lb.
  - GCWR - 23,000 lb.
  - 7.3L V-8 350 HP engine with 468 ft.-lb. torque
  - 6-speed automatic TorqShift® transmission with overdrive and tow haul mode
  - 210 amp alternator
  - G-rated highway tires-245/70R19.5
  - Front and rear disc, 4-wheel anti-lock brakes
  - 5,000 lb. rear hitch receiver with dual connector and 7-pin plug
  - 12V chassis battery
  - 80 gal. fuel tank
  - Onan® Marquis Gold GenSet 5,500W generator (4,000W on 26X)
  - Transfer switch with reverse polarity protection
  - 50 amp electrical service (30 amp on 26X)
  - (2) 12V house batteries
  - 190W solar panel with dual controller
  - Heated holding tanks (12V pads)
  - 15,000 BTU A/C unit with heat pump and second 13,500 BTU A/C unit
  - Auto-ignition ducted furnace - 30,000 BTU
  - 6 gal. gas/electric DSI auto-ignition water heater
  - 16.5 gal. propane tank (56 lb.)
  - LP quick-connect hookup
  - Exterior utility center
  - Winterization drain system
  - Black tank flush
  - Outside shower
  - 12V demand water pump
  - Water filtration system
  - TuffShell™ vacuum-bond laminated roof, floor and sidewalls
  - Bead-foam insulation (R-24 max roof, R-9 max floor, R-5 max walls)
  - One-piece, seamless fiberglass front cap with partial paint
  - Fiberglass exterior walls with vinyl graphics
  - Automatic hydraulic leveling jacks
  - Frameless windows
  - Entrance door with industry's largest travel-view window
  - Electric-powered entrance step
  - Lockable pass-through storage compartments with slam latches
  - 4 in. tube bumper with sewer hose storage
  - Roof ladder
  - Third brake light

- STANDARD INTERIOR EQUIPMENT**
- Power front privacy shade with manual side privacy shades
  - 120 in. panoramic windshield
  - Swivel driver and passenger seats
  - 6-way power driver seat
  - Soft-touch, vinyl-wrapped automotive dash
  - A/C and cruise control
  - Tilt steering wheel
  - Auxiliary start
  - 84 in. interior ceiling height
  - High-intensity recessed LED ceiling lights
  - LED-lit hardwood fascia
  - Hardwood cabinet doors and drawers
  - Ball-bearing drawer guides
  - Entegra-exclusive, easy-operation legless dinette table
  - Prep for satellite dish
  - Cable TV hookup with RG-6 coax
  - Winegard 2.0 Wi-Fi/4G antenna
  - 8 cu.ft gas/electric refrigerator
  - Furrion® all-in-one cooktop and oven
  - Residential-size microwave
  - Large, recessed, stainless steel kitchen sink with cover
  - LED-lit pressed countertops
  - Flip-up countertop extension (select models)
  - Decorative kitchen backsplash
  - Pop-up charging station in kitchen with 110V outlets and USB ports
  - Shower with decorative surround, glass door, skylight and light
  - Recessed stainless steel bathroom sink
  - Porcelain toilet with foot flush
  - Powered roof vent in bathroom with wall switch
  - Walk-around, queen-size bed with bedspread and nightstands (king size in 27A)
  - USB port and wireless charging in nightstands
  - Under-bed storage (select models)
  - Bedroom TV prep
  - Large wardrobes
  - Bunks with industry-exclusive 300 lb. capacity each (29F)
  - Wall-mounted tablet holder in each bunk (29F)
  - 2-point lap safety belts in all designated seating locations
  - Smoke alarm
  - Carbon monoxide detector

Base price	174,068.00
Brighton	n/c
Pewter Graphics	n/c
USA Standards	n/c
Customer Value Package	9,923.00
Bedroom TV	383.00
12 Cu. Ft. Refrigerator	2,843.00
Front Overhead Bunk	2,993.00

- CUSTOMER VALUE PACKAGE**
- E-Z DRIVE™: Computer-balanced driveshaft, Bilstein® steering stabilizer, jounce bumpers, heavy-duty front and rear stabilizer bars, SACHS shocks
  - One-piece, seamless, crowned fiberglass roof
  - Exterior entertainment center with outside speakers, LED HD Smart TV mounted on swivel bracket and single-disc DVD/FM radio
  - Electric patio awning with LED lights
  - Slideout cover awnings
  - 1,000W inverter
  - Sony® infotainment center with Apple CarPlay® and Android Auto™
  - Backup and side-view cameras
  - Removable driver/passenger cockpit table
  - LED HD Smart TV in living area
  - Blackout night roller shades

UNIT TOTAL **190,210.00**

DEALER INSTALLED OPTIONS

### DIMENSIONS

Exterior height:.....149.00"  
 Exterior width:.....101.00"

### CAPACITIES

Fresh water tank (gals.):...72.00  
 Gray water tank (gals.):....40.00  
 Black water/toilet tank (gals.):.....49.00  
 Propane (lbs.):.....56  
 Propane (gals.):.....13  
 Water heater (gals.):.....0.00

### TIRES

Tire size (front):.....245/70R19.5G  
 Tire size (mid):.....  
 Tire size (rear):.....245/70R19.5G

**This is provided as an information resource only. Previous owner(s) may have removed, altered or changed equipment after the unit was originally delivered.**

\*\*\*Some dimensions may be rounded and may vary from the actual dimensions\*\*\*  
 \*\*\*Weights may be estimated calculations and may vary from the actual weight - refer to the vehicle weight labels for actual weights\*\*\*  
 Floorplans, features and specifications are subject to change without notice.