



INTEGRAL

COACH

Accolade

Serial #: 1J5NECBUXT1HM8106
 Model: 37M ACCOLADE MHC
 VIN#: 4UZADVFC9TCWV8387
 Model Year: 2026 Dealer Name: LA MESA RV CENTER, INC (FLORIDA)
 2650 BRIDGE WAY
 DAVIE, FL 33314
 USA



Standard Equipment

THE FOLLOWING ITEMS ARE STANDARD ON THIS MODEL

- STANDARD EXTERIOR EQUIPMENT**
- Freightliner S2RV Plus chassis
 - GVWR - 31,000 lb.
 - Gross Vehicle Weight (GVW) - 27,500 lbs.
 - Cummins® ISB 6.7L 360 HP diesel engine with 600 ft.-lb. torque
 - Allison® 3000 MH automatic transmission
 - Grated highway tires - 275/80R22.5
 - Alcoa® aluminum rims
 - Engine exhaust brake
 - 7-pin plug (with 1,200 lb. tongue capacity)
 - Dual 12V chassis batteries
 - 100 gal. fuel tank
 - Turbo® vacuum-brake mounted roof, floor and sidewalls
 - Break-down insulation (R-24 max roof, R-9 max interior)
 - One-piece seamless, crowned fiberglass roof
 - Automatic hydraulic leveling jacks
 - Premium Siskens full-body paint
 - Electric power door with industry's largest travel-view window
 - Electric-powered entrance steps
 - Slideout cover awnings
 - Exterior color accents with JLI® outside graphics and LED HD Smart TV mounted on swivel bracket
 - Wipeguard® InMotion satellite dish
 - On-board Altec® noise-dampening components
 - Theford® San-Con Turbo macerator system
 - Third brake light
 - Roof ladder
 - Roof rack
 - Wipeguard 2.0 VHF-FM antenna
 - 8,000W diesel generator with auto-stop start
 - (4) 8V AGM (220Ah) house batteries on slideout tray
 - Transfer switch with reverse polarity protection
 - LP gas-connect center
 - LP gas-connect hook-up
 - Exterior utility center
 - Windreduction drain system
 - Outside shower
 - 12V demand water pump
 - Water filtration system

Optional Equipment

OPTIONAL EQUIPMENT INSTALLED ON THIS VEHICLE BY MANUFACTURER

- STANDARD INTERIOR EQUIPMENT**
- Easy power driver and passenger seats
 - Dual heated, power-tilt, side-view mirrors
 - Power windows, including system (TMS)
 - Tilt steering wheel
 - Cruise control
 - Driver's automatic height-adjustable seat
 - Custom interior upholstery
 - Custom-nubbed ABS surround in cab-over area
 - Overhead bunk with 75 lb. capacity
 - Custom-nubbed interior door locks
 - Axially start switch
 - Custom-nubbed interior door handle
 - Mobile app for total coach control
 - 84 in. interior ceiling height with padded vinyl ceiling
 - High-intensity recessed LED ceiling lights
 - LED-Di® taillights
 - Very park flooring
 - Custom-nubbed interior floor and drawer fronts
 - Soft-close cabinet doors and drawers
 - Deluxe hidden cabinet hinges
 - Back-springing drawer guides
 - Electric refrigerator
 - Energy-efficient, gas-operation legless dinette table
 - Car seat belts (seated floorlans)
 - LED HD Smart TV in living area
 - JEL® audio system
 - 2-burner induction cooktop
 - Multi-function sink with cup washer and wodge tray
 - LED-HD Smart TV in bedroom
 - LED-HD Smart TV in bedroom
 - USB port and wireless charging in nightstands
 - LED-HD Smart TV in bedroom
 - Bunks with industry-exclusive 300 lb. capacity each (37L)
 - Shower with decorative surround, glass door, skylight and light
 - Porcelain toilet with foot flush
 - Recessed stainless-steel bathroom sink
 - Powered roof vent in bathroom with wall switch
 - Carbon monoxide detector
 - Fire extinguisher

OPTIONAL EQUIPMENT INSTALLED ON THIS VEHICLE BY MANUFACTURER	382,800.00
Base price	382,800.00
BROOKSIDE DECOR	n/c
DAYBREAK FULL PAINT	30.00
USA STANDARDS	n/c
26 FR S2RV 31000 279"	n/c
360 TF501	n/c
CUSTOMER VALUE PACKAGE	6,750.00
RESIDENTIAL REFRIGERATOR	n/c
WASHER/DRYER COMBINATOR	1,943.00
IN MOTION DISH SATELLITE SYSTEM	n/c
WINEGARD 2.0 CONNECT	n/c
SLIDEOUT TRAY W/ELECTRIC COOLER IN BASEMENT	1,343.00
NON-BLACKOUT POWER HEATER SEATING SOFA	n/c

UNIT TOTAL

392,866.00

DEALER INSTALLED OPTIONS

914 222 789

Manufacturer's Suggested Retail Price

\$392,866.00

TOTAL AMOUNT DOES NOT INCLUDE STATE AND LOCAL TAXES OR LICENSE FEES. THE PRICE SHOWN ABOVE MAY OR MAY NOT BE REPRESENTATIVE OF THE ACTUAL SELLING PRICE OF SIMILAR RECREATIONAL VEHICLES IN YOUR AREA.

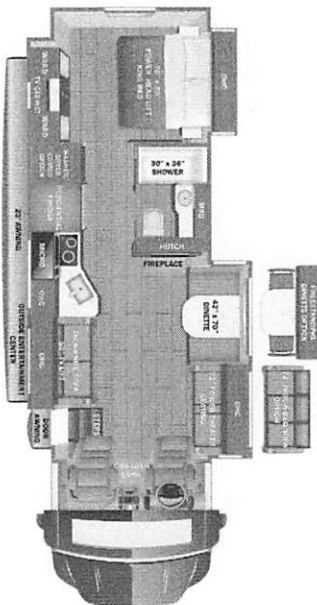

DIMENSIONS

Exterior height:160.00"
 Exterior width:101.00"

CAPACITIES

Fresh water tank (gals.):72.00
 Gray water tank (gals.):81.00
 Black water/toilet tank (gals.):50.00
 Propane (lbs.):83
 Propane (gals.):19
 Water heater (gals.):0.00

TIRES

Tire size (front):275/80R22.5G
 Tire size (mid):
 Tire size (rear):275/80R22.5G

***Some dimensions may be rounded and may vary from the actual dimensions ***
 ***Weights may be estimated calculations and may vary from the actual weight ***
 - refer to the vehicle weight labels for actual weights ***
 Floorplans, features and specifications are subject to change without notice.

