



Esteem XL



ENTEGRACOACH®

Serial #: 1JSLECBS3S12U8063
 Model: 32U ESTEEM XL MHC
 VIN#: 1FDUF5HT7RDA07220
 Model Year: 2025 Dealer Name: LA MESA RV CENTER

9650 KELLY TRACTOR DR
 FT. MYERS, FL 33905
 USA

Standard Equipment

Optional Equipment

THE FOLLOWING ITEMS ARE STANDARD ON THIS MODEL
 AT NO EXTRA CHARGE

OPTIONAL EQUIPMENT INSTALLED ON
 BY MANUFACTURER

STANDARD EXTERIOR EQUIPMENT

- Ford® F550 4X4 chassis (30M, 32U)
- Ford® F600 4X4 chassis (33F)
- GVWR - 19,500 lb. (30M, 32U); 22,000 lb. (33F)
- GCWR - 31,500 lb. (30M, 32U); 34,000 lb. (33F)
- 6.7L Power Stroke V8 Turbo diesel engine with block heater - 330 HP at 2,200 RPM and 950 ft. lb. torque at 1,800 RPM
- 10-speed automatic transmission
- 332-amp alternator
- G-rated tires - 225/70R19.5 (30M, 32U)
- All-terrain tires - 245/70R19.5 (33F)
- Steel wheels with matte black liners
- 12,000 lb. rear hitch receiver
- 7-pin plug
- Hellwig® helper springs (30M, 32U)
- Ford® AdvanceTrac® with RSC® (roll stability control) and trailer sway control
- Integrated trailer brake controller
- Single chassis battery (750 CCA 78 AH)
- Dual fuel tanks (26.5 gal. and 40 gal.)
- 2 in. rear lift
- TuffShell™ vacuum-bond laminated roof, floor and sidewalls
- Bead-foam insulation (R-24 max roof, R-9 max floor, R-5 max walls)
- One-piece, seamless, fiberglass roof
- Fiberglass exterior walls with partial paint and vinyl graphics
- Entrance door with industry's largest travel-view window
- Electric-powered entrance step with integrated house battery compartment
- Slideout awning(s)
- Exterior LED HD Smart TV with (2) high-output, marine-grade exterior speakers
- Lockable storage compartments with slam latches
- Third brake light
- Roof ladder
- Prep for satellite dish
- Cable TV hookup with RG-6 coax
- Winegard 2.0 Wi-Fi/4G antenna
- (2) 6V AGM house batteries
- Transfer switch with reverse polarity protection
- 50-amp electrical service
- Detachable power cord
- 16.5 gal. propane tank (56 lb.)
- LP quick-connect hookup
- Heated holding tanks (12V pads)
- Exterior utility center
- Winterization drain system
- Black tank flush
- Outside shower
- 12V demand water pump
- Water filtration system

CUSTOMER VALUE PACKAGE

- E-Z Drive™ Elite: Computer-balanced driveshaft, heavy-duty rear stabilizer bar, standard front stabilizer bar and Hellwig® helper springs
- One-piece, seamless fiberglass front cap
- Automotive-bonded panoramic window in front cap with power shade
- Automatic hydraulic leveling jacks
- Frameless windows
- Electric patio awning with LED lights
- 6,000W generator with auto-gen start
- 2,000W inverter
- 15,000 BTU A/C with heat pump
- 200W solar panel with dual controller and second house battery
- Firefly Multiplex system - wall-mounted touchscreen and mobile app for total coach control
- LED HD Smart TV in living area

STANDARD INTERIOR EQUIPMENT

- Ford® SYNC® 4 infotainment center with Apple® CarPlay™ and Android Auto™
- Audible lane departure warning
- Pre-Collision Assist® with automatic emergency braking (AEB)
- SOS Post Crash Alert System™
- Driver and passenger airbags
- Safety Canopy® system with roll-fold side-curtain airbags
- Remote keyless entry and perimeter anti-theft alarm
- SecurILock® anti-theft ignition
- Quad dual-beam halogen headlights
- Rainlamp wiper activated headlights
- Remote start
- Adjustable gas/brake pedals
- Cruise control
- Power windows and door locks
- Auxiliary start switch
- 8-way power driver seat
- Tilt steering wheel
- Custom-molded ABS surround in cab-over area
- Overhead bunk with 750 lb. capacity and safety net
- Privacy curtain for cab area
- 84 in. interior ceiling height with padded vinyl ceiling
- High-intensity recessed LED ceiling lights
- LED-lit fascia
- Hardwood cabinet doors and drawer fronts
- Deluxe hidden cabinet hinges
- Ball-bearing drawer guides
- Blackout night roller shades
- 30,000 BTU auto-ignition furnace
- 10 gal. gas/electric water heater
- JBL® audio system
- U-shaped dinette (30M)
- Entegra-exclusive, easy-operation legless dinette table (32U, 33F)
- 2-point lap safety belts in all designated seating locations
- Car seat tethers (select floorplans)
- 10 cu. ft. 12V refrigerator
- Furrion® all-in-one cooktop and oven
- Residential-size microwave
- Recessed stainless steel kitchen sink with sink covers
- Solid-surface kitchen countertops
- Decorative kitchen backsplash
- Pop-up charging station in kitchen with 120V outlets and USB ports
- Queen-size power Murphy Bed (30M)
- Queen-size bed with bedspread and nightstands (33F)
- Walk-around, king-size bed with bedspread and nightstands (32U)
- USB port and wireless charging in nightstands
- Large wardrobes
- Bunks with industry-exclusive 300 lb. capacity each (33F)
- Wall-mounted tablet holder in each bunk (33F)
- Shower with decorative surround, glass door, skylight and light
- Recessed stainless steel bathroom sink
- Toilet with foot flush
- Powered roof vent in bathroom with wall switch
- Smoke alarm
- Carbon monoxide detector
- Fire extinguisher

- Base price 21
- ABLAZE SILVER PARTIAL PAINT
- STILLWATER DECOR USA STANDARDS
- CHASSIS STANDARD - F550
- CUSTOMER VALUE PACKAGE
- BEDROOM TV
- DUAL ACS
- 15 CU. FT. 12V REFRIGERATOR
- ALUMINUM RIMS
- FOLDING WINDSHIELD SUN SHADE
- THEATER SEATING SOFA

LN 208001

UNIT TOTAL

299,9

DEALER INSTALLED OPTIONS



Esteem XL



Serial #: 1JSLECBS3S12U8063
 Model: 32U ESTEEM XL MHC
 VIN#: 1FDUF5HT7RDA07220
 Model Year: 2025 Dealer Name: LA MESA RV CENTER

9650 KELLY TRACTOR DRIVE
 FT. MYERS, FL 33905
 USA

INTEGRA COACH®

Standard Equipment

Optional Equipment

THE FOLLOWING ITEMS ARE STANDARD ON THIS MODEL AT NO EXTRA CHARGE

OPTIONAL EQUIPMENT INSTALLED ON THIS VEHICLE BY MANUFACTURER

STANDARD INTERIOR EQUIPMENT
 1X4 chassis (30M, 32U)
 1X4 chassis (33F)
 100 lb. (30M, 32U); 22,000 lb. (33F)
 100 lb. (30M, 32U); 34,000 lb. (33F)
 6-cylinder V8 Turbo diesel engine with 130 HP at 2,200 RPM and 950 ft. lb. torque
 6-Speed automatic transmission
 6-Speed manual transmission
 225/70R19.5 (30M, 32U)
 245/70R19.5 (33F)
 with matte black liners
 2-in. hitch receiver
 Coilover springs (30M, 32U)
 eTrac® with RSC® (roll stability control)
 Driver and passenger airbags
 Brake controller
 750 CCA 78 AH battery
 26.5 gal. and 40 gal. tanks
 Vacuum-bond laminated roof, floor and interior walls
 Fiberglass roof
 Interior walls with partial paint and vinyl
 180-degree panoramic view
 Red entrance step with integrated compartment
 12V outlets
 HD Smart TV with (2) high-output, exterior speakers
 Storage compartments with slam latches
 Dish
 6-coax
 Wi-Fi/4G antenna
 House batteries
 Reverse polarity protection
 Service
 Power cord
 56 lb. propane tank
 Propane hookups
 12V pads
 Center
 Drain system
 Shower
 Water pump
 Sewer system
VALUE PACKAGE
 Computer-balanced driveshaft, stabilizer bar, standard front stabilizer
 Helper springs
 Fiberglass front cap
 Ceramic window in front cap
 Hydraulic leveling jacks
 Windows
 Awning with LED lights
 Generator with auto-gen start
 AC
 12V/24V with heat pump
 Panel with dual controller and second
 12V system - wall-mounted
 Mobile app for total coach control
 TV in living area

STANDARD INTERIOR EQUIPMENT
 - Ford® SYNC® 4 infotainment center with Apple® CarPlay™ and Android Auto™
 - Audible lane departure warning
 - Pre-Collision Assist® with automatic emergency braking (AEB)
 - SOS Post Crash Alert System™
 - Driver and passenger airbags
 - Safety Canopy® system with roll-fold side-curtain airbags
 - Remote keyless entry and perimeter anti-theft alarm
 - SecuriLock® anti-theft ignition
 - Quad dual-beam halogen headlights
 - Rainlamp wiper activated headlights
 - Remote start
 - Adjustable gas/brake pedals
 - Cruise control
 - Power windows and door locks
 - Auxiliary start switch
 - 8-way power driver seat
 - Tilt steering wheel
 - Custom-molded ABS surround in cab-over area
 - Overhead bunk with 750 lb. capacity and safety net
 - Privacy curtain for cab area
 - 84 in. interior ceiling height with padded vinyl ceiling
 - High-intensity recessed LED ceiling lights
 - LED-lit fascia
 - Hardwood cabinet doors and drawer fronts
 - Deluxe hidden cabinet hinges
 - Ball-bearing drawer guides
 - Blackout night roller shades
 - 30,000 BTU auto-ignition furnace
 - 10 gal. gas/electric water heater
 - JBL® audio system
 - U-shaped dinette (30M)
 - Entegra-exclusive, easy-operation legless dinette table (32U, 33F)
 - 2-point lap safety belts in all designated seating locations
 - Car seat tethers (select floorplans)
 - 10 cu. ft. 12V refrigerator
 - Furrion® all-in-one cooktop and oven
 - Residential-size microwave
 - Recessed stainless steel kitchen sink with sink covers
 - Solid-surface kitchen countertops
 - Decorative kitchen backsplash
 - Pop-up charging station in kitchen with 120V outlets and USB ports
 - Queen-size power Murphy Bed (30M)
 - Queen-size bed with bedspread and nightstands (33F)
 - Walk-around, king-size bed with bedspread and nightstands (32U)
 - USB port and wireless charging in nightstands
 - Large wardrobes
 - Bunks with industry-exclusive 300 lb. capacity each (33F)
 - Wall-mounted tablet holder in each bunk (33F)
 - Shower with decorative surround, glass door, skylight and light
 - Recessed stainless steel bathroom sink
 - Toilet with foot flush
 - Powered roof vent in bathroom with wall switch
 - Smoke alarm
 - Carbon monoxide detector
 - Fire extinguisher

| | |
|------------------------------|------------|
| Base price | 266,550.00 |
| ABLAZE SILVER PARTIAL PAINT | n/c |
| STILLWATER DECOR | n/c |
| USA STANDARDS | n/c |
| CHASSIS STANDARD - F550 | n/c |
| CUSTOMER VALUE PACKAGE | 25,493.00 |
| BEDROOM TV | 413.00 |
| DUAL ACS | 1,193.00 |
| 15 CU. FT. 12V REFRIGERATOR | 743.00 |
| ALUMINUM RIMS | 2,993.00 |
| FOLDING WINDSHIELD SUN SHADE | 488.00 |
| THEATER SEATING SOFA | 2,093.00 |

UNIT TOTAL

299,966.00

DEALER INSTALLED OPTIONS



Manufacturer's Suggested Retail Price \$299,966.00

TOTAL AMOUNT DOES NOT INCLUDE STATE AND LOCAL TAXES OR LICENSE FEES. THE PRICE SHOWN ABOVE MAY OR MAY NOT BE REPRESENTATIVE OF THE ACTUAL SELLING PRICE OF SIMILAR RECREATIONAL VEHICLES IN YOUR AREA.

R
DRIVE
5

ment

ED ON THIS VEHICLE
RER

266,550.00

n/c
n/c
n/c

25,493.00

413.00

1,193.00

743.00

2,993.00

488.00

2,093.00

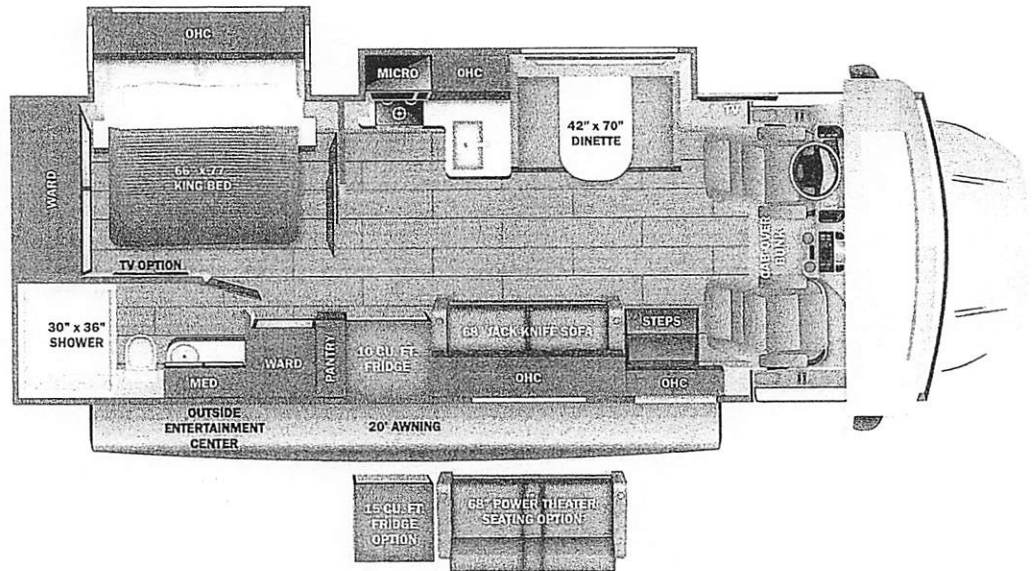

DIMENSIONS

Exterior height:.....150.00"
Exterior width:.....101.00"

CAPACITIES

Fresh water tank (gals.):...42.50
Gray water tank (gals.):...31.00
Black water/toilet tank (gals):.....31.00
Propane (lbs.):.....83
Propane (gals.):.....19
Water heater (gals.):.....10.00

TIRES

Tire size (front):.....225/70R19.5G
Tire size (mid):.....
Tire size (rear):.....225/70R19.5G

299,966.00

PTIONS

Some dimensions may be rounded and may vary from the actual dimensions

***Weights may be estimated calculations and may vary from the actual weight

- refer to the vehicle weight labels for actual weights***

Floorplans, features and specifications are subject to change without notice.