



Odyssey SE



Serial #: 1JSLECBL8S1G28222
 Model: 22CF ODYSSEY SE MHC
 VIN#: 1FDWE3FN2SDD32173
 Model Year: 2025 Dealer Name: LA MESA RV CENTER
 9650 KELLY TRACTOR DR
 FT. MYERS, FL 33905
 USA

Standard Equipment

Optional Equipmen

THE FOLLOWING ITEMS ARE STANDARD ON THIS MODEL

OPTIONAL EQUIPMENT INSTALLED ON BY MANUFACTURER

STANDARD EXTERIOR EQUIPMENT

- Ford® E-350 chassis
- GVWR - 12,500 lb.
- GCWR - 18,500 lb.
- 7.3L V-8 325 HP engine with 450 ft.-lb. torque
- 6-speed TorqShift® series transmission with overdrive
- 210-amp alternator
- 5,000 lb. hitch with 500 lb. tongue capacity and 7-pin plug
- 55 gal. fuel tank
- Catalytic converter theft deterrent
- E-rated highway tires- LT225/75R16
- Tire pressure monitoring system (TPMS)
- 12V chassis battery
- Power anti-lock brakes with power steering
- TuffShell™ vacuum-bond laminated roof, floor and sidewalls
- Bead-foam insulation (R-24 max roof, R-9 max floor, R-5 max walls)
- Tufflex™ PVC laminated roof
- Aluminum running boards
- Fiberglass exterior walls with vinyl graphics
- Entrance door with industry's largest travel-view window
- Electric-powered entrance step with integrated house battery compartment
- Third brake light
- 4 in. bumper tube sewer hose storage
- Cable TV hookup with RG-6 coax
- Digital antenna with signal booster
- 4,000W generator
- Solar prep
- 12V house battery
- Transfer switch with reverse polarity protection
- 30-amp electrical service
- 12.2 gal. propane tank (41 lb.)
- LP quick-connect hookup
- Exterior utility center
- Winterization drain system
- Outside shower
- 12V demand water pump
- Water filtration system

STANDARD INTERIOR EQUIPMENT

- Remote-controlled, side-view mirrors
- Hill start assist
- Tilt steering wheel
- Cruise control
- Electronic stability control
- Traction control
- Power windows and door locks
- Auxiliary start switch
- Driver and passenger airbags
- Overhead bunk with 750 lb. capacity
- 84 in. ceiling height
- High-intensity, recessed LED ceiling lights
- Hardwood cabinet doors
- Ball-bearing drawer guides
- 42 in. x 78 in. U-shaped dinette (22A, 22E)
- Entegra-exclusive, easy-operation legless dinette table (22C)
- 48 in. dinette bench with removable table (22T)
- 2-point lap safety belts in all designated seating locations
- Interior entrance door grab handle
- Interior command center
- Pleated blackout shades
- 13,500 BTU ducted A/C
- 30,000 BTU auto-ignition furnace
- 6 gal. gas/electric DSI auto-ignition water heater
- Smoke alarm
- Carbon monoxide detector
- Fire extinguisher
- 10 cu. ft. 12V refrigerator
- 2-burner cooktop with flush cover
- Convection microwave oven
- Stainless steel kitchen sink
- Decorative kitchen backsplash
- Queen-size bed with bedspread (22A, 22C)
- (2) twin-size beds with filler cushion convert to king-size bed (22T)
- Large wardrobes (select models)
- Shower with decorative ABS surround and skylight
- Stainless steel bathroom sink
- Toilet with foot flush

CUSTOMER VALUE PACKAGE

- One-piece, seamless, fiberglass front cap
- Heated holding tanks (12V pads)
- Electric patio awning
- Black holding tank sprayer
- Backup camera
- LED HD Smart TV

Base price

ASHBROOK DECOR
 USA STANDARDS
 25 FD E35 12500 158"
 7.3L WHITE SC11
 CUSTOMER VALUE PACKAGE
 NO HYDRAULIC AUTO
 LEVELING JACKS
 NO SOLAR PANEL
 STANDARD HOUSE BATTERY

LN 208403

UNIT TOTAL

129

DEALER INSTALLED OPTION



Odyssey SE



Serial #: 1JSLECBL8S1G28222
 Model: 22CF ODYSSEY SE MHC
 VIN#: 1FDWE3FN2SDD32173
 Model Year: 2025 Dealer Name: LA MESA RV CENTER

9650 KELLY TRACTOR DRIVE
 FT. MYERS, FL 33905
 USA

ENTEGR A
 COACH®

Standard Equipment

Optional Equipment

THE FOLLOWING ITEMS ARE STANDARD ON THIS MODEL

OPTIONAL EQUIPMENT INSTALLED ON THIS VEHICLE BY MANUFACTURER

EXTERIOR EQUIPMENT

0 chassis
 500 lb.
 500 lb.
 5 HP engine with 450 ft.-lb. torque
 iShift® series transmission with
 Terminator
 ch with 500 lb. tongue capacity and
 tank
 nverter theft deterrent
 way tires- LT225/75R16
 e monitoring system (TPMS)
 i battery
 ock brakes with power steering
 vacuum-bond laminated roof, floor and

insulation (R-24 max roof, R-9 max
 walls)
 /C laminated roof
 nning boards
 xterior walls with vinyl graphics
 or with industry's largest travel-view

erred entrance step with integrated
 compartment
 light
 r tube sewer hose storage
 okup with RG-6 coax
 ina with signal booster
 erator

attery
 ch with reverse polarity protection
 trical service
 pane tank (41 lb.)
 nnect hookup
 y center
 i drain system
 wer
 i water pump
 on system

/ALUE PACKAGE
 eamless, fiberglass front cap
 ing tanks (12V pads)
 awning
 g tank sprayer
 era
 art TV

STANDARD INTERIOR EQUIPMENT

- Remote-controlled, side-view mirrors
- Hill start assist
- Tilt steering wheel
- Cruise control
- Electronic stability control
- Traction control
- Power windows and door locks
- Auxiliary start switch
- Driver and passenger airbags
- Overhead bunk with 750 lb. capacity
- 84 in. ceiling height
- High-intensity, recessed LED ceiling lights
- Hardwood cabinet doors
- Ball-bearing drawer guides
- 42 in. x 78 in. U-shaped dinette (22A, 22E)
- Entegra-exclusive, easy-operation legless dinette table (22C)
- 48 in. dinette bench with removable table (22T)
- 2-point lap safety belts in all designated seating locations
- Interior entrance door grab handle
- Interior command center
- Pleated blackout shades
- 13,500 BTU ducted A/C
- 30,000 BTU auto-ignition furnace
- 6 gal. gas/electric DSI auto-ignition water heater
- Smoke alarm
- Carbon monoxide detector
- Fire extinguisher
- 10 cu. ft. 12V refrigerator
- 2-burner cooktop with flush cover
- Convection microwave oven
- Stainless steel kitchen sink
- Decorative kitchen backsplash
- Queen-size bed with bedspread (22A, 22C)
- (2) twin-size beds with filler cushion convert to king-size bed (22T)
- Large wardrobes (select models)
- Shower with decorative ABS surround and skylight
- Stainless steel bathroom sink
- Toilet with foot flush

Base price	123,218.00
ASHBROOK DECOR	n/c
USA STANDARDS	n/c
25 FD E35 12500 158"	
7.3L WHITE SC11	n/c
CUSTOMER VALUE PACKAGE	6,000.00
NO HYDRAULIC AUTO	
LEVELING JACKS	n/c
NO SOLAR PANEL	n/c
STANDARD HOUSE BATTERY	n/c

UNIT TOTAL **129,218.00**

DEALER INSTALLED OPTIONS



Manufacturer's Suggested Retail Price

\$129,218.00

TOTAL AMOUNT DOES NOT INCLUDE STATE AND LOCAL TAXES OR LICENSE FEES. THE PRICE SHOWN ABOVE MAY OR MAY NOT BE REPRESENTATIVE OF THE ACTUAL SELLING PRICE OF SIMILAR RECREATIONAL VEHICLES IN YOUR AREA.

ER
TOR DRIVE
05

oment

ED ON THIS VEHICLE
RER

123,218.00
n/c
n/c
n/c
6,000.00
n/c
n/c
n/c

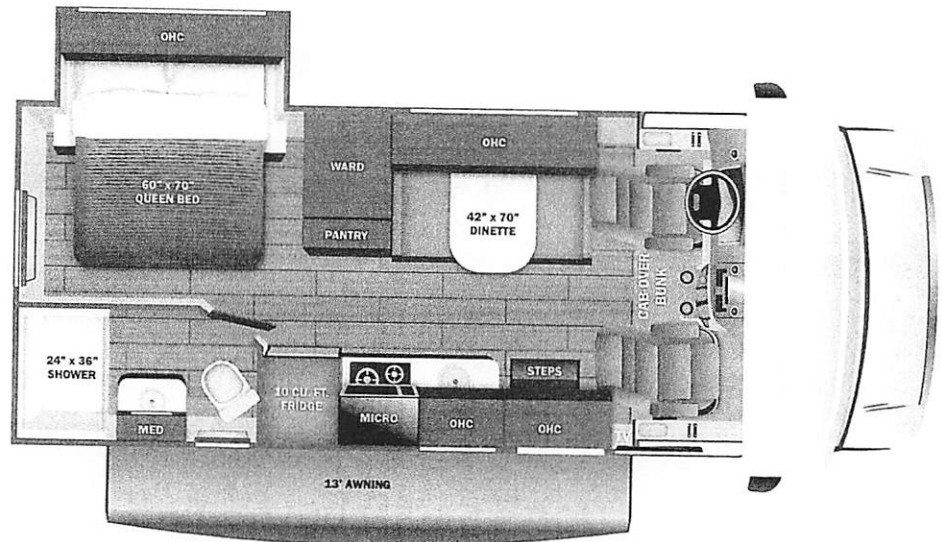

U

DIMENSIONS

Exterior height:.....138.00"
Exterior width:.....100.00"

CAPACITIES

Fresh water tank (gals.):...43.50
Gray water tank (gals.):...40.00
Black water/toilet tank (gals):.....31.00
Propane (lbs.):.....41
Propane (gals.):.....9
Water heater (gals.):.....6.00

TIRES

Tire size (front):.....LT225/75R16E
Tire size (mid):.....
Tire size (rear):.....LT225/75R16E

129,218.00

TIONS

Some dimensions may be rounded and may vary from the actual dimensions
Weights may be estimated calculations and may vary from the actual weight - refer to the vehicle weight labels for actual weights
Floorplans, features and specifications are subject to change without notice.