

LN22945



Centurion



Serial #: 1JSNECBV6T19N8059
 Model: 39N CENTURION MHC
 VIN#: 3ALAHTDV8TSWR0810
 Model Year: 2026 Dealer Name: LA MESA RV CENTER
 9650 KELLY TRACTOR DRIVE
 FT. MYERS, FL 33905
 USA

Manufacturer's Suggested Retail Price

\$676,825.00

TOTAL AMOUNT DOES NOT INCLUDE STATE AND LOCAL TAXES OR LICENSE FEES. THE PRICE SHOWN ABOVE MAY OR MAY NOT BE REPRESENTATIVE OF THE ACTUAL SELLING PRICE OF SIMILAR RECREATIONAL VEHICLES IN YOUR AREA.

Standard Equipment

Optional Equipment

THE FOLLOWING ITEMS ARE STANDARD ON THIS MODEL

OPTIONAL EQUIPMENT INSTALLED ON THIS VEHICLE BY MANUFACTURER

STANDARD EXTERIOR EQUIPMENT
 Freightliner® Cascadia 116 Day Cab
 Detroit® DD13 GEN 5 12.8L 525 HP engine with 1,850 torque at 975 RPM
 12-speed overdrive automated manual transmission
 12V 300 amp alternator
 1,500W engine block heater
 Engine brake with global cruise control
 Detroit® safety assistance package with active break assist 5, adaptive cruise control, active side guard assist and lane departure warning system
 18,000 lb. rating front axle
 23,000 lb. rating rear axle
 All-wheel air disc brakes
 2.85 rear axle ratio
 Michelin® 315/80R 22.5 in. tires (front) and 295/80R 22.5 in. tires (rear)
 Tire pressure monitoring system (TPMS) with sensors
 Equalizer™ EQ Hydraulic Smart Level System
 (3) 12V chassis batteries
 120 gal. fuel tank
 13 gal. DEF tank
 20,000 lb. hitch with 7-pin plug
 8,000W diesel generator with auto-gen start
 Victron 3,000W pure sine wave inverter with LED Screen
 (4) GC2 batteries (6V/224 amp hrs. ea.)
 400W solar panels
 50 amp power cord on electric powered reel
 Automatic transfer switch with surge protection
 (2) 15,000 BTU units with heat pumps
 Aqua-Hot® 2500 hydronic water and heating system with 5 in. LED screen and in-floor heating throughout
 Aqua-Hot® heated basement storage
 Sani-Com® macerator holding tank dump system with manual gate valves and manual backup
 Black tank flush
 City and tank water filtration system
 Hot and cold water hook-up
 Water hose with electric reel
 Sikken's custom full-body paint
 Carefree® slideout awnings
 Frameless, dual-pane, tinted, safety-glass windows
 LED accent lights under all slideout rooms
 Electric-powered entrance step
 Keypad system for keyless entry
 Diamond Shield™ front protective film mask
 LED high and low beam headlights
 LED marker lights, turn lights, license plate light, third brake light, accent lights and docking lights
 Porch light and motion sensor security lights
 Winegard Connect 2.0 Wi-Fi/4G antenna
 Heated exterior utility center with tank monitoring system
 Carpeted, full pass-through storage compartments with lockable slam latch door
 Roof-mounted dual pitch integrated power patio awning with LED lights

STANDARD INTERIOR EQUIPMENT
 360° HD digital camera system
 Powered Front Cap Privacy Shade
 Adjustable air-ride leather driver/passenger seats
 Finity® multiplex system with 10 in. VegaTouch touchscreen for complete integration of coach controls (mobile app available)
 50 in. Smart TV in living room
 Soundbar in living room
 Premium leather furniture
 Hand-laid, porcelain tiled floors
 LED Interior Lighting
 Decorative ceiling feature with integrated accent lighting
 Manual solar day shades and blackout night shades
 Central vacuum system with in-wall dust pan
 Dual-pane, tinted, safety-glass windows
 Solid-surface countertops and dimmable LED accent lighting
 Powdered Flush Stepwell Cover
 Stainless steel residential refrigerator
 Induction cooktop with solid surface covers
 Convection microwave with air fryer function
 Solid-surface countertops and dimmable LED accent lighting
 Hardwood cabinets and styles throughout
 Adjustable shelves
 Stainless steel sink
 Gel memory-foam mattress
 Solid-surface countertops and dimmable LED accent lighting
 Nightstands with solid-surface tops
 Smart TV in bedroom
 Solid-surface countertops with single sink and dimmable LED accent lighting
 Fiberglass pan, solid surface with tile insert
 Teakwood shower seat
 Hand-held spray wand
 Aqua View SHOWERMISER™ water saving system
 Porcelain toilet in main bath
 Macerator toilet in mid bath
 Power exhaust vent fan in bathroom
 Stacked washer and dryer
 Carbon monoxide detector
 Smoke alarm

Base price 671,843.00
 OXFORD DECOR n/c
 STONEWALL GRAY CABINETRY 30.00
 ADJUSTABLE AIR-RIDE LEATHER DRIVER/PASSENGER SEATS n/c
 DOVE WHITE FRONT n/c
 OVERHEAD ACCENT WOOD n/c
 ONYX WHITE POLISHED TILE 1,493.00
 SILVER FOX PAINT 30.00
 USA STANDARDS n/c
 26 FR CASC 41000 310* n/c
 525HP TF124 n/c
 2 DRAWER CABINET ILO n/c
 DISHWASHER n/c
 FREEZER 1,343.00
 SATELLITE PREP ONLY n/c
 STARLINK SATELLITE 743.00
 INTERNET SERVICE n/c
 BOOTH DINETTE n/c
 THEATER SEATING 74* 1,343.00

UNIT TOTAL **676,825.00**

DEALER INSTALLED OPTIONS

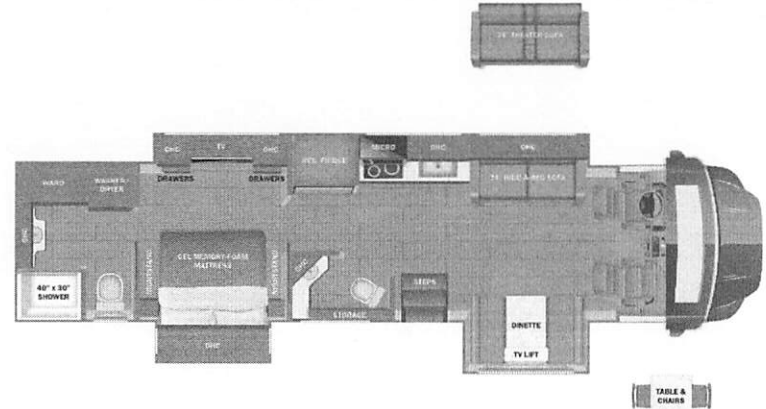

DIMENSIONS

Exterior height:.....155.00"
 Exterior width:.....101.75"

CAPACITIES

Fresh water tank (gals.)...100.00
 Gray water tank (gals.)...62.50
 Black water/toilet tank (gals.).....40.00
 Propane (lbs.).....0
 Propane (gals.).....0
 Water heater (gals.).....0.00

TIRES

Tire size (front):.....315/80R22.5
 Tire size (mid):.....
 Tire size (rear):.....295/80R22.5

Some dimensions may be rounded and may vary from the actual dimensions

Weights may be estimated calculations and may vary from the actual weight - refer to the vehicle weight labels for actual weights

Floorplans, features and specifications are subject to change without notice.

