

Seneca XT



Serial #: 1UJNJCBT8R1JL4063
 Model: 35L SENECA XT MHC
 VIN#: 1FDF6LT6PDA12069
 Model Year: 2024 Dealer Name: LA MESA RV CENTER

8650 NW LTC PARKWAY
 PORT ST. LUCIE, FL 34986
 USA

Standard Equipment

Optional Equipment

THE FOLLOWING ITEMS ARE STANDARD ON THIS MODEL AT NO EXTRA CHARGE

OPTIONAL EQUIPMENT INSTALLED ON BY MANUFACTURER

- STANDARD EXTERIOR EQUIPMENT**
- Ford® F550 4X4 chassis (29T)
 - Ford® F600 4X4 chassis (32U, 35L)
 - GVWR - 19,500 lb. (29T); 22,000 lb. (32U, 35L)
 - GCWR - 31,500 lb. (29T); 34,000 lb. (32U, 35L)
 - 6.7L Power Stroke V8 Turbo diesel engine with block heater - 330 HP at 2,200 RPM and 950 ft. lb. torque at 1,800 RPM
 - 10 speed automatic transmission
 - 332-amp alternator (dual)
 - All-terrain tires - 245/70R19.5
 - HiSpec matte black aluminum rims
 - 2 in. BDS radius arm suspension lift
 - 12,000 lb. rear hitch receiver
 - 7-pin plug
 - Ford® AdvanceTrac® with RSC® (roll stability control) and trailer sway control
 - Integrated trailer brake controller
 - Single chassis battery (750 CCA 78 AH)
 - Dual fuel tanks (26.5 gal. and 40 gal.)
 - StrongholdVBL™ roof, floor and sidewalls
 - Bead-foam insulation (R-24 max roof, R-9 max floor and R-8 max walls)
 - One-piece, seamless, crowned fiberglass roof
 - Premium Sikkens full-body paint
 - Automatic hydraulic leveling jacks
 - Electric-powered entrance steps
 - Slideout cover awnings
 - Exterior entertainment center with outside speakers, LED HD Smart TV and Bluetooth® receiver
 - Winegard® In-motion satellite dish
 - Full pass-through storage compartments with lockable slam latch doors
 - Flush-mount LED marker lights
 - Third brake light
 - Roof ladder
 - KING Jack™ antenna
 - Cable TV hookup with RG-6 coax
 - Onan® 6,000W Quiet Diesel generator and auto-gen start
 - (2) 6V AGM house batteries
 - Transfer switch with reverse polarity protection
 - 50-amp service
 - 24.5 gal. propane tank (83 lb.)
 - LP quick-connect hookup
 - Exterior utility center
 - Winterization drain system
 - Black tank flush
 - Outside shower
 - 12V demand water pump
 - Water filtration system
- CUSTOMER VALUE PACKAGE**
- J-Ride® Premium: Computer-balanced driveshaft, heavy-duty front and rear stabilizer bars, Hellwig® helper springs, Koni® shocks
 - One-piece, seamless, fiberglass front cap with auxiliary flood lights
 - One-piece, seamless, fiberglass rear cap with auxiliary flood lights (32U, 35L)
 - Automotive-bonded, panoramic window in front cap with power shade
 - 15,000 BTU A/C unit with heat pump and second 13,500 BTU A/C unit
 - Electric, wind-sensing, legless patio awning with LED lights
 - 2,000W pure sine wave inverter
 - 200W solar panel with dual controller
 - Starlink satellite internet system
 - Backup and side-view cameras
 - Two-burner induction cooktop
 - 10 cu. ft. 12V refrigerator (29T)
 - 18 cu. ft. residential refrigerator (32U, 35L)
 - Convection microwave oven

- STANDARD INTERIOR EQUIPMENT**
- Ford® SYNC® 4 infotainment center with navigation
 - Audible lane departure warning
 - Pre-Collision Assist® with automatic emergency braking (AEB)
 - SOS Post Crash Alert System™
 - Driver and passenger airbags
 - Safety Canopy® system with roll-fold side-curtain airbags
 - Remote keyless entry and perimeter anti-theft alarm
 - SecuriLock® anti-theft ignition
 - Quad dual-beam halogen headlights
 - Rainlamp wiper activated headlights
 - Remote start
 - Adjustable gas/brake pedals
 - Individual tire pressure monitoring system (TPMS)
 - Cruise control
 - Power windows and door locks
 - Auxiliary start switch
 - 8-way power driver seat
 - Tilt steering wheel
 - Custom-molded ABS surround in cab-over area
 - Overhead bunk with 750 lb. capacity
 - Firefly total coach control system with wall-mounted touchscreen and mobile app
 - 84 in. interior ceiling height with padded vinyl ceiling
 - High-intensity, recessed LED ceiling lights
 - Raised-panel hardwood cabinet doors and drawer fronts
 - Deluxe hidden cabinet hinges
 - Ball-bearing drawer guides
 - 30,000 BTU auto-ignition furnace
 - 10 gal. gas/electric water heater
 - Furrion® electric fireplace (35L)
 - Jayco-exclusive, easy-operation legless dinette table (32U, 35L)
 - 2-point lap safety belts in all designated seating locations
 - Car seat tethers (select floorplans)
 - LED HD Smart TV in living area
 - LED HD Smart TV in bedroom (32U, 35L)
 - LED-lit, solid-surface kitchen countertops with recessed stainless steel sink and sink covers
 - Pull-out countertop extension (select models)
 - Decorative shower surround with glass door, skylight and light
 - Macerating porcelain toilet
 - Powered roof vent in bathroom with wall switch
 - Rear U-shaped power sofa converts to 80 in. x 96 in. bed (29T)
 - Walk-around, king-size bed with bedspread and nightstands (32U, 35L)
 - Under-bed storage (select models)
 - Large wardrobes
 - Smoke alarm
 - Carbon monoxide detector
 - Fire extinguisher

- Base price 328,
- WARM RIVER
- HUNTINGTON CABINETRY
- DESERT STORM PAINT PACKAGE
- USA STANDARDS
- CUSTOMER VALUE PACKAGE 31,
- 15 CU. FT. 12V REFRIGERATOR
- NO WASHER/DRYER
- IN MOTION DISH SATELLITE SYSTEM
- POWER THEATER SEATING SOFA

PN198663

UNIT TOTAL

360,72

DEALER INSTALLED OPTIONS

Seneca XT

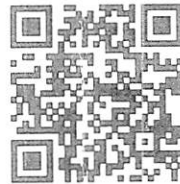

Serial #: 1UJNJCBT8R1JL4063
 Model: 35L SENECA XT MHC
 VIN#: 1FDF6LT6PDA12069
 Model Year: 2024 Dealer Name: LA MESA RV CENTER
 8650 NW LTC PARKWAY
 PORT ST. LUCIE, FL 34986
 USA

Standard Equipment

Optional Equipment

THE FOLLOWING ITEMS ARE STANDARD ON THIS MODEL AT NO EXTRA CHARGE

OPTIONAL EQUIPMENT INSTALLED ON THIS VEHICLE BY MANUFACTURER

EXTERIOR EQUIPMENT

- IX4 chassis (29T)
- IX4 chassis (32U, 35L)
- 600 lb. (29T); 22,000 lb. (32U, 35L)
- 600 lb. (29T); 34,000 lb. (32U, 35L)
- Stroke V8 Turbo diesel engine with 30 HP at 2,200 RPM and 950 ft. lb. RPM
- Automatic transmission
- Generator (dual)
- Generator - 245/70R19.5
- Black aluminum rims
- Stabilizer arm suspension lift
- Receiver hitch
- ProTrac® with RSC® (roll stability)
- Electronic sway control
- Electronic brake controller
- House battery (750 CCA 78 AH)
- Water (26.5 gal. and 40 gal.)
- 3L™ roof, floor and sidewalls
- Insulation (R-24 max roof, R-9 max ax walls)
- Seamless, crowned fiberglass roof
- Exterior full-body paint
- Hydraulic leveling jacks
- Red entrance steps
- Screened awnings
- Entertainment center with outside speakers, TV and Bluetooth® receiver
- Non-motion satellite dish
- High storage compartments with latching doors
- LED marker lights
- Light
- Antenna
- Backup with RG-6 coax
- Quiet Diesel generator and
- House batteries
- Charging with reverse polarity protection
- Propane
- Propane tank (83 lb.)
- Propane neck hookup
- Propane center
- Drain system
- Shower
- Water pump
- Propane system
- ALUE PACKAGE
- Propane: Computer-balanced driveshaft, front and rear stabilizer bars, Hellwig® Koni® shocks
- Seamless, fiberglass front cap with lights
- Seamless, fiberglass rear cap with lights (32U, 35L)
- Sealed, panoramic window in front cap
- Propane
- A/C unit with heat pump and second A/C unit
- Propane-sensing, legless patio awning with
- Sine wave inverter
- Panel with dual controller
- Internet system
- Side-view cameras
- Induction cooktop
- Refrigerator (29T)
- Optional refrigerator (32U, 35L)
- Microwave oven

STANDARD INTERIOR EQUIPMENT

- Ford® SYNC® 4 infotainment center with navigation
- Audible lane departure warning
- Pre-Collision Assist® with automatic emergency braking (AEB)
- SOS Post Crash Alert System™
- Driver and passenger airbags
- Safety Canopy® system with roll-fold side-curtain airbags
- Remote keyless entry and perimeter anti-theft alarm
- SecuriLock® anti-theft ignition
- Quad dual-beam halogen headlights
- Rainlamp wiper activated headlights
- Remote start
- Adjustable gas/brake pedals
- Individual tire pressure monitoring system (TPMS)
- Cruise control
- Power windows and door locks
- Auxiliary start switch
- 8-way power driver seat
- Tilt steering wheel
- Custom-molded ABS surround in cab-over area
- Overhead bunk with 750 lb. capacity
- Firefly total coach control system with wall-mounted touchscreen and mobile app
- 84 in. interior ceiling height with padded vinyl ceiling
- High-intensity, recessed LED ceiling lights
- Raised-panel hardwood cabinet doors and drawer fronts
- Deluxe hidden cabinet hinges
- Ball-bearing drawer guides
- 30,000 BTU auto-ignition furnace
- 10 gal. gas/electric water heater
- Furrion® electric fireplace (35L)
- Jayco-exclusive, easy-operation legless dinette table (32U, 35L)
- 2-point lap safety belts in all designated seating locations
- Car seat tethers (select floorplans)
- LED HD Smart TV in living area
- LED HD Smart TV in bedroom (32U, 35L)
- LED-lit, solid-surface kitchen countertops with recessed stainless steel sink and sink covers
- Pull-out countertop extension (select models)
- Decorative shower surround with glass door, skylight and light
- Macerating porcelain toilet
- Powered roof vent in bathroom with wall switch
- Rear U-shaped power sofa converts to 80 in. x 96 in. bed (29T)
- Walk-around, king-size bed with bedspread and nightstands (32U, 35L)
- Under-bed storage (select models)
- Large wardrobes
- Smoke alarm
- Carbon monoxide detector
- Fire extinguisher

Base price	328,050.00
WARM RIVER	n/c
HUNTINGTON CABINETRY	30.00
DESERT STORM PAINT PACKAGE	30.00
USA STANDARDS	n/c
CUSTOMER VALUE PACKAGE	31,050.00
15 CU. FT. 12V REFRIGERATOR	443.00
NO WASHER/DRYER	n/c
IN MOTION DISH SATELLITE SYSTEM	n/c
POWER THEATER SEATING SOFA	1,125.00

UNIT TOTAL

360,728.00

DEALER INSTALLED OPTIONS

Manufacturer's Suggested Retail Price

\$360,728.00

TOTAL AMOUNT DOES NOT INCLUDE STATE AND LOCAL TAXES OR LICENSE FEES - THE PRICE SHOWN ABOVE MAY OR MAY NOT BE REPRESENTATIVE OF THE ACTUAL SELLING PRICE OF SIMILAR RECREATIONAL VEHICLES IN YOUR AREA.

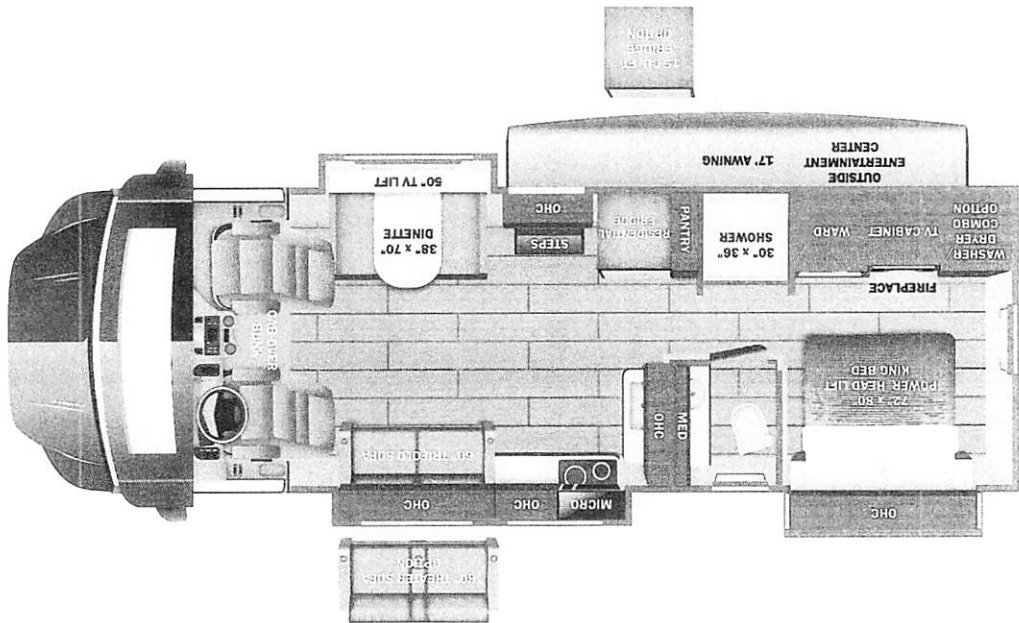

DIMENSIONS

Exterior height:144.00"
 Exterior width:101.00"

CAPACITIES

Fresh water tank (gals.):60.00
 Gray water tank (gals.):30.00
 Black water/toilet tank (gals.):30.00
 Propane (lbs.):83
 Propane (gals.):19
 Water heater (gals.):10.00

TIRES

Tire size (front):245/70R19.5G
 Tire size (mid):
 Tire size (rear):245/70R19.5G

Some dimensions may be rounded and may vary from the actual dimensions. Weights may be estimated calculations and may vary from the actual weights. Refer to the vehicle weight labels for actual weights. Weights may be rounded and specifications are subject to change without notice.

2+3
 YEAR WARRANTY
 LIMITED STRUCTURAL