

Manufacturer's Suggested Retail Price \$428,940.00

TOTAL AMOUNT DOES NOT INCLUDE STATE AND LOCAL TAXES OR LICENSE FEES. THE PRICE SHOWN ABOVE MAY OR MAY NOT BE REPRESENTATIVE OF THE ACTUAL SELLING PRICE OF SIMILAR RECREATIONAL VEHICLES IN YOUR AREA.



Seneca Prestige

Serial #: 1UJNCBU8T1LM4081
 Model: 37M SENECA PRESTIGE MHC
 VIN#: 4UZADVFC9TCWW6909
 Model Year: 2026 Dealer Name: LA MESA RV CENTER
 8650 NW LTC PARKWAY
 PORT ST. LUCIE, FL 34986
 USA



Standard Equipment

THE FOLLOWING ITEMS ARE STANDARD ON THIS MODEL

- STANDARD EXTERIOR EQUIPMENT**
- 6-way power driver and passenger seats
 - Pro-cy curtains for cab area
 - Color-coordinated carpeted floor mat
 - Custom-molded ABS surround in cab-over area
 - 170 lb. capacity and safety net with 300 lb. capacity
 - Collapsible bunk ladder
 - Finely Multiplex system offers control of important coach lights
 - LED lighting throughout
 - High-recessed recessed LED lighting
 - Raised-panel hardwood cabinetry and slides throughout
 - Deluxe hidden cabinet hinges
 - On-demand generator
 - On-demand propane furnace
 - Day/night roller shades in living area
 - J-yoke, exclusive, easy-operation, legless, dinette table
 - 2-point lap safety belts in all designated seating locations
 - 50 in. LED TV in living area (40 in. on 37K)
 - Sherrings sound bar
 - RC-6 coax and video selector switch
 - Wood-framed kitchen window with LED display
 - 2-burner induction cooktop with large integrated stainless steel countertop with large integrated nightstands
 - 12 in. Smart LED TV in bedroom
 - Bunks with industry-exclusive 300 lb. capacity each (37L) light
 - One-piece, fiberglass shower with glass door, skylight and showerhead
 - Solid-surface bathroom sink
 - Solid-surface bathroom vanity
 - Powered roof vent in bathroom with wall switch
 - Smoke alarm
 - Carbon monoxide detector
- STANDARD INTERIOR EQUIPMENT**
- 417,600.00
 - MOUNTAIN PEAK DECOR
 - STONEWALL GRAY CABINERY
 - EXCLUDE DOVE WHITE FRONT
 - OVERHEAD ACCENT WOOD
 - FINEWOOD BASO
 - RADIANT SILVER PAINT
 - USA STANDARDS
 - 26 FR S2RV 31000 279"
 - 360 TF501
 - CUSTOMER VALUE PACKAGE
 - NO WASHER/DRYER
 - NON-BLACKOUT
 - IN MOTION DISH SATELLITE SYSTEM
 - NO STARLINK
 - BOOTH DINETTE
 - POWER THEATER SEATING
 - SOFA

PN 224272

UNIT TOTAL 428,940.00

DEALER INSTALLED OPTIONS

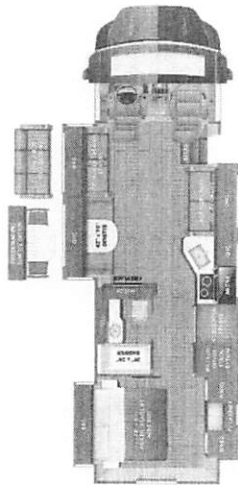

DIMENSIONS

Exterior height: 160.00"
 Exterior width: 101.00"

CAPACITIES

Fresh water tank (gals.): 72.00
 Gray water tank (gals.): 82.00
 Black water/toilet tank (gals.): 50.00
 Propane (lbs.): 0
 Propane (gals.): 0
 Water heater (gals.): 0.00

TIRES

Tire size (front): 275/80R22.5G
 Tire size (mid): 275/80R22.5G
 Tire size (rear): 275/80R22.5G

2+3 YEAR WARRANTY

Some dimensions may be rounded and may vary from the actual dimensions
 Weights may be estimated calculations and may vary from the actual weight - refer to the vehicle weight labels for actual weights
 Floorplans, features and specifications are subject to change without notice.