



## Odyssey SE



Serial #: 1JSLECB5V1G28070  
 Model: 22CF ODYSSEY SE MHC  
 VIN#: 1FDWE3FN2VDD02756  
 Model Year: 2027 Dealer Name: LA MESA RV CENTER  
 8650 NW LTC PARKWAY  
 PORT ST. LUCIE, FL 34986  
 USA

## Manufacturer's Suggested Retail Price

\$136,718.00

TOTAL AMOUNT DOES NOT INCLUDE STATE AND LOCAL TAXES OR LICENSE FEES. THE PRICE SHOWN ABOVE MAY OR MAY NOT BE REPRESENTATIVE OF THE ACTUAL SELLING PRICE OF SIMILAR RECREATIONAL VEHICLES IN YOUR AREA.

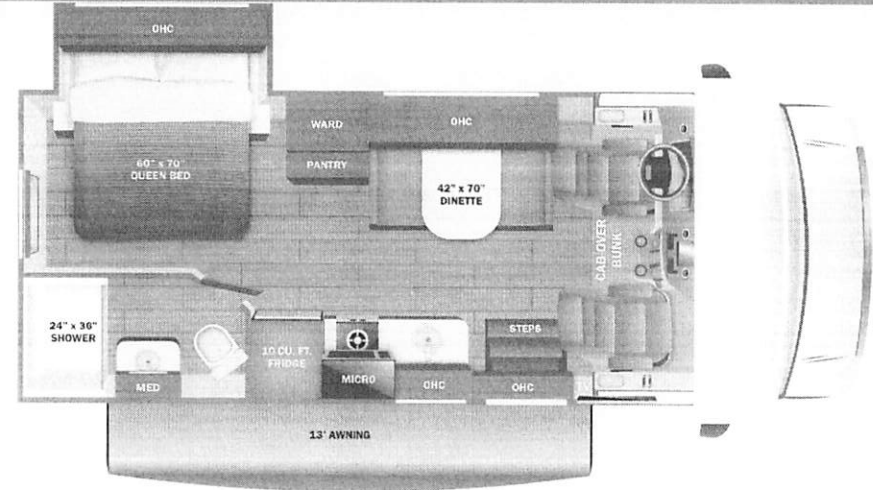

### Standard Equipment

### Optional Equipment

THE FOLLOWING ITEMS ARE STANDARD ON THIS MODEL

OPTIONAL EQUIPMENT INSTALLED ON THIS VEHICLE BY MANUFACTURER

- STANDARD EXTERIOR EQUIPMENT**
- Ford® E-350 chassis (20LF, 22AF, 22CF 22EF, 22TF)
  - GVWR - 12,500 lb. (20LF, 22AF, 22CF 22EF, 22TF)
  - GCWR - 18,500 lb. (20LF, 22AF, 22CF 22EF, 22TF)
  - Ford® E-450 chassis (31FF)
  - GVWR - 14,500 lb. (31FF)
  - GCWR - 22,000 lb. (31FF)
  - 7.3L V8 325 HP engine with 450 ft.-lb. torque
  - 6-speed TorqShift® series transmission with overdrive
  - 210-amp alternator
  - 5,000 lb. hitch with 500 lb. tongue capacity and 1-pin plug (20LF, 22AF, 22CF 22EF, 22TF)
  - 5,000 lb. hitch with 750 lb. tongue capacity and 1-pin plug (31FF)
  - Catalytic converter theft deterrent
  - E-rated highway tires- LT225/75R16
  - Tire pressure monitoring system (TPMS)
  - 12V chassis battery
  - Power anti-lock brakes with power steering
  - TuffShell™ vacuum-bond laminated roof, floor and sidewalls
  - Bead-foam insulation (R-24 max roof, R-9 max floor, R-5 max walls)
  - Tufflex™ PVC laminated roof
  - Aluminum running boards
  - Fiberglass exterior walls with vinyl graphics
  - Entrance door with industry's largest travel-view window
  - Electric-powered entrance step with integrated house battery compartment
  - Third brake light
  - Cable TV hookup with RG-6 coax
  - Digital antenna with signal booster
  - 4,000W generator
  - Solar prep
  - 12V house battery
  - Transfer switch with reverse polarity protection
  - 30-amp electrical service
  - 12.2 gal. propane tank (41 lb.)
  - LP quick-connect hookup
  - Exterior utility center
  - Winterization drain system
  - Outside shower
  - 12V demand water pump
  - Water filtration system

- STANDARD INTERIOR EQUIPMENT**
- Remote-controlled, side-view mirrors
  - Hill start assist
  - Tilt steering wheel
  - Cruise control
  - Electronic stability control
  - Traction control
  - SecurLock® anti-theft ignition
  - Power windows and door locks
  - Auxiliary start switch
  - Driver and passenger airbags
  - Overhead bunk with 750 lb. capacity
  - 84 in. ceiling height
  - High-intensity, recessed LED ceiling lights
  - Ball-bearing drawer guides
  - 42 in. x 76 in. U-shaped dinette (22AF, 22EF)
  - Entegra-exclusive, easy-operation legless dinette table (22CF, 31FF, 29KF)
  - 48 in. dinette bench with removable table (22TF)
  - 2-point lap safety belts in all designated seating locations
  - Interior entrance door grab handle
  - Interior command center
  - Pleated blackout shades
  - 13,500 BTU dusted A/C
  - 30,000 BTU auto-ignition furnace
  - 42K BTU Suburban On-Demand HW Heater
  - 10 cu. ft. 12V refrigerator
  - 2-burner cooktop with flush cover
  - Convection microwave oven
  - Stainless steel kitchen sink
  - 54 in. x 77 in. U-dinette converts to bed (20LF)
  - Queen-size bed with tootsieprax (22AF, 22CF, 31FF, 29KF)
  - (2) twin-size beds with filler cushion convert to king-size bed (22TF)
  - Large wardrobes (select models)
  - Bunks with industry-exclusive 300 lb. capacity each (31FF)
  - Shower with decorative ABS surround
  - Stainless steel bathroom sink
  - Toilet with foot flush
  - Smoke alarm
  - Carbon monoxide detector
  - Fire extinguisher

Base price	126,968.00
AVALON DECOR	n/c
USA STANDARDS	n/c
27 FORD E35 12500 158"	
7.3L VD309	n/c
CUSTOMER VALUE PACKAGE	9,750.00
NO HYDRAULIC AUTO LEVELING JACKS	n/c
STANDARD HOUSE BATTERY	n/c
NO SOLAR PANEL	n/c

PN 225 370

UNIT TOTAL 136,718.00

DEALER INSTALLED OPTIONS

#### DIMENSIONS

Exterior height:.....138.00"  
 Exterior width:.....100.00"

#### CAPACITIES

Fresh water tank (gals.):...43.50  
 Gray water tank (gals.):...40.00  
 Black water/toilet tank (gals.):...31.00  
 Propane (lbs.):...41  
 Propane (gals.):...9  
 Water heater (gals.):...6.00

#### TIRES

Tire size (front):.....LT225/75R16E  
 Tire size (mid):.....  
 Tire size (rear):.....LT225/75R16E

\*\*\*Some dimensions may be rounded and may vary from the actual dimensions\*\*\*  
 \*\*\*Weights may be estimated calculations and may vary from the actual weight - refer to the vehicle weight labels for actual weights\*\*\*  
 Floorplans, features and specifications are subject to change without notice.

