



TN208999

Vision SE



Serial #: 1JSMEABN0S1AA8082
 Model: 27ASE VISION SE MHA
 VIN#: 1F65F5DN0R0A03410
 Model Year: 2025 Dealer Name: LA MESA RV CENTER, INC.
 3255 EAST IRVINGTON ROAD
 TUCSON, AZ 85714
 USA

Manufacturer's Suggested Retail Price

\$175,186.00

TOTAL AMOUNT DOES NOT INCLUDE STATE AND LOCAL TAXES OR LICENSE FEES. THE PRICE SHOWN ABOVE MAY OR MAY NOT BE REPRESENTATIVE OF THE ACTUAL SELLING PRICE OF SIMILAR RECREATIONAL VEHICLES IN YOUR AREA.

Standard Equipment

THE FOLLOWING ITEMS ARE STANDARD ON THIS MODEL

STANDARD EXTERIOR EQUIPMENT

- Ford® F53 chassis
- GVWR - 18,000 lb.
- GCWR - 23,000 lb.
- 7.3L V-8 335 HP engine with 468 ft.-lb. torque
- 6-speed automatic TorqShift® transmission with overdrive and tow haul mode
- 210-amp alternator
- Catalytic converter theft deterrent
- G-rated highway tires-245/70R19.5
- Front and rear disc, 4-wheel anti-lock brakes
- 5,000 lb. rear hitch receiver with dual connector and 7-pin plug
- 12V chassis battery
- 80 gal. fuel tank
- TuffShell™ vacuum-bond laminated roof, floor and sidewalls
- Bead-foam insulation (R-24 max roof, R-9 max floor, R-8 max walls)
- One-piece, seamless fiberglass front cap
- Fiberglass exterior walls with vinyl graphics
- Leveling jack prep
- Entrance door with industry's largest travel-view window
- Electric-powered entrance steps
- Lockable pass-through storage compartments with metal slam latches
- Third brake light
- 4 in. tube bumper with sewer hose storage
- Prep for satellite dish
- Cable TV hookup with RG-6 coax
- KING Jack™ antenna
- 4,000W generator
- Solar prep
- 12V house battery
- Transfer switch with reverse polarity protection
- 30-amp electrical service
- Detachable power cord
- 16.5 gal. propane tank (56 lb.)
- LP quick-connect hookup
- Heated holding tanks (12V pads)
- Exterior utility center
- Winterization drain system
- Black tank flush
- Outside shower
- 12V demand water pump
- Water filtration system

STANDARD INTERIOR EQUIPMENT

- 120 in. panoramic windshield
- Swivel driver and passenger seats
- Tilt steering wheel
- Cruise control
- Hill start assist
- Electronic stability control
- Traction control
- Auxiliary start
- Power front privacy shade with manual side privacy shades
- 84 in. interior ceiling height
- High-intensity recessed LED ceiling lights
- Hardwood cabinet doors and drawer fronts
- Ball-bearing drawer guides
- 15,000 BTU A/C unit
- Auto-ignition ducted furnace - 30,000 BTU
- 6 gal. gas/electric DSI auto-ignition water heater
- Entegra-exclusive, easy-operation legless dinette table
- 2-point lap safety belts in all designated seating locations
- Smoke alarm
- Carbon monoxide detector
- Fire extinguisher
- 10 cu. ft. 12V refrigerator
- 2-burner cooktop with flush cover
- Convection microwave oven
- Large stainless steel kitchen sink
- Decorative kitchen backsplash
- Walk-around, king-size bed with bedspread and nightstands
- Dual USB ports in nightstands
- Under-bed storage
- Powered roof vent in bedroom with wall switch
- Large wardrobes
- Shower with decorative surround, glass door, skylight and light
- Stainless steel bathroom sink
- Toilet with foot flush
- Powered roof vent in bathroom with wall switch

CUSTOMER VALUE PACKAGE

- E-Z Drive™: Computer-balanced driveshaft, jounce bumpers, heavy-duty front and rear stabilizer bars, SACHS shocks
- One-piece, seamless, crowned fiberglass roof
- Electric patio awning with LED lights
- Sony® infotainment center with Apple CarPlay® and Android Auto™
- Backup and side-view cameras
- LED HD Smart TV in living area
- Pleated blackout shades

Optional Equipment

OPTIONAL EQUIPMENT INSTALLED ON THIS VEHICLE BY MANUFACTURER

Base price	155,693.00
ASHBROOK DECOR	n/c
USA STANDARDS	n/c
CUSTOMER VALUE PACKAGE	15,600.00
LEVELING JACKS	3,893.00
STANDARD HOUSE BATTERY	n/c
MANUAL FRONT OVERHEAD BUNK	n/c

UNIT TOTAL **175,186.00**

DEALER INSTALLED OPTIONS

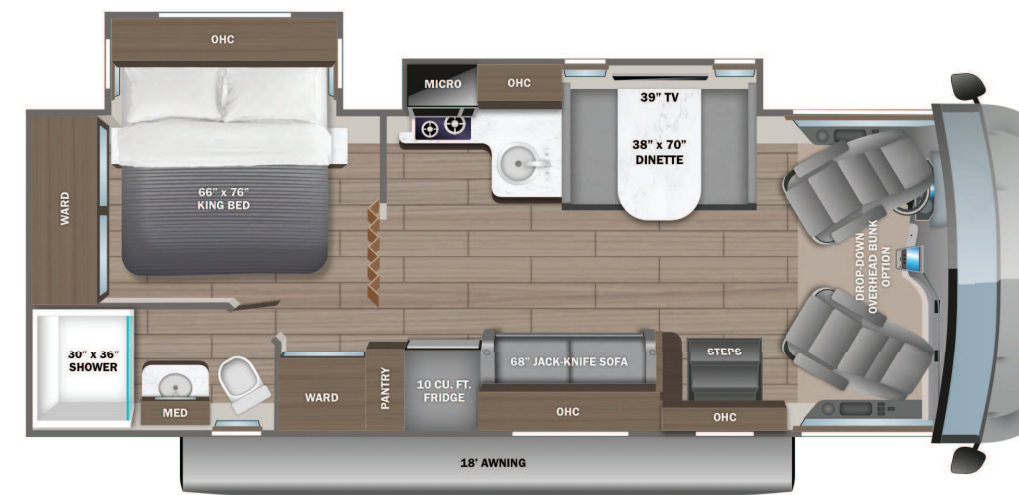

DIMENSIONS

Exterior height:.....149.00"
 Exterior width:.....101.00"

CAPACITIES

Fresh water tank (gals.):...72.00
 Gray water tank (gals.):...50.00
 Black water/toilet tank (gals.):.....49.00
 Propane (lbs.):.....56
 Propane (gals.):.....13
 Water heater (gals.):.....6.00

TIRES

Tire size (front):.....245/70R19.5G
 Tire size (mid):.....
 Tire size (rear):.....245/70R19.5G

Some dimensions may be rounded and may vary from the actual dimensions
 Weights may be estimated calculations and may vary from the actual weight - refer to the vehicle weight labels for actual weights
 Floorplans, features and specifications are subject to change without notice.