



TN211123

Odyssey SE



Serial #: 1JSLECB5S1G28260  
Model: 22CF ODYSSEY SE MHC  
VIN#: 1FDWE3FN3SDD38600  
Model Year: 2025 Dealer Name: LA MESA RV CENTER, INC.  
3255 EAST IRVINGTON ROAD  
TUCSON, AZ 85714  
USA

Standard Equipment

Optional Equipment

THE FOLLOWING ITEMS ARE STANDARD ON THIS MODEL

OPTIONAL EQUIPMENT INSTALLED ON THIS VEHICLE BY MANUFACTURER

- STANDARD EXTERIOR EQUIPMENT
- Ford® E-350 chassis (22AF, 22CF 22EF, 22TF)
  - GVWR - 12,500 lb. (22AF, 22CF 22EF, 22TF)
  - GCWR - 18,500 lb. (22AF, 22CF 22EF, 22TF)
  - Ford® E-450 chassis (31FF)
  - GVWR - 14,500 lb. (31FF)
  - GCWR - 22,000 lb. (31FF)
  - 7.3L V-8 325 HP engine with 450 ft.-lb. torque
  - 6-speed TorqShift® series transmission with overdrive
  - 210-amp alternator
  - 5,000 lb. hitch with 500 lb. tongue capacity and 7-pin plug (22AF, 22CF 22EF, 22TF)
  - 7,500 lb. hitch with 750 lb. tongue capacity and 7-pin plug (31FF)
  - Catalytic converter theft deterrent
  - E-rated highway tires- LT225/75R16
  - Tire pressure monitoring system (TPMS)
  - 12V chassis battery
  - Power anti-lock brakes with power steering
  - TuffShell™ vacuum-bond laminated roof, floor and sidewalls
  - Bead-foam insulation (R-24 max roof, R-9 max floor, R-5 max walls)
  - Tufflex™ PVC laminated roof
  - Aluminum running boards
  - Fiberglass exterior walls with vinyl graphics
  - Entrance door with industry's largest travel-view window
  - Electric-powered entrance step with integrated house battery compartment
  - Third brake light
  - 4 in. bumper tube sewer hose storage
  - Cable TV hookup with RG-6 coax
  - Digital antenna with signal booster
  - 4,000W generator
  - Solar prep
  - 12V house battery
  - Transfer switch with reverse polarity protection
  - 30-amp electrical service
  - 12.2 gal. propane tank (41 lb.)
  - LP quick-connect hookup
  - Exterior utility center
  - Winterization drain system
  - Outside shower
  - 12V demand water pump
  - Water filtration system
- CUSTOMER VALUE PACKAGE
- One-piece, seamless, fiberglass front cap
  - Heated holding tanks (12V pads)
  - Electric patio awning
  - Black holding tank sprayer
  - Backup camera
  - LED HD Smart TV

- STANDARD INTERIOR EQUIPMENT
- Remote-controlled, side-view mirrors
  - Hill start assist
  - Tilt steering wheel
  - Cruise control
  - Electronic stability control
  - Traction control
  - Power windows and door locks
  - Auxiliary start switch
  - Driver and passenger airbags
  - Overhead bunk with 750 lb. capacity
  - 84 in. ceiling height
  - High-intensity, recessed LED ceiling lights
  - Hardwood cabinet doors
  - Ball-bearing drawer guides
  - 42 in. x 78 in. U-shaped dinette (22A, 22E)
  - Entegra-exclusive, easy-operation legless dinette table (22CF, 31FF)
  - 48 in. dinette bench with removable table (22T)
  - 2-point lap safety belts in all designated seating locations
  - Interior entrance door grab handle
  - Interior command center
  - Pleated blackout shades
  - 13,500 BTU ducted A/C
  - 30,000 BTU auto-ignition furnace
  - 6 gal. gas/electric DSI auto-ignition water heater
  - Smoke alarm
  - Carbon monoxide detector
  - Fire extinguisher
  - 10 cu. ft. 12V refrigerator
  - 2-burner cooktop with flush cover
  - Convection microwave oven
  - Stainless steel kitchen sink
  - Decorative kitchen backsplash
  - Queen-size bed with bedspread (22AF, 22CF, 31FF)
  - (2) twin-size beds with filler cushion convert to king-size bed (22T)
  - Large wardrobes (select models)
  - Bunks with industry-exclusive 300 lb. capacity each (31FF)
  - Shower with decorative ABS surround and skylight
  - Stainless steel bathroom sink
  - Toilet with foot flush

- Base price
- 123,218.00
- ASHBROOK DECOR
- n/c
- USA STANDARDS
- n/c
- 25 FD E35 12500 158"
- 7.3L WHITE SC11
- n/c
- CUSTOMER VALUE PACKAGE
- 6,000.00
- NO HYDRAULIC AUTO
- LEVELING JACKS
- n/c
- NO SOLAR PANEL
- n/c
- STANDARD HOUSE BATTERY
- n/c

UNIT TOTAL 129,218.00

DEALER INSTALLED OPTIONS

Manufacturer's Suggested Retail Price

\$129,218.00

TOTAL AMOUNT DOES NOT INCLUDE STATE AND LOCAL TAXES OR LICENSE FEES. THE PRICE SHOWN ABOVE MAY OR MAY NOT BE REPRESENTATIVE OF THE ACTUAL SELLING PRICE OF SIMILAR RECREATIONAL VEHICLES IN YOUR AREA.

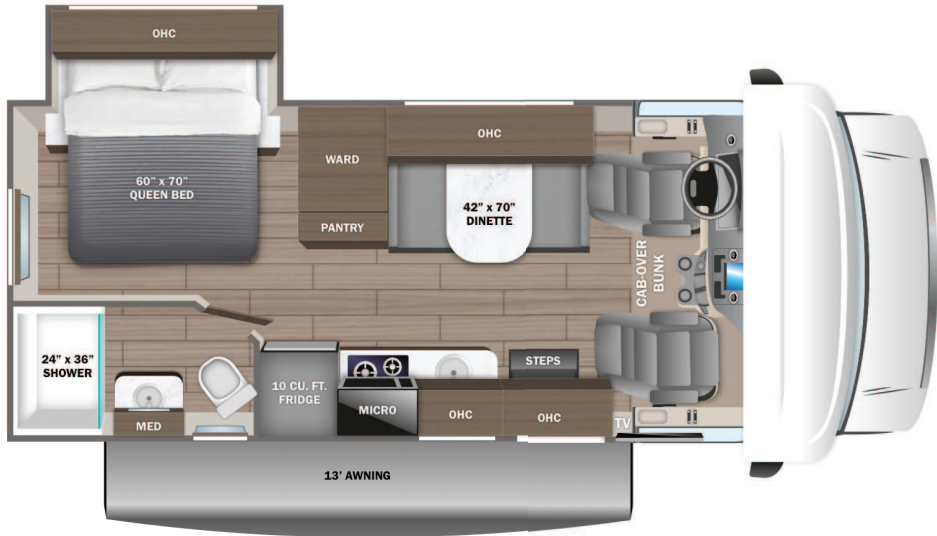

DIMENSIONS

Exterior height:.....138.00"  
Exterior width:.....100.00"

CAPACITIES

Fresh water tank (gals.):...43.50  
Gray water tank (gals.):...40.00  
Black water/toilet tank (gals.):.....31.00  
Propane (lbs.):.....41  
Propane (gals.):.....9  
Water heater (gals.):.....6.00

TIRES

Tire size (front):.....LT225/75R16E  
Tire size (mid):.....  
Tire size (rear):.....LT225/75R16E

\*\*\*Some dimensions may be rounded and may vary from the acutal dimensions\*\*\*  
\*\*\*Weights may be estimated calculations and may vary from the actual weight  
- refer to the vehicle weight labels for actual weights\*\*\*  
Floorplans, features and specifications are subject to change without notice.