



# Odyssey SE



Serial #: 1JSLECBL2T1GJ8142  
 Model: 22C ODYSSEY SE MHC  
 VIN#: 1HA6GUC71SN017669  
 Model Year: 2026 Dealer Name: LA MESA RV CENTER  
 7525 WEST MCDOWELL ROAD  
 PHOENIX, AZ 85035  
 USA

VN222129

## Manufacturer's Suggested Retail Price

\$132,218.00

TOTAL AMOUNT DOES NOT INCLUDE STATE AND LOCAL TAXES OR LICENSE FEES. THE PRICE SHOWN ABOVE MAY OR MAY NOT BE REPRESENTATIVE OF THE ACTUAL SELLING PRICE OF SIMILAR RECREATIONAL VEHICLES IN YOUR AREA.

### Standard Equipment

THE FOLLOWING ITEMS ARE STANDARD ON THIS MODEL

#### STANDARD EXTERIOR EQUIPMENT

- Chevy® 4500 chassis
- GVWR- 14,200 lb.
- GCWR- 20,000 lb.
- 6.6L Vortec V8 401 HP engine with 464 ft.-lb. torque
- Hydra-matic 6-speed automatic transmission with overdrive
- 150-amp alternator
- 5,000 lb. hitch with 500 lb. tongue capacity and 7-pin plug
- StabiliTrak stability control system
- E-rated highway tires- LT225/75R16
- 12V chassis battery
- Power anti-lock brakes with power steering
- Remote-controlled, side-view mirrors
- TuffShell™ vacuum-bond laminated roof, floor and sidewalls
- Bead-foam insulation (R-24 max roof, R-9 max floor, R-5 max walls)
- Tufflex™ PVC laminated roof
- Aluminum running boards
- Fiberglass exterior walls with vinyl graphics
- Entrance door with industry's largest travel-view window
- Electric-powered entrance step with integrated house battery compartment
- Third brake light
- Cable TV hookup with RG-6 coax
- Digital antenna with signal booster
- 4,000W generator
- Solar prep
- 12V house battery
- Transfer switch with reverse polarity protection
- 30-amp electrical service
- 12.2 gal. propane tank (41 lb.)
- LP quick-connect hookup
- Exterior utility center
- Winterization drain system
- Outside shower
- 12V demand water pump
- Water filtration system

#### STANDARD INTERIOR EQUIPMENT

- Remote-controlled, side-view mirrors
- Hill start assist
- Tilt steering wheel
- Cruise control
- Electronic stability control
- Traction control
- Power windows and door locks
- Auxiliary start switch
- Driver and passenger airbags
- Overhead bunk with 750 lb. capacity
- 84 in. ceiling height
- High-intensity, recessed LED ceiling lights
- Ball-bearing drawer guides
- 42 in. x 78 in. U-shaped dinette (22A, 22E)
- Entegra-exclusive, easy-operation legless dinette table (22C)
- 48 in. dinette bench with removable table (22T)
- 2-point lap safety belts in all designated seating locations
- Interior entrance door grab handle
- Interior command center
- Pleated blackout shades
- 13,500 BTU ducted A/C
- 30,000 BTU auto-ignition furnace
- 6 gal. gas/electric DSI auto-ignition water heater
- 10 cu. ft. 12V refrigerator
- 2-burner cooktop with flush cover
- Convection microwave oven
- Stainless steel kitchen sink
- Queen-size bed with bedspread (22A, 22C)
- (2) twin-size beds with filler cushion convert to king-size bed (22T)
- Large wardrobes (select models)
- Shower with decorative ABS surround
- Stainless steel bathroom sink
- Toilet with foot flush
- Smoke alarm
- Carbon monoxide detector
- Fire extinguisher

### Optional Equipment

OPTIONAL EQUIPMENT INSTALLED ON THIS VEHICLE BY MANUFACTURER

Base price	126,218.00
ASHBROOK DECOR	n/c
USA STANDARDS	n/c
CUSTOMER VALUE PACKAGE	6,000.00
NO HYDRAULIC AUTO LEVELING JACKS	n/c
NO SOLAR PANEL	n/c
STANDARD HOUSE BATTERY	n/c

UNIT TOTAL **132,218.00**

DEALER INSTALLED OPTIONS

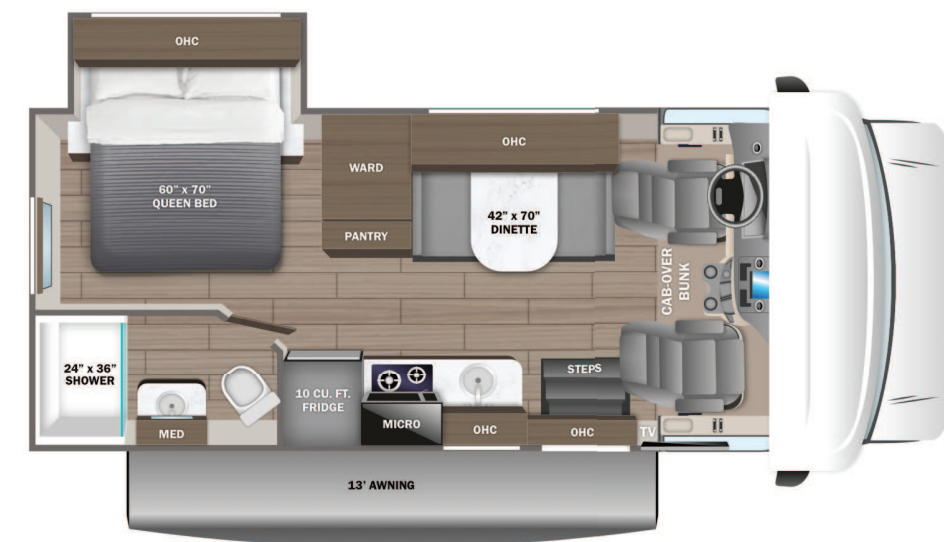

#### DIMENSIONS

Exterior height:.....138.00"  
 Exterior width:.....100.00"

#### CAPACITIES

Fresh water tank (gals.):...43.50  
 Gray water tank (gals.):...40.00  
 Black water/toilet tank (gals.):.....31.00  
 Propane (lbs.):.....41  
 Propane (gals.):.....9  
 Water heater (gals.):.....6.00

#### TIRES

Tire size (front):.....LT225/75R16ES  
 Tire size (mid):.....  
 Tire size (rear):.....LT225/75R16ES

\*\*\*Some dimensions may be rounded and may vary from the actual dimensions\*\*\*  
 \*\*\*Weights may be estimated calculations and may vary from the actual weight - refer to the vehicle weight labels for actual weights\*\*\*  
 Floorplans, features and specifications are subject to change without notice.



Document Identifier: MSPP SHEET