

0200

Sundance



Serial #: 1UJC70BR9T1B59086
 Model: 29RLCS SUNDANCE FW

Model Year: 2026 Dealer Name: LA MESA RV CENTER
 7525 WEST MCDOWELL ROAD
 PHOENIX, AZ 85035
 USA

VN224238

Manufacturer's Suggested Retail Price \$84,167.00

TOTAL AMOUNT DOES NOT INCLUDE STATE AND LOCAL TAXES OR LICENSE FEES. THE PRICE SHOWN ABOVE MAY OR MAY NOT BE REPRESENTATIVE OF THE ACTUAL SELLING PRICE OF SIMILAR RECREATIONAL VEHICLES IN YOUR AREA.

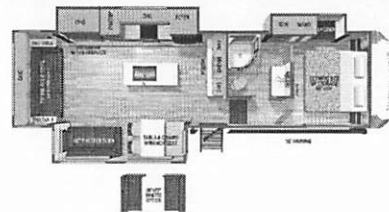

Standard Equipment

Optional Equipment

THE FOLLOWING ITEMS ARE STANDARD ON THIS MODEL

OPTIONAL EQUIPMENT INSTALLED ON THIS VEHICLE BY MANUFACTURER

STANDARD EXTERIOR EQUIPMENT
 1.5 in. fresh water drain valve
 5 in. TrussTXL roof system (rated for 4500 lbs) w/ plywood roof decking
 Alpha Fly TPO roof membrane (thickest roof membrane w/ limited lifetime warranty)
 50-amp detachable power cord
 LED lighting in pass through area
 Auto-grade vinyl graphics
 Automotive style front cap with max turn radius (painted on select models)
 Black tank flush
 Additional dump valve at termination
 LED light & switch at termination
 ThermoShield: zero-degree tested weather protection:
 * Fully enclosed and heated underbelly (ducted)
 * 35,000 BTU furnace
 * Double layer fiberglass batt insulation in ceiling and floor
 * Double sided radiant barrier insulation (roof, floor and behind cap)
 * PEX plumbing
 Commercial grade rubber flooring in pass through area
 Dual 30 lb. LP bottles
 Factory installed roof ladder
 Galvanized steel coated outside kitchens
 AeroChill directional cooling system
 * Exclusive insulated dual duct design
 * Directional and closable A/C vents
 * Larger return air vents with user accessible filters
 Independent satellite and cable hookups (outside kitchens and/or pass through storage areas)
 LED exterior lighting package
 LP quick connect for gas griddle
 Metal slam latch baggage doors
 Nautilus 2.5" water connections
 16" Nitrogen filled undermount spare tire
 Quick connect water connections (door side hot/cold and off door side cold only)
 Slide topper/awning prep
 CoreShield Walls - 2 in. vacuum bonded laminated sidewalls and floors with 2lb density foam (including slide end walls and rear wall)
 Rear camera prep
 Electric auto leveling

STANDARD INTERIOR EQUIPMENT
 2-piece high gloss bathroom surround
 Teak seat shower prep
 5/8 in. tongue-and-groove plywood flooring
 75 lb. full extension drawer guides
 30" X 22" shower skylight
 Bedroom TV,SAT,cable prep
 C.P.A.P. prepped bedroom (both sides)
 Extra 120V power outlets in kitchen and slide rooms (where applicable)
 Gas strutted under bed storage
 High Sheen handcrafted door/drawer fronts
 Medicine cabinet with custom framed mirror
 kitchen faucet with pull-out sprayer
 Porcelain foot flush toilet
 Residential vinyl flooring throughout (NO CARPET)
 Theater seating (select models)
 Tri-fold hide-a-bed sofa with residential memory foam sleep surface (select models)
 USB-C 12v charging ports (multiple locations throughout)
 Water shutoff at all faucet locations
 100% no floor heat vents
 4" interior ceiling can lighting (4000K lumen)
 Free standing table with leaf 2 chairs and bench seat
 Theater seating in place of tri-fold sofa (select models)

Base price	67,650.00
USA STANDARDS	n/c
CAMPING IN COMFORT PACKAGE	5,993.00
PREMIUM PACKAGE	6,188.00
ENDURANCE HANDLING PACKAGE	3,293.00
POWERUP SOLAR 1 PACKAGE	n/c
2ND 15,000 AC IN BEDROOM	1,043.00
TINTED SAFETY GLASS	n/c
WINDOWS	n/c
STANDARD BRAKE	n/c
15" TIRE	n/c
FREE STANDING TABLE,CHAIRS(2),BENCH SEAT	n/c

CAMPING IN COMFORT PACKAGE
 15K BTU "Whisper Quiet" A/C and bedroom A/C prep
 4K ultra LED HD Smart TV in living room (varies from 40" to 65")
 50-amp service with dual A/C ducts
 60K on-demand tankless water heater
 Custom machined aluminum rims
 Electric patio awning
 Hidden hinges on cabinet doors
 Interior "Blue Sync" audio connect w/ MB quart sound (TV & phone)
 Keyed-Alike™ lock system
 MORryde Sleep Above™ entrance steps (main entrance)
 Rain proof bathroom power vent
 Rear 2 in. towing receiver (4-pin connector on fifth wheels only)
 Wingard Air 360+ antenna & router prep
 PowerUp Solar 1 Package: (1) 200W solar panel and 30-amp digital controller
 Inverter pre-wire (multiple locations throughout)

PREMIUM PACKAGE
 Blackout roller shades with reflective side throughout
 Electric auto-leveling
 Black glass front 16 cubic foot 12V refrigerator
 Residential style glass shower door
 Washer/dryer prep (select models)
 30 in. over-the-range black and stainless microwave with exhaust fan
 Black 21 in. range with edge to edge grates
 Multi-Function "ALL in ONE" black stainless steel kitchen sink
 Residential 66 in. x 80 in. OLYMPIC size mattress
 Magnetic catches for all drawers & doors
 Solid surface kitchen countertop(s)
 LED fireplace with 5,000 BTU electric space heater
 Monitor switch panel
 Exterior light & outlet (rear of camping doorside)

UNIT TOTAL **84,167.00**

DEALER INSTALLED OPTIONS

DIMENSIONS

Exterior height:.....155.75"
 Exterior width:.....97.00"

CAPACITIES

Fresh water tank (gals.)....52.00
 Gray water tank (gals.)....82.00
 Black water/toilet tank (gals.).....45.00
 Propane (lbs.).....60
 Propane (gals.).....14
 Water heater (gals.).....0.25

TIRES

Tire size (front):.....
 Tire size (mid):.....
 Tire size (rear):.....

Some dimensions may be rounded and may vary from the actual dimensions
 Weights may be estimated calculations and may vary from the actual weight - refer to the vehicle weight labels for actual weights
 Floorplans, features and specifications are subject to change without notice.