



# Centurion



Serial #: 1JSNECBV5T19K8051  
 Model: 39K CENTURION MHC  
 VIN#: 1FVAHTDVXTLWT0815  
 Model Year: 2026 Dealer Name: LA MESA RV CENTER

7525 WEST MCDOWELL ROAD  
 PHOENIX, AZ 85035  
 USA

VN224477

## Standard Equipment

## Optional Equipment

THE FOLLOWING ITEMS ARE STANDARD ON THIS MODEL

OPTIONAL EQUIPMENT INSTALLED ON THIS VEHICLE BY MANUFACTURER

**STANDARD EXTERIOR EQUIPMENT**  
 Fleetline® Cascadia 116 Day Cab  
 Detroit® DD13 GEN 5 12.8L 525 HP engine with 1,850 torque at 975 RPM  
 12-speed overdrive automated manual transmission  
 12V 300 amp alternator  
 1,500W engine block heater  
 Engine brake with global cruise control  
 Detroit® safety assurance package with active break assist 5, adaptive cruise control, active side guard assist and lane departure warning system  
 18,000 lb. rating front axle  
 23,000 lb. rating rear axle  
 All-wheel air disc brakes  
 2.85 rear axle ratio  
 Michelin® 315/80R 22.5 in. tires (front) and 295/80R 22.5 in. tires (rear)  
 Tire pressure monitoring system (TPMS) with sensors  
 Equalizer™ EQ Hydraulic Smart Level System  
 (3) 12V chassis batteries  
 120 gal. DEF tank  
 13 gal. DEF tank  
 20,000 lb. hitch with 7-pin plug  
 8,000W diesel generator with auto-gen start  
 Victron 3,000W pure sine wave inverter with LED screen  
 (4) GC2 batteries (6V/224 amp hrs. ea.)  
 400W solar panels  
 50 amp power cord on electric powered reel  
 Automatic transfer switch with surge protection  
 (2) 15,000 BTU units with heat pumps  
 Aqua-Hot® 250D hydronic water and heating system with 5 in. LED screen and in-floor heating throughout  
 Aqua-Hot® heated basement storage  
 Sani-Com® macerator holding tank dump system with manual gate valves and manual backup  
 Black tank flush  
 City and tank water filtration system  
 Hot and cold water hook-up  
 Water hose with electric reel  
 Sikkens custom full-body paint  
 Carefree® slideout awnings  
 Frameless, dual-pane, tinted, safety-glass windows  
 LED accent lights under all slideout rooms  
 Electric-powered entrance step  
 Keypad system for keyless entry  
 Diamond Shield™ front protective film mask  
 LED high and low beam headlights  
 LED marker lights, turn lights, license plate light, third brake light, accent lights and docking lights  
 Porch light and motion sensor security lights  
 Winegard Connect 2.0 W-FV4G antenna  
 Heated exterior utility center with tank monitoring system  
 Carpeted, full pass-through storage compartments with lockable slam latch door  
 Roof-mounted dual pitch integrated power patio awning with LED lights

**STANDARD INTERIOR EQUIPMENT**  
 360° HD digital camera system  
 Powered Front Cap Privacy Shade  
 Adjustable air-ride leather driver/passenger seats  
 Firefly multiplex system with 10 in. Vega Touch touchscreen for complete integration of coach controls (mobile app available)  
 50 in. Smart TV in living room  
 Soundbar in living room  
 Premium leather furniture  
 Hand-laid, porcelain tiled floors  
 LED Interior Lighting  
 Decorative ceiling feature with integrated accent lighting  
 Manual solar day shades and blackout night shades  
 Central vacuum system with in-wall dust pan  
 Dual-pane, tinted, safety-glass windows  
 LED-lit fireplace with 5,000 BTU heating element (39K only)  
 Powered Flush Stepwell Covey  
 Stainless steel residential refrigerator  
 Induction cooktop with solid surface covers  
 Convection microwave with air fryer function  
 Solid-surface countertops and dimmable LED accent lighting  
 Hardwood cabinetry and stiles throughout  
 Adjustable shelves  
 Stainless steel sink  
 Gel memory-foam mattress  
 Solid-surface countertops and dimmable LED accent lighting  
 Nightstands with solid-surface tops  
 Smart TV in bedroom  
 Solid-surface countertops with single sink and dimmable LED accent lighting  
 Fiberglass pan, solid surface with tile inset  
 Teakwood shower seat  
 Hand-held spray wand  
 Aqua View SHOWERMISER™ water saving system  
 Chins toilet in main bath  
 Macerator toilet in mid bath  
 Power exhaust vent fan in bathroom  
 Stacked washer and dryer  
 Carbon monoxide detector  
 Smoke alarm

Base price	671,843.00
OXFORD DECOR	n/c
STONEWALL GRAY CABINERY	30.00
EXCLUDE DOVE WHITE FRONT OVERHEAD ACCENT WOOD	n/c
ALPI CHIARO TILE	1,493.00
SILVER FOX PAINT	30.00
USA STANDARDS	n/c
26 FR CASC 41000 310"	
525HP TF124	n/c
DISHWASHER	1,193.00
FREEZER	1,343.00
SATELLITE PREP ONLY	n/c
STARLINK SATELLITE INTERNET SERVICE	743.00
THEATER SEATING 82" WITH END TABLES	143.00

UNIT TOTAL **676,818.00**

DEALER INSTALLED OPTIONS

## Manufacturer's Suggested Retail Price

\$676,818.00

TOTAL AMOUNT DOES NOT INCLUDE STATE AND LOCAL TAXES OR LICENSE FEES. THE PRICE SHOWN ABOVE MAY OR MAY NOT BE REPRESENTATIVE OF THE ACTUAL SELLING PRICE OF SIMILAR RECREATIONAL VEHICLES IN YOUR AREA.

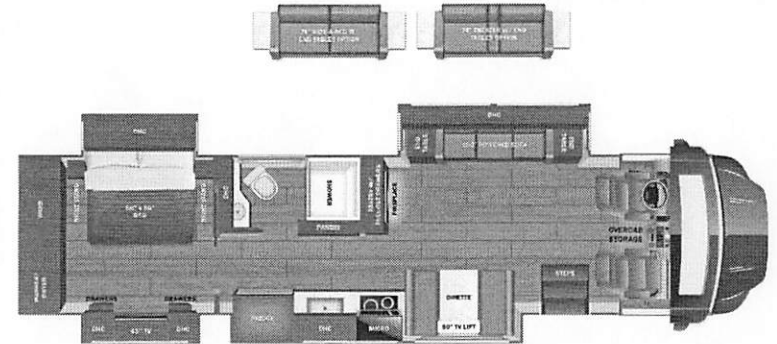

### DIMENSIONS

Exterior height:.....157.00"  
 Exterior width:.....101.00"

### CAPACITIES

Fresh water tank (gals.).....100.00  
 Gray water tank (gals.).....82.00  
 Black water/toilet tank (gals.).....50.00  
 Propane (lbs.).....0  
 Propane (gals.).....0  
 Water heater (gals.).....0.00

### TIRES

Tire size (front):.....315/80R22.5  
 Tire size (mid):.....  
 Tire size (rear):.....295/80R22.5

\*\*\*Some dimensions may be rounded and may vary from the actual dimensions\*\*\*

\*\*\*Weights may be estimated calculations and may vary from the actual weight

- refer to the vehicle weight labels for actual weights\*\*\*

Floorplans, features and specifications are subject to change without notice.

