



Qwest



Serial #: 1JSLECL6R1ZL8098  
Model: 24L QWEST MHC  
VIN#: W1X8N33Y5PN234803  
Model Year: 2024 Dealer Name:

### Standard Equipment

THE FOLLOWING ITEMS ARE STANDARD ON THIS MODEL  
AT NO EXTRA CHARGE

**STANDARD EXTERIOR EQUIPMENT**

- Premium Mercedes-Benz® 3500 chassis with 170 in. wheelbase
- GVWR - 11,030 lb.
- GCWR - 15,250 lb.
- 2L V4 Twin Turbo 211HP diesel engine with electronic fuel injection with 332 ft.-lb. torque
- 9-speed automatic transmission
- 220-amp alternator
- E-rated highway tires- 215/85R16
- Aluminum rims
- Front and rear disc, 4-wheel anti-lock brakes
- 5,000 lb. rear hitch receiver with dual connector and 7-pin plug
- 12V chassis battery
- 24.5 gal. fuel tank
- 5.6 gal. DEF tank
- TuffShell™ vacuum-bond laminated roof, floor and sidewalls
- Bead-foam insulation (R-24 max roof, R-9 max floor, R-5 max walls)
- One-piece, seamless, fiberglass roof
- Partial fiberglass rear cap
- Premium Sikens full-body paint
- Chrome grille
- Slideout cover awnings
- Entrance door with industry's largest travel-view window
- Electric-powered entrance step with integrated house battery compartment
- Aluminum skirt-hung baggage doors
- Third brake light
- Prep for satellite dish
- Cable TV hookup with RG-6 coax
- Winegard 2.0 Wi-Fi4G antenna
- 3,600W LP generator with auto-gen start (4,000W on select models)
- 200W solar panel with dual controller
- 1,000W inverter
- (2) 12V house batteries
- Transfer switch with reverse polarity protection
- 30-amp electrical service
- 12.2 gal. propane tank (41 lb.)
- LP quick-connect hookup
- Exterior utility center
- Winterization drain system
- Black tank flush
- Outside shower
- 12V demand water pump
- Water filtration system

**CUSTOMER VALUE PACKAGE**

- One-piece, seamless fiberglass front cap
- Automotive-bonded panoramic window in front cap with power shade
- 10.25 in. integrated Mercedes-Benz® MBUX infotainment center with GPS, Apple® CarPlay™ and Android Auto™
- Frameless windows
- Electric stabilizer jacks
- Girard® armless patio awning with LED light strip
- Heated holding tanks (12V pads)
- Truma AquaGo Comfort Plus tankless water heater
- Backup and side-view cameras
- Power, swivel, heated leatherette driver and passenger seats
- Keyless cab entry

**STANDARD INTERIOR EQUIPMENT**

- Heated, remote-controlled, side-view mirrors
- Leather tilt steering wheel
- Smartphone tray with wireless charging
- Active Distance Assist DISTRONIC®
- Active lane keeping assist
- Crosswind assist
- Hill start assist
- Brake assist plus
- Traffic sign assist
- Attention assist
- Breakdown management
- Emergency call system
- Rain-sensing windshield wipers
- LED high performance headlights
- Headlight assistant
- Driver and passenger airbags
- Power windows and door locks
- Auxiliary start switch
- Custom-molded ABS surround in cab-over area
- Overhead bunk with 750 lb. capacity
- Privacy curtain for cab area
- Firefly Multiplex system - wall-mounted touchscreen and mobile app for total coach control
- 80 in. interior ceiling height with padded vinyl ceiling
- High-intensity LED ceiling lights
- High-gloss hardwood fascia
- Tecnoform® high-gloss cabinetry and countertops
- Ball-bearing drawer guides
- Daynight roller shades
- 15,000 BTU A/C
- 30,000 BTU auto-ignition ducted furnace
- Powered roof vent in living area with wall switch
- Entegra-exclusive, easy-operation legless dinette table (24R)
- U-shaped dinette with stow-away pedestal legs (24L)
- 12V USB charging station in dinette area
- 2-point lap safety belts in all designated seating locations
- Car seat tethers (select floorplans)
- LED HD TV in living area
- Smoke alarm
- Carbon monoxide detector
- Fire extinguisher
- 6 cu. ft. 3-way refrigerator
- 2-burner, drop-in cooktop with flush cover
- Stainless convection microwave
- Stainless steel sink with wooden cover/cutting board
- Decorative kitchen backsplash
- Queen-size bed with bedspread (24L)
- Queen-size power Murphy bed (24R)
- Queen-size manual Murphy bed (24N)
- (2) twin-size beds with filler cushion converts to king-size bed (24T)
- USB port(s) in bedroom
- Under-bed storage (select models)
- LED HD TV in bedroom (24N)
- Bedroom TV prep (24L, 24T)
- Large wardrobes
- Shower with decorative surround and skylight
- Stainless steel bathroom sink
- Porcelain toilet with foot flush
- Powered roof vent in bathroom with wall switch

### Optional Equipment

OPTIONAL EQUIPMENT INSTALLED ON THIS VEHICLE  
BY MANUFACTURER

Base price	212,993.00
DENMARK	n/c
OZARK FULL BODY PAINT	30.00
USA STANDARDS	n/c
CUSTOMER VALUE PACKAGE	7,050.00
HYDRAULIC AUTO LEVELING JACKS	4,493.00
STANDARD HOUSE BATTERY	n/c
FRONT CAP CAB-OVER	n/c
DINETTE	n/c

UNIT TOTAL 224,566.00

DEALER INSTALLED OPTIONS

Manufacturer's Suggested Retail Price \$224,566.00

TOTAL AMOUNT DOES NOT INCLUDE STATE AND LOCAL TAXES OR LICENSE FEES. THE PRICE SHOWN ABOVE MAY OR MAY NOT BE REPRESENTATIVE OF THE ACTUAL SELLING PRICE OF SIMILAR RECREATIONAL VEHICLES IN YOUR AREA.

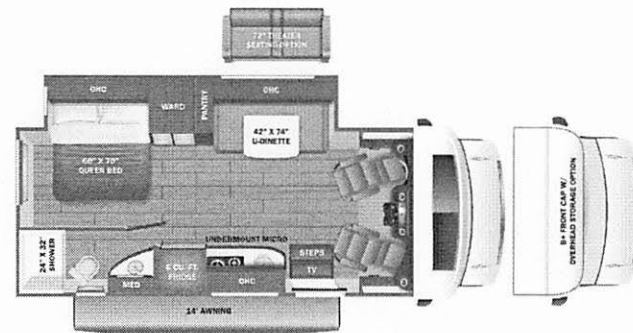

### DIMENSIONS

Exterior height:.....131.00"  
Exterior width:.....96.00"

### CAPACITIES

Fresh water tank (gals.):...43.00  
Gray water tank (gals.):...31.00  
Black water/toilet tank (gals.):...31.00  
Propane (lbs.):.....41  
Propane (gals.):.....9  
Water heater (gals.):.....6.00

### TIRES

Tire size (front):.....LT215/85R16  
Tire size (mid):.....  
Tire size (rear):.....LT215/85R16

\*\*\*Some dimensions may be rounded and may vary from the actual dimensions\*\*\*

\*\*\*Weights may be estimated calculations and may vary from the actual weight

- refer to the vehicle weight labels for actual weights\*\*\*

Floorplans, features and specifications are subject to change without notice.

This is provided as an information resource only.  
Previous owner(s) may have removed, altered or  
changed equipment after the unit was originally delivered.