



Ethos



Serial #: 1JSPEBBJ0S1RT8257
Model: 20T ETHOS MHB
VIN#: 3C6MRVUG0SE531745
Model Year: 2025 Dealer Name: REC VAN

5070 BRANDIN CT
FREMONT, CA 94538
USA

Manufacturer's Suggested Retail Price

\$182,550.00

TOTAL AMOUNT DOES NOT INCLUDE STATE AND LOCAL TAXES OR LICENSE FEES. THE PRICE SHOWN ABOVE MAY OR MAY NOT BE REPRESENTATIVE OF THE ACTUAL SELLING PRICE OF SIMILAR RECREATIONAL VEHICLES IN YOUR AREA.

Standard Equipment

THE FOLLOWING ITEMS ARE STANDARD ON THIS MODEL

STANDARD EXTERIOR EQUIPMENT

- RAM® ProMaster 3500 window van
- GVWR- 9,350 lb.
- GCWR- 12,000 lb.
- 3.6L V6 24V VVT 276HP engine with 250 ft.-lb. torque
- 9-speed automatic 948TE transmission
- LT225/75R 16E tires
- Aluminum wheels
- 3,500 lb. rear hitch receiver with dual 4/7 pin connector
- 12V chassis battery
- 24 gal. fuel tank (gas)
- LED-ill running boards for cab and entry doors
- Chrome grille package
- Cable TV hookup with RG-6 coax
- Onan® 2,800W generator with auto-gen start
- Portable solar plug
- (2) 12V AGM house batteries
- House battery disconnect switch
- 30-amp electrical service with detachable power cord
- (2) 120V exterior outlets
- 6 gal. propane tank (20 lb.)
- LP quick-connect hookup
- Heated holding tanks (12V pads)
- LED-ill holding tank valves
- Black tank flush
- Gravity water fill (20T)
- Winterization drain system
- 12V demand water pump
- Water filtration system
- Outside shower

CUSTOMER VALUE PACKAGE

- E-Z Drive™. Heliwig helper springs, premium heavy-duty suspension
- Thule® patio awning with LED light strip
- Truma Combi Eco Plus water heater and furnace
- Swivel driver and passenger seats with 6-way adjustment
- 1,000W inverter
- Aqua View® SHOWERMISER™ water management system

STANDARD INTERIOR EQUIPMENT

- Uconnect® 5 NAV infotainment center with Apple CarPlay® and Android Auto™
- Power folding/heated side-view mirrors
- Push-button start
- ParkView® rear backup camera with dynamic gridlines
- Blind spot monitoring with rear cross path detection
- LaneSense® lane departure warning with lane keep assist
- Forward collision warning with active braking
- Crosswind assist
- Electronic stability control
- Pedestrian/cyclist emergency braking
- Traffic sign information
- Drowsy driver detection
- Rain-sensitive windshield wipers
- Automatic high-beam headlights
- Cruise control
- Driver and passenger airbags
- Wireless charging pad
- Power windows and door locks
- Privacy shades for cab windows
- Remote keyless entry
- Custom-molded ABS interior wall panels
- Soft-touch vinyl ceiling
- High-intensity LED ceiling lights
- Tecnoform® European-style, high-gloss cabinetry
- Ball-bearing drawer guides
- Residential vinyl flooring
- Firefly Multiplex system - wall-mounted touchscreen for total coach control
- 120V Coleman® Mach® 10 13,500 BTU air conditioner
- Powered roof vent in living area
- Zip-up screen for entrance door
- Removable privacy shade for sliding door window
- Sliding vented windows
- Decorative window valances with daylight roller shades
- Zip-up screen for rear doors (20A)
- Rear magnetic privacy shades
- Adjustable table with multiple mounts
- (2) cab bucket seats (20A)
- Seatbelts for driver/passenger seats and select cab locations
- Smoke alarm
- Carbon monoxide detector
- Fire extinguisher
- 5.3 cu.ft. DC refrigerator (20A)
- 3.1 cu.ft. DC refrigerator (20T)
- 3 cu.ft. DC refrigerator (20E, 20Y)
- Convection microwave
- 2-burner gas cooktop (1-burner induction with pop-top option)
- Stainless-steel sink
- Pressed countertops
- Pop-up 120V/USB outlet in kitchen
- (2) twin-size beds with filler cushion converts to king-size bed (20T)
- Under-bed storage (20T)
- 48 in. x 76 in. convertible sofa bed (20A)
- 59 in. x 73 in. Murphy bed (20E)
- Under floor storage with pull-out trays (20E)
- 59 in. x 73 in. loft bed with floor storage (20Y)
- Bathroom wardrobe with drawers (20T)
- Shower with magnetic curtain surround
- Toilet with foot flush
- Medicine cabinet with mirror
- Powered roof vent in bathroom (N/A with pop-top option)

Optional Equipment

OPTIONAL EQUIPMENT INSTALLED ON THIS VEHICLE BY MANUFACTURER

Base price	171,300.00
USA STANDARDS	n/c
25 RAM GRAN 3500 9350	
159" 3.6L SLT+ SR411	n/c
CUSTOMER VALUE PACKAGE	11,250.00
NO WINEGARD 2.0 CONNECT & TV	n/c
NO THULE ROOF RACK & LADDER	n/c

UNIT TOTAL 182,550.00

DEALER INSTALLED OPTIONS

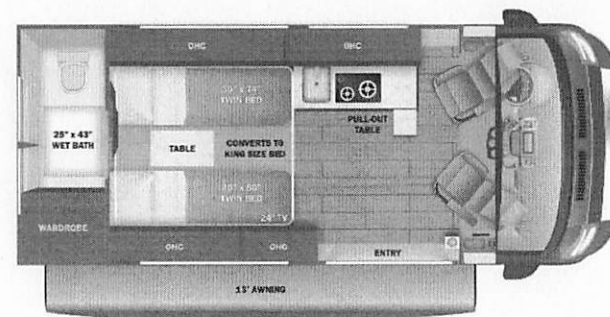

DIMENSIONS

Exterior height:.....111.00"
Exterior width:.....83.00"

CAPACITIES

Fresh water tank (gals.):...24.00
Gray water tank (gals.):...13.00
Black water/toilet tank (gals.):...12.00
Propane (lbs.):.....20
Propane (gals.):.....4
Water heater (gals.):.....0.00

TIRES

Tire size (front):.....LT225/75R16E
Tire size (mid):.....
Tire size (rear):.....LT225/75R16E

Some dimensions may be rounded and may vary from the actual dimensions

***Weights may be estimated calculations and may vary from the actual weight

- refer to the vehicle weight labels for actual weights***

Floorplans, features and specifications are subject to change without notice.